

Proposed Waiting & Loading Restrictions Weir Road Area



Councillor Andrew Judge

Cabinet Member for
Environmental Sustainability
and Regeneration

T: 020 8545 3425

E: andrew.judge@merton.gov.uk



ISSUE DATE : 13 AUGUST 2015

Dear Occupier,

The purpose of this leaflet is to advise you that the Council is carrying out a statutory consultation on its intention to introduce waiting and loading restrictions (double yellow lines) in Weir Road, Endeavour Way, and Archway Close and at the junction of Durnsford Road and Endeavour Way. It is also our intention to introduce some free parking bays at locations considered safe, and two disabled parking bays outside No.9 Weir Road. The Council carries out careful consultation to ensure that all road users are given a fair opportunity to give their views and express their needs on parking proposals. The parking needs of businesses and visitors are given consideration but it is considered that maintaining safe access must take priority.

The proposed waiting restrictions will improve safety, visibility and provide clear access for all road users, particularly vulnerable road users such as pedestrians, push chairs and wheelchair users. The proposed restrictions will also ensure that congestion is minimised and HGV access to business premises are improved.

PROPOSED MEASURES

It is proposed to implement double yellow lines waiting and loading restrictions which will operate at all times, free parking bays and disabled parking bays in the following roads:

- Weir Road
- Endeavour Way
- Archway Close junction Endeavour Way
- Durnsford Road junction Endeavour Way

As part of improvement works, the Council will also be introducing new dropped kerbs throughout the above named roads to improve accessibility for pedestrians. These will be constructed irrespective of the proposed restrictions and are not subjected to a consultation. The proposed measures are shown on the plan overleaf.

WHAT HAPPENS NEXT

A Notice of the Council's intentions to make the relevant Traffic Management Orders (TMOs) for the required changes will be published in the local newspaper (The Guardian), London Gazette and posted on lamp columns in the vicinity. Representations for and against the proposals must be done in writing to the **Head of Sustainable Communities, Merton Civic Centre, London Road, Morden, Surrey, SM4 5DX** or email trafficanhighways@merton.gov.uk by no later than 4 SEPTEMBER 2015 quoting reference RM/Weir Road.

Objections must relate only to the elements of the scheme that are subject to this statutory consultation. The Council is required to give weight to the nature and content of your representations and not necessarily the quantity. Your reasons are therefore important to us.

Copies of the proposed Traffic Management Order (TMO), a plan identifying the area affected by the proposal and the Council's 'Statement of Reasons' can be inspected at **Merton Link, Merton Civic Centre, London Road, Morden, Surrey, SM4 5DX** during the Council's normal office hours Monday to Friday, 9am to 5pm.

All representations along with Officers' comments and recommendations will be presented in a report to the Cabinet Member for Environmental Sustainability and Regeneration. Please note that responses to any representations received will not be made until a final decision is made by the Cabinet Member. Once a decision is made by the Cabinet Member all who made a representation will be informed accordingly.

CONTACT US

If you require further information, you may email trafficanhighways@merton.gov.uk

WIMBLEDON PARK WARD COUNCILLORS

Cllr Janice Howard Tel - 020 8545 3396

Email: janice.howard@merton.gov.uk

Cllr Oonagh Moulton Tel - 020 8545 3396

Email: oonagh.moulton@merton.gov.uk

Cllr Linda Taylor OBE Tel - 020 8545 3396

Email: linda.taylor@merton.gov.uk

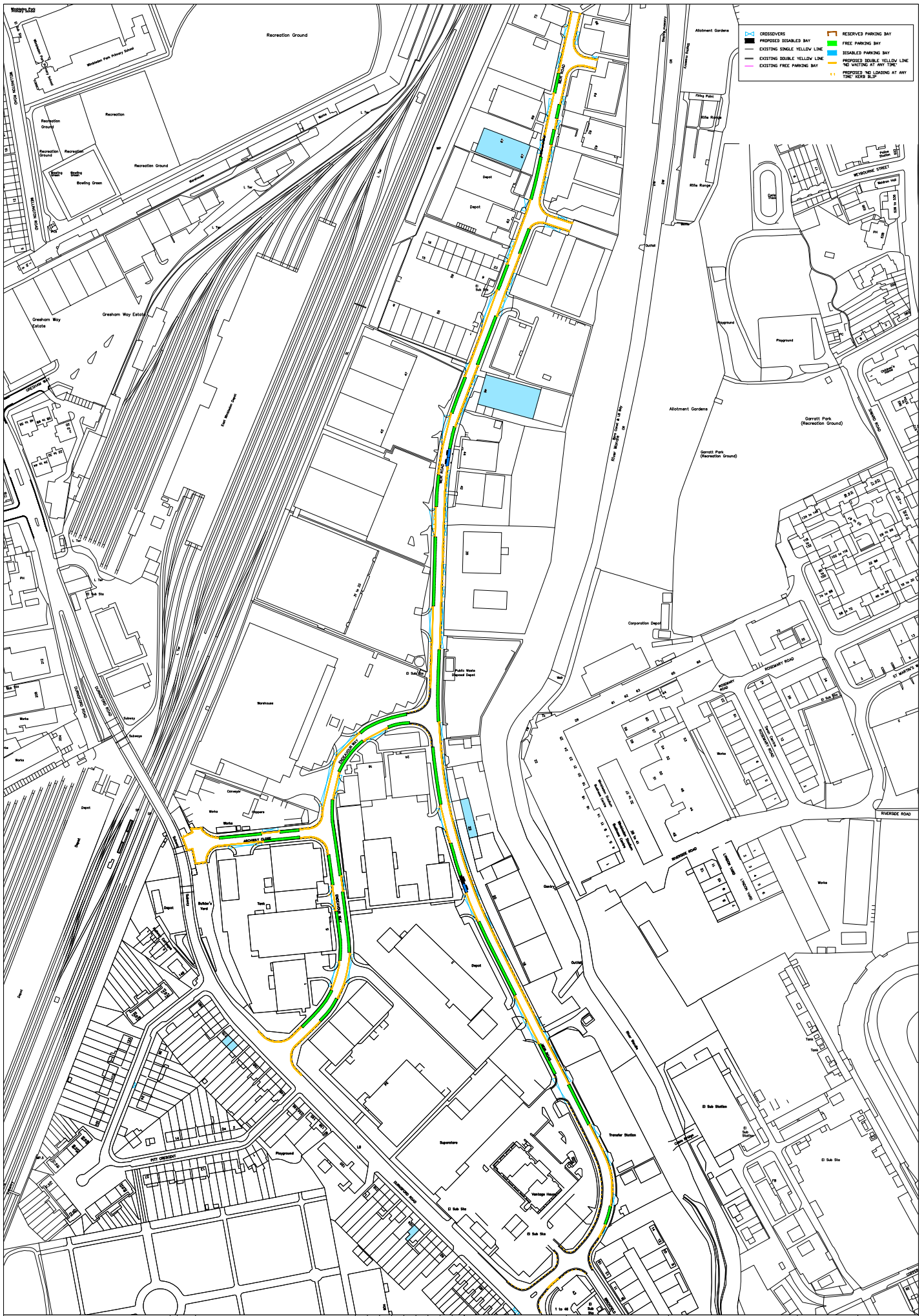

- CROSSOVERS
- PROPOSED DISABLED BAY
- EXISTING DOUBLE YELLOW LINE
- PROPOSED DOUBLE YELLOW LINE
- EXISTING FREE PARKING BAY
- PROPOSED FREE PARKING BAY
- RESERVED PARKING BAY
- FREE PARKING BAY
- DISABLED PARKING BAY
- NO WAITING AT ANY TIME
- PROPOSED NO LOADING AT ANY TIME
- KEYP

Notes

| | | |
|---|---|----|
| 1 | ALL S10 TO S11 AND NO LOADING AT ANY TIME BAYS ADDED TO ALL S10 | SC |
|---|---|----|

| Rev | Reason | Issue No | Issue Date | By | Check No | Check Date | By |
|-----|--------|----------|------------|----|----------|------------|----|
| | | | | | | | |

Sustainable Communities

 environment & regeneration

Waiting Restrictions

Weir Road

Parking Management

Merton Council

 London Borough of Merton

 237-842-00

 DRAFT

 1:1250