



ENVIRONMENT AND REGENERATION DEPARTMENT
Chris Lee - Director



James McGinlay
Head of Sustainable Communities
London Borough of Merton
Merton Civic Centre
London Road
Morden SM4 5DX

Direct Line: 020 8545 3337
Fax: 020 8545 4865
Please ask for paul Atie
Date: 3 March 2017

Dear Resident / Business

Following the Council's decision to introduce the CW3 CPZ in the Pitcairn Road area, I am writing to inform you that the works will start 20 March 2017, which will be carried out by F M Conway Ltd on behalf of the Council.

DATE AND TIME OF WORKS

It is anticipated that the works will start the week commencing 20 March 2017 for a period of 2 weeks, weather permitting. Work will be carried out between 8am and 4.30pm. To allow the works to be carried out as quickly as possible, temporary parking restrictions will be introduced. "No Parking" cones and signs will be in place to indicate the areas where parking would be prohibited. By doing so, this will keep the roads free of parked vehicles allowing a smooth transition of the works. Vehicles would be allowed back into the road to park once the lining work is complete or after the working day. Offending vehicles run the risk of receiving a fine and possible relocation. Residents will be allowed to park on the completed bays during the implementation work.

Notices and cones will be placed in your road 12 – 48hrs prior to work being undertaken.

SCHEDULE OF WORKS: The work schedule of when your road will be marked is shown below.

- Finborough Road, Flander Crescent, Shrewton Road, Arnold Road, Woodley Close and Swains Road **20/21 March.**
- Pitcairn Road, Fleming Mead, North Place **22/23 March.**
- Crusoe Road and Friday Road **24 March.**
- Myrna Close, Alexandra Road, Taylor Road, Tudor Place, and Waldo Place **27/28 March.**
- Victoria Road, Kenmare Drive Devodale **29/30 March** and Singleton Close **31 March.**

The information pack on how to apply for your permit will follow shortly. The Council is conscious of the inconvenience and the disruption that this work may cause and will endeavour to keep the impact to a minimum. We apologise in advance for any inconvenience that may be caused by these works.

FURTHER INFORMATION AND CONTACT DETAILS FOR THE WORKS:

FM Conway Ltd – Gus Smith (Signing Contractor): 07748632920

FM Conway Ltd – Tarkan Moer (Lining Contractor): 07880097106

Merton Council – Paul Atie 020 8545 3337

PAUL ATIE
COMMISSIONING TEAM
FUTURE MERTON
LONDON BOROUGH OF MERTON

Proposed Controlled Parking Zone (CPZ) CW3 - Pitcairn Road area.



ISSUE DATE : 3 MARCH 2017

Dear Resident / Business

This leaflet is to update the community of the outcome of the statutory consultation that was carried out in October / November 2016, and to inform you of the Council's decision to introduce the proposed CW3 CPZ to include Alexandra Road, Arnold Road, Crusoe Road, Dovedale Rise, Finborough Road, Flanders Crescent, Fleming Mead, Friday Road, Island Road, Kenmare Drive, London Road (between Victoria Road and Finborough Road), Myrna Close, North Place, Pitcairn Road, Shrewton Road, Singleton Close, Swains Road, Tudor Place, Victoria Road, Waldo Place and Woodley Close as shown in the plan overleaf.

The statutory consultation resulted in 24 representations, 1 in favour, 4 comments and 19 against. Majority of the objectors are from Island Road which also voted against the proposed CPZ during the informal consultation. All representations received during the statutory consultation along with officer's recommendations were reported to the Cabinet Member for Regeneration, Environment and Housing in February 2017. After careful consideration the following have been agreed:

- To proceed with the making of the relevant Traffic Management Orders (TMO) and the implementation of the proposed CW3 CPZ operational Monday – Friday between 8.30am and 6.30pm. due to lack of majority support Island Road will not be included within the CPZ. however to ensure safety and access, double yellow lines will be introduced at its junctions.
- To implement an exemption Order to allow partial footway parking (two wheels on the footway) in Fleming Mead and Friday Road.
- Singleton Close will be included within the existing CW CPZ operating Monday – Friday between 8.30am and 6.30pm.

What happens next

The final made TMO, which allows the restrictions to be implemented and administered, will be published in the London Gazette and the local newspaper shortly. Notices will

also be placed on lamp columns in the affected areas. It is anticipated that the CPZ will come into operation on 18 April 2017. The report and the decision sheet can be viewed on the Council's website, www.merton.gov.uk/cpzcw3

Please see overleaf for details of the schedule of works.

Finally we would like to thank you for your participation in the consultation process and for your feedback. If you require any further information please email trafficandhighways@merton.gov.uk with reference CPZCW3.

Alternatively this information can be viewed on The Council's website; www.merton.gov.uk/cpzcw3

COLLIERS WOOD AND LAVENDER FIELDS WARD COUNCILLORS

Cllr Laxmi Attawar Tel - 07818 062647
Email: laxmi.attawar@merton.gov.uk

Cllr Caroline Cooper Marbiah Tel: 07940 100 606
Email: caroline.cooper-marbiah@merton.gov.uk

Cllr Nick Draper TEL: 07772 799 036
Email: nick.draper@merton.gov.uk

Cllr Edith Macauley Tel - 07958 317638
Email: edith.macauley@merton.gov.uk

Cllr Mark Allison Phone: 020 8545 3425
Email: mark.allison@merton.gov.uk

Cllr Ross Garrod Phone: 0208 545 3424
Email: ross.garrod@merton.gov.uk

Cllr Martin Whelton Tel: 020 8545 3425
Cabinet Member for Environment, Regeneration and Housing.
Email: martin.whelton@merton.gov.uk

(The contact details of ward councillors are provided for information purposes only)

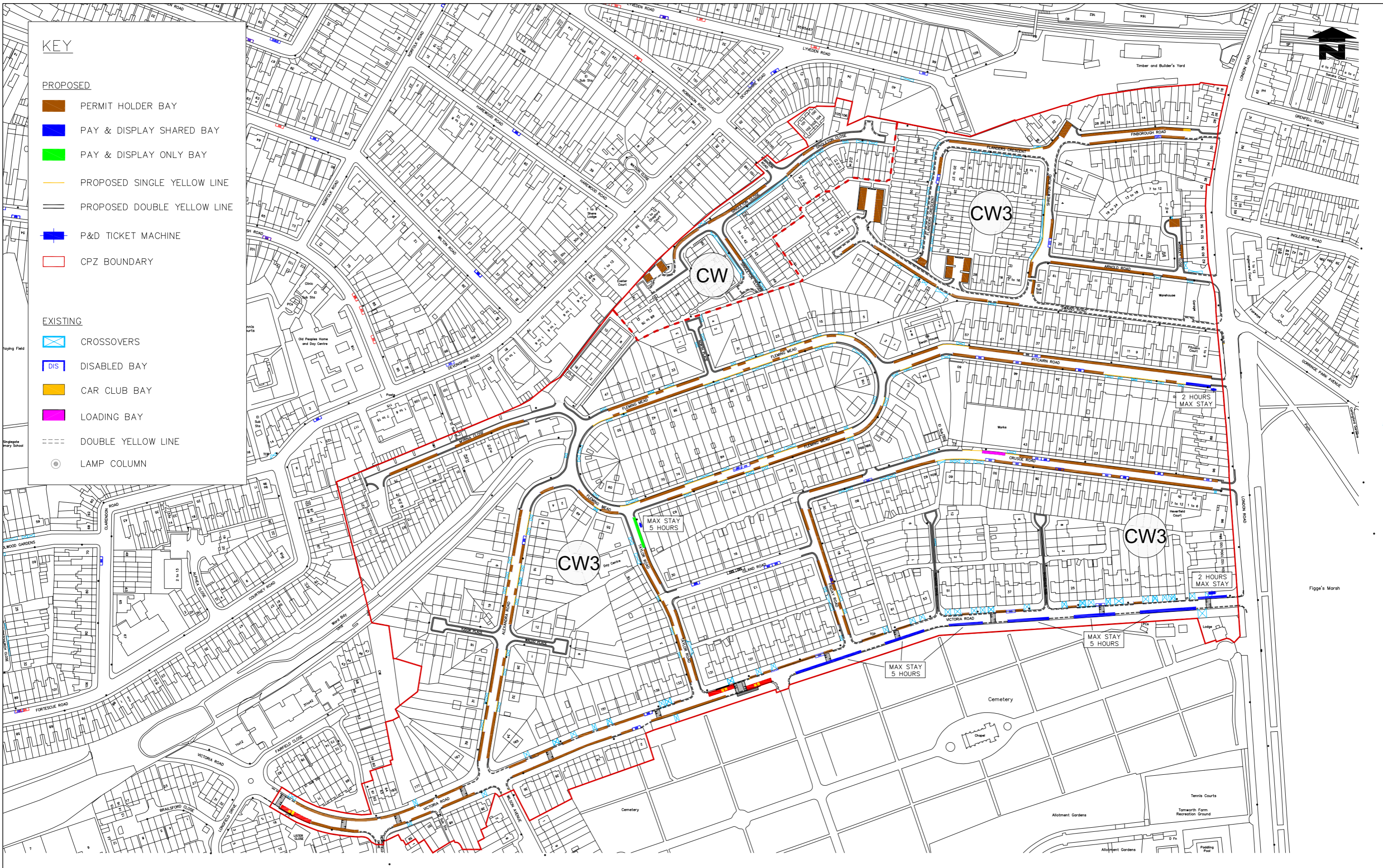

- KEY**
- PROPOSED**
- PERMIT HOLDER BAY
 - PAY & DISPLAY SHARED BAY
 - PAY & DISPLAY ONLY BAY
 - PROPOSED SINGLE YELLOW LINE
 - PROPOSED DOUBLE YELLOW LINE
 - + P&D TICKET MACHINE
 - CPZ BOUNDARY
- EXISTING**
- + CROSSOVERS
 - DISABLED BAY
 - CAR CLUB BAY
 - LOADING BAY
 - DOUBLE YELLOW LINE
 - LAMP COLUMN

Notes
Do not scale from this drawing

| Rev | Revisions | Drawn | Sig. | Date | Chkd. | Sig. | Date | App. | Sig. | Date |
|-----|-----------|-------|------|------|-------|------|------|------|------|------|
| | | | | | | | | | | |

Sustainable Communities
environment & regeneration

TRAFFIC & HIGHWAYS

Reproduced from/based upon the Ordnance Survey's 1:1250 maps with the permission of the Controller of H.M.S.O., Crown Copyright Reserved. Unauthorised reproduction infringes Crown copyright © and may lead to prosecution or civil proceedings. London Borough of Merton 100019259

| | | |
|-------------|------|-------------|
| Drawn by | Sig. | Date |
| SC | | 14 APR 2015 |
| Checked by | Sig. | Date |
| | | |
| Approved by | Sig. | Date |
| | | |

PROJECT
Controlled Parking Zones (CPZ's)

TITLE
CW3 Colliers Wood East Proposed Layout

merton

Merton Civic Centre
London Road
Morden, Surrey
SM4 5DX
www.merton.gov.uk

Drawing No. Z78-231-01
Revision A
Classification IMPLEMENTATION
Scale 1 : 1250