

5DX during the Council's normal office hours Monday to Friday, 9am to 5pm. A copy will also be available at Mitcham Library. This information is also available on Merton Council's website www.merton.gov.uk/cpzcw3.

All representations along with Officers' comments and recommendations will be presented in a report to the Cabinet Member for Regeneration, Environment and Housing. **Please note that responses to any representations received will not be made until a final decision is made by the Cabinet Member.**

The Council is required to give weight to the nature and content of your representations and not necessarily the quantity. Your reasons are, therefore, important to us.

COLLIERS WOOD AND LAVENDER FIELDS WARD COUNCILLORS

Cllr Laxmi Attawar

Tel - 07818 062647

Email: laxmi.attawar@merton.gov.uk

Cllr Caroline Cooper Marbiah

Phone: 07940 100 606

Email: caroline.cooper-marbiah@merton.gov.uk

Cllr Nick Draper

Phone: 07772 799 036

Email: nick.draper@merton.gov.uk

Cllr Edith Macauley

Tel - 07958 317638

Email: edith.macauley@merton.gov.uk

Cllr Mark Allison

Phone: 020 8545 3425

Email: mark.allison@merton.gov.uk

Cllr Ross Garrod

Phone: 0208 545 3424

Email: ross.garrod@merton.gov.uk

The contact details of ward councillors are provided for information purposes only)

Request for document translation
PROPOSED CPZ CW3- PITCAIRN AREA
 If you need any part of this document explained in your language, please tick box and contact us either by writing or by phone using our contact details below.

- Albanian Nëse ju nevojitet ndonjë pjesë e këtij dokumenti e shpjeguar në gjuhën amtare ju lutemi shenoheni kutinë dhe na kontaktoni duke na shkruar ose telefononi duke përdorur detajet e mëposhtme.
- Bengali এই ডকুমেন্টের কোনো অংশ আপনার নিজ ভাষায় বুঝতে চাইলে, দয়া করে বাংলায় (বা অন্য নিজ নিজ মাতৃ ভাষায়) এর অর্থ ব্যাখ্যা করে আমাদের সাথে যোগাযোগ করুন। নিচের যোগাযোগের বিবরণ দেখুন।
- French Si vous avez besoin que l'on vous explique une partie de ce document dans votre langue, cochez la case et contactez-nous par courrier ou par téléphone à nos coordonnées figurant ci-dessous.
- Korean 만일 본 서류의 어떤 부분이라도 귀하의 모국어로 설명된 것이 필요하다면, 상자속에 표시를 하고 우리에게 전화나 서신으로 연락하십시오.
- Polish Aby otrzymać część tego dokumentu w polskiej wersji językowej proszę zaznaczyć kwadrat i skontaktować się z nami drogą pisemną lub telefoniczną pod poniższej podanym adresem lub numerem telefonu.
- Portuguese Caso você necessite qualquer parte deste documento explicada em seu idioma, favor assinalar a quadricula respectiva e contatar-nos por escrito ou por telefone usando as informações para contato aqui fornecidas.
- Somali Haddii aad u baahan tahay in qayb dukumeentigan ka mid ah laguugu sharxo luqaddaada, fadlan sax ku calaamadee sanduuqa oo nagula soo xiriir warqad ama telefoon adigoo isticmaalaya macluumaadka halkaan hoose ku yaalla.
- Spanish Si desea que alguna parte de este documento se traduzca en su idioma, le rogamos marque la casilla correspondiente y que nos contacte bien por escrito o telefonicamente utilizando nuestra información de contacto que encontrará más abajo.
- Tamil இந்த ஆவணத்தின் எந்த ஒரு பகுதியும் உங்களுக்குத் தெரியாததாக இருந்தால், அதற்கான பகுதியைக் குறிப்பிட்டு, எங்கள் ஆவணத்தை உங்களுக்குத் தெரியுமாறு அங்கு குறிப்பிட்டுள்ள தகவலைப் பயன்படுத்தி தொடர்பு கொள்ளுங்கள்.
- Urdu اگر آپ کو اس دستاویز کے کسی حصے کی وضاحت چاہیے تو براہ کرم اس حصے کے بائیں جانب موجود خانے کو نشان لگائیں اور ہمیں خط یا فون پر رابطہ کر کے اس کی وضاحت مانگیں۔

Large print Braille Audiotape

Your contact:
 Name..... Paul Atie,
 Address..... Merton Civic Centre,
 London Road, Morden,
 Telephone..... SM4 5DX

Proposed Controlled Parking Zone (CPZ) CW3 - Pitcairn Road Area



Councillor Martin Whelton
 Cabinet Member for
 Regeneration, Environment and
 Housing.
 T: 020 8545 3425
 E: martin.whelton@merton.gov.uk



ISSUE DATE : 27 OCTOBER 2016

Dear Resident/Business

The purpose of this leaflet is to let you know the outcome of the informal consultation carried out in June 2016 on the proposal to introduce a controlled parking zone (CPZ) in your road.

CW3 CPZ CONSULTATION RESULTS

The consultation resulted in a total of 163 questionnaires returned from the roads within the proposed CPZ area representing a response rate of 15.5%. A detailed road by road analysis of the results show that 58.3% support a CPZ in their road, compared to 39.2% who do not and 2.5% who are unsure or did not comment. Residents were also asked which hours of operation they would prefer should the CPZ be introduced. Results show 44.8% of respondents prefer 8.30am – 6.30pm, 31.1% prefer 11am – 3pm, 19% prefer 10am – 4pm and 5.1% who are unsure or made no response. On the days of operation, the results shows that 56.4% of respondents prefer Mon – Fri, 15.5% support Mon – Sat, 27% prefer Mon –Sun and 1.2% are unsure or made no response.

The results of the consultation along with officers' recommendation were presented in a report to the Cabinet Member for Environment, Regeneration and Housing on the 15 August 2016. The report and the decision sheet can be viewed on our website. www.merton.gov.uk/cpzcw3. The following recommendations which were made to the Cabinet Member have now been agreed:

- To proceed with a statutory consultation to include Alexandra Road, Arnold Road, Crusoe Road, Dovedale Rise, Finborough Road, Flanders Crescent, Fleming Mead, Friday Road, Island Road, Kenmare Road, London Road, Myrna Road, North Place, Pitcairn Road, Shrewton Road, Singleton Road, Swains Road, Tudor Road, Victoria Road, Waldo Place and Woodley Close into the proposed CW3 CPZ, operational Monday to Friday between

8.30am and 6.30pm.

- To proceed with a statutory consultation on relevant Traffic Management Orders (TMOs) on the proposed 'At any time' waiting restrictions in various roads if the CPZ does not go ahead. **Please see plan overleaf.**
- To proceed with a statutory consultation to include Singleton Close into the existing CW CPZ operating Monday – Friday between 8.30am and 6.30pm.
- To proceed with a statutory consultation to change the proposed permit holder bays along the Cemetery in Victoria Road to shared use bays with 5 hrs Max stay.
- To allow footway parking in Fleming Mead and Friday Road which maximise the number of parking spaces.

WHAT HAPPENS NEXT

A Notice of the Council's intention to introduce the above measures will be published in a local newspaper (The Guardian), London Gazette and posted on lamp columns in the vicinity. Representations against the proposals described in this Notice must be made in writing or email to trafficandhighways@merton.gov.uk by no later than **18 November 2016** quoting reference **ES/CW3**. Objections must relate only to the elements of the scheme that are subject to this statutory consultation.

A copy of the proposed Traffic Management Orders (TMOs), a plan identifying the areas affected by the proposals and the Council's Statement of Reasons can be inspected at Merton Link, Merton Civic Centre, London Road, Morden, Surrey, SM4

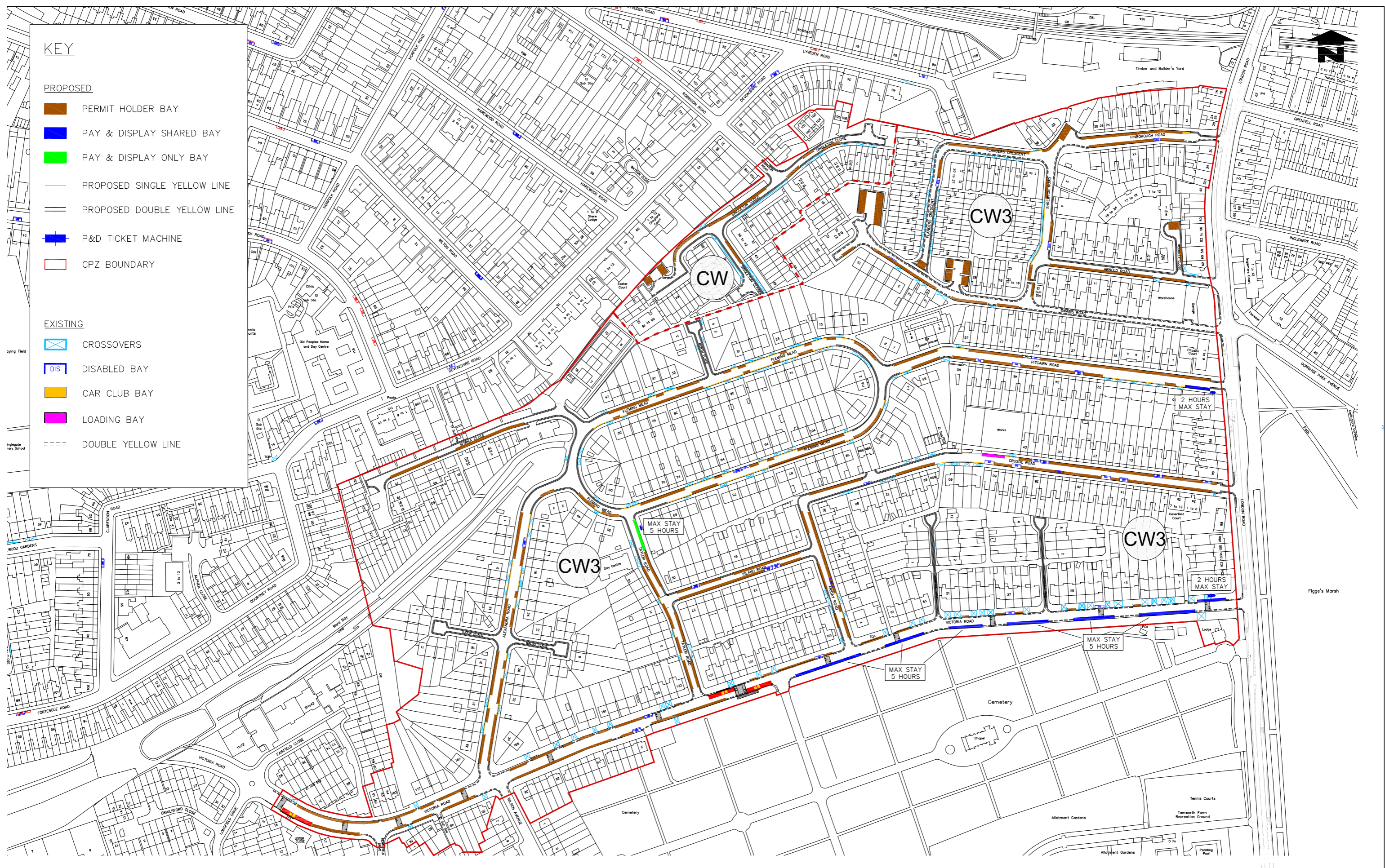

KEY

PROPOSED

- PERMIT HOLDER BAY
- PAY & DISPLAY SHARED BAY
- PAY & DISPLAY ONLY BAY
- PROPOSED SINGLE YELLOW LINE
- PROPOSED DOUBLE YELLOW LINE
- P&D TICKET MACHINE
- CPZ BOUNDARY

EXISTING

- CROSSOVERS
- DISABLED BAY
- CAR CLUB BAY
- LOADING BAY
- DOUBLE YELLOW LINE

Notes
Do not scale from this drawing

Rev.	Revisions	Drawn	Sig.	Date	Chkd.	Sig.	Date	App.	Sig.	Date

TRAFFIC & HIGHWAYS

Reproduced from/based upon the Ordnance Survey's 1:1250 maps with the permission of the Controller of H.M.S.O., Crown Copyright Reserved. Unauthorized reproduction infringes Crown copyright and may lead to prosecution or civil proceedings.
London Borough of Merton 100019259

Drawn by	Sig.	Date
SC		14 APR 2015
Checked by	Sig.	Date
Approved by	Sig.	Date

PROJECT
Controlled Parking Zones (CPZ's)

TITLE
CW3 Colliers Wood East Proposed Layout

Merton Civic Centre
London Road
Morden, Surrey
SM4 5DX
www.merton.gov.uk

Drawing No.	Z78-231-01
Revision	A
Classification	CONSULTATION
Scale	1 : 1250