

# Controlled Parking Zones (CPZs)

## Review of Zone 5F

### Merton Hall Road Area, Wimbledon



ISSUE DATE : 23 OCTOBER 2009

Merton - Putting you first

**Dear Resident / Business,**

The purpose of this consultation document is to inform you that the Council is carrying out a review of the existing '5F' Controlled Parking Zone (CPZ) and to seek your views on its operation.

Zone 5F was implemented in 2001. Since its introduction the Council has not had the opportunity to carry out a significant review to address any requests and concerns the local community may have. The objective of the review is to identify any such alterations to improve road safety and the operation of the parking controls to benefit its residents and businesses. This could involve the introduction of double yellow lines at key locations such as junctions; changes to the CPZ hours of operation (currently Monday to Friday, between 8.30am and 6.30pm); changes to the use of certain parking bays; and additional bays or extensions where suitable.

In addition, to enable effective enforcement of the controls, it is necessary to ensure that all the restrictions comply with the Department for Transport's (DfT) regulations. This means that all designated on-street parking bays and other restrictions with different operational times to the CPZ, must be clearly and correctly marked and signed.

#### **PROPOSED CHANGES**

The following changes are proposed as shown on the enclosed Drawing No's. Z78/157/01 Sheets 1 & 2.

- To provide additional spaces or extend parking bays in Mayfield Road outside the telephone exchange; William Road outside property no 5; and Newton Road opposite no 2, without compromising safety and access.
- To improve safety and access by reducing obstructive parking that is currently taking place outside the controlled times by replacing the existing single yellow lines with double yellow lines at certain locations such as culs-de-sac, bends and to provide passing gaps.
- To allow 15 minutes free parking in the pay & display shared use bays in Avesbury Road to encourage parents to park in these bays instead of parking in residents' permit bays in the area surrounding Wimbledon Chase School. This will particularly help reduce the pressure on parking as the pupil intake to the school will increase in the coming years.

CPZ's that have been operating for a number of years generally operate Monday to Saturday in Town Centres. These controlled times are more suitable for a number of reasons, ie. shoppers especially on Saturdays, businesses and local employees. Away from Town Centres the controlled days may differ, however these areas may also be closer to train stations, attracting commuter parking. We recognise that these may require different operating hours therefore there is a case to consider alternative controlled times in areas away from Town Centres.

#### **OPTIONAL CHANGES**

The following optional changes could be considered where there is general support.

To change the operational hours:

- **One-hour operation (11am - 12 noon):**

*This minimum restriction will offer more flexibility for residents' visitors than the current all day controls, reducing the amount of visitors' permits they would normally need, and is still effective in restricting commuters and other long stay parking. However, it may encourage other short term parking by non-residents or businesses. Non residents may also work their way around the one-hour by moving their vehicles and then returning to park for the rest of the day. Full enforcement of an entire zone within a one-hour period may also put extra pressure on Enforcement Officers, making the parking controls less effective. The standard annual parking permit charges will still apply regardless of the hours the zone operates.*

- **Reduced hours of operation (10am - 4pm):**

*These operating times offer less restrictions on residents and their visitors than the current 'all day' controls. It is still effective in preventing commuters and other long stay parkers. However, it may encourage short term parking outside the operating times by non residents or businesses. Residents returning from work later in the afternoon may find less available parking in their street due to this. Motorists unable to park in nearby zones with longer operating times*

may also take advantage of the available parking outside the controlled times. The standard annual parking permit charges will still apply regardless of the hours the zone operates.

- **To increase the operational days (Monday to Saturday):**  
Additional controls on Saturdays would provide residents with added parking priority, but would put more restrictions on residents and their visitors.

**LET US KNOW YOUR VIEWS**

The decision on any changes to the scheme will be subject to the responses received during this consultation. Please complete and return the enclosed prepaid questionnaire (no stamp required) with any further comments/suggestions you may have by **20 November 2009**. We regret that due to the large number of responses received during a public consultation it will not be possible to individually reply to each respondent. We welcome your comments on this proposal, which will be noted and included within the proposed measures where appropriate.

**WHAT HAPPENS NEXT**

The results of the consultation along with officers' recommendations will be presented in a report to the Street Management Advisory Committee for consideration and subsequently to the Cabinet Member for Planning and Traffic Management for a decision. Once a decision is made you will be informed accordingly.

**CONTACT US**

If you require further information please contact Mr James Geeson on 020 8545 3054 or email him at [james.geeson@merton.gov.uk](mailto:james.geeson@merton.gov.uk). Alternatively you can visit our website using the following link [www.merton.gov.uk/5F\\_review](http://www.merton.gov.uk/5F_review) or you may view the plans in Merton Link at Merton Civic Centre, Morden.

**Dundonald Ward Councillors**

**Councillor Chris Edge**

Tel - 020 8213 5877

Email: [chris.edge@merton.gov.uk](mailto:chris.edge@merton.gov.uk)

**Councillor Corinna Edge**

Tel - 020 8545 3396

Email: [corinna.edge@merton.gov.uk](mailto:corinna.edge@merton.gov.uk)

**Councillor Denise March**

Tel - 020 8251 2316

Email: [denise.march@merton.gov.uk](mailto:denise.march@merton.gov.uk)

**Merton Park Ward Councillors**

**Councillor Karin Forbes**

Tel - 020 8540 3314

Email: [karin.forbes@merton.gov.uk](mailto:karin.forbes@merton.gov.uk)

**Councillor Peter Southgate**

Tel - 020 8542 2053

Email: [peter.southgate@merton.gov.uk](mailto:peter.southgate@merton.gov.uk)

**Councillor Krysia Williams**

Tel - 020 8542 8687

Email: [krysia.williams@merton.gov.uk](mailto:krysia.williams@merton.gov.uk)

**Request for document translation**

**REVIEW OF ZONE 5F**

If you need any part of this document explained in your language, please tick box and contact us either by writing or by phone using our contact details below.

- Albanian Nëse ju nevojitet ndonjë pjesë e këtij dokumenti e shpjeguar në gjuhën amtare ju lutemi shenjojeni kutinë dhe na kontaktoni duke na shkruar ose telefononi duke përdorur detajet e mëposhtme.
- Bengali এই অধঃর কোনো অংশ আপনার নিজঃ অমঃর বঃবতে চাইলে, দঃরা করে বঃবঃটিতে (বঃবঃ) টিকঃ চিঃক দিন এবং চিঃঠি লিখে বা ফোন করে আমাদের সাথে যোগাযোগ করুন। নিঃচঃ যোগাযোগের বিঃবরণ দেওয়া হয়েছে।
- French Si vous avez besoin que l'on vous explique une partie de ce document dans votre langue, cochez la case et contactez-nous par courrier ou par téléphone à nos coordonnées figurant ci-dessous.
- Korean 만일 본 서류의 어떤 부분이라도 귀하의 모국어로 설명될것이 필요하다면, 상지속에 표시를하고 우리에게 전화나 서신으로 연락하십시오.
- Polish Aby otrzymać część tego dokumentu w polskiej wersji językowej proszę zaznaczyć kwadrat i skontaktować się z nami drogą pisemną lub telefoniczną pod poniżej podanym adresem lub numerem telefonu.
- Portuguese Caso você necessite qualquer parte deste documento explicada em seu idioma, favor assinalar a quadrícula respectiva e contatar-nos por escrito ou por telefone usando as informações para contato aqui fornecidas.
- Somali Haddii aad u baahan tahay in qayb dukumeentigan ka mid ah laguugu sharxo luqaddaada, fadlan sax ku calaamadee sanduuqa oo nagula soo xiriir warqad ama telefoon adigoo isticmaalaya macluumaadka halkaan hoose ku yaalla.
- Spanish Si desea que alguna parte de este documento se traduzca en su idioma, le rogamos marque la casilla correspondiente y que nos contacte bien por escrito o telefónicamente utilizando nuestra información de contacto que encontrará más abajo.
- Tamil இதுள் பகுதிகளில் ஏதாவது பகுதியை உங்களின் மொழியில் விளக்கப்படுவது உண்டாக வேண்டுமானால், கனம் குடியேற்ற இயக்குநர் அவர்களுக்கு, கீழ்க்கண்ட விவரங்களில் யாதுவாறும் எழுதப்படுவதற்கான தகவலைக் கொடுக்கப்படுகிறது.
- Urdu اگر آپ اس دستاویز کے کسی حصے کا ترجمہ چاہتے ہیں تو اس حصے کے پاس گنگ کا ٹیکہ لگا کر اسے اور فارسی، اردو، پنجابی، ہندی اور انگریزی کے ذریعے یا ہماری قریبی ممبر پر بلا کر کریں۔

- Large print
- Braille
- Audiotape

<p><b>Your contact:</b> Name..... Address..... ..... Telephone.....</p>	<p>James Geeson, Merton Civic Centre, London Road, Morden, SM4 5DX</p>
---	--



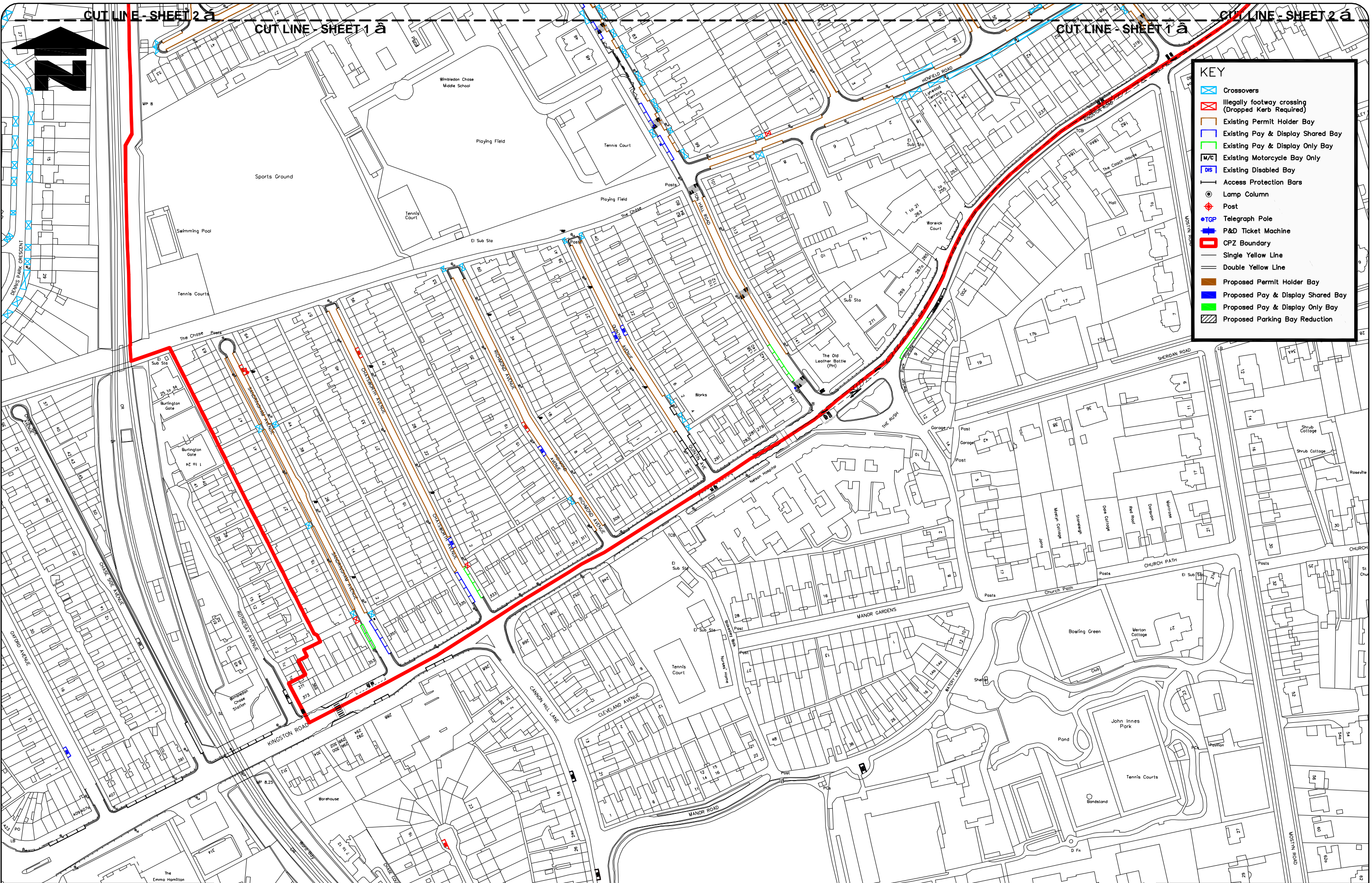

KEY	
	Crossovers
	Illegally footway crossing (Dropped Kerb Required)
	Existing Permit Holder Bay
	Existing Pay & Display Shared Bay
	Existing Pay & Display Only Bay
	Existing Motorcycle Bay Only
	Existing Disabled Bay
	Access Protection Bars
	Lamp Column
	Post
	Telegraph Pole
	P&D Ticket Machine
	CPZ Boundary
	Single Yellow Line
	Double Yellow Line
	Proposed Permit Holder Bay
	Proposed Pay & Display Shared Bay
	Proposed Pay & Display Only Bay
	Proposed Parking Bay Reduction

Reproduced from/based upon the Ordnance Survey's 1:1250 maps with the permission of the Controller of H.M.S.O., Crown Copyright Reserved. Unauthorised reproduction infringes Crown copyright © and may lead to prosecution or civil proceedings. London Borough of Merton 100019259 2009

## ZONE 5F REVIEW - PROPOSED CHANGES

### SHEET 1 OF 2





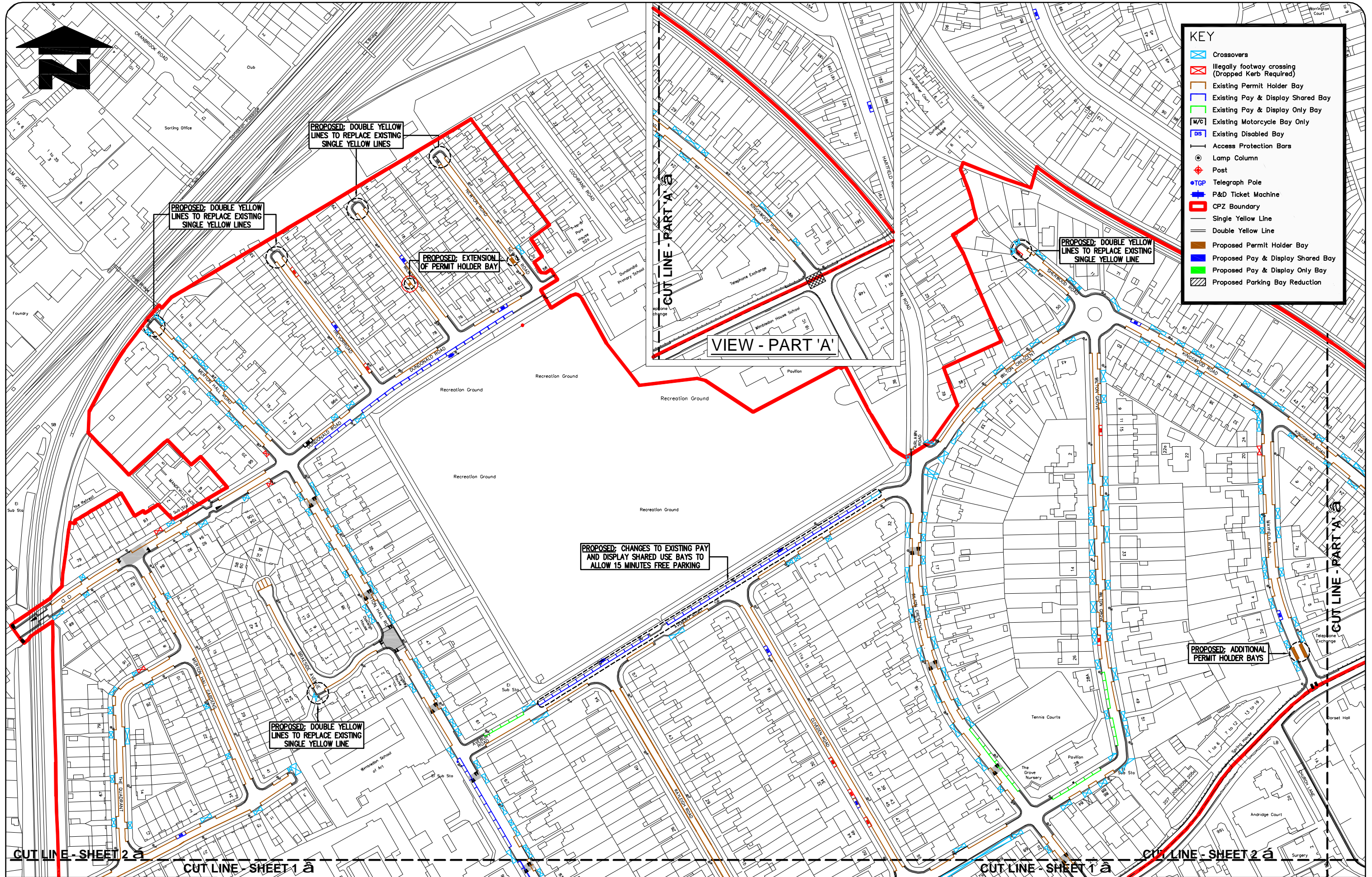

KEY	
	Crossovers
	Illegally footway crossing (Dropped Kerb Required)
	Existing Permit Holder Bay
	Existing Pay & Display Shared Bay
	Existing Pay & Display Only Bay
	Existing Motorcycle Bay Only
	Existing Disabled Bay
	Access Protection Bars
	Lamp Column
	Post
	Telegraph Pole
	P&D Ticket Machine
	CPZ Boundary
	Single Yellow Line
	Double Yellow Line
	Proposed Permit Holder Bay
	Proposed Pay & Display Shared Bay
	Proposed Pay & Display Only Bay
	Proposed Parking Bay Reduction

Reproduced from/based upon the Ordnance Survey's 1:2500 maps with the permission of the Controller of H.M.S.O., Crown Copyright Reserved. Unauthorised reproduction infringes Crown copyright © and may lead to prosecution or civil proceedings. London Borough of Merton 100019259 2009

# ZONE 5F REVIEW - PROPOSED CHANGES

## SHEET 2 OF 2

