

Wimbledon Park

Existing Site Survey and Analysis

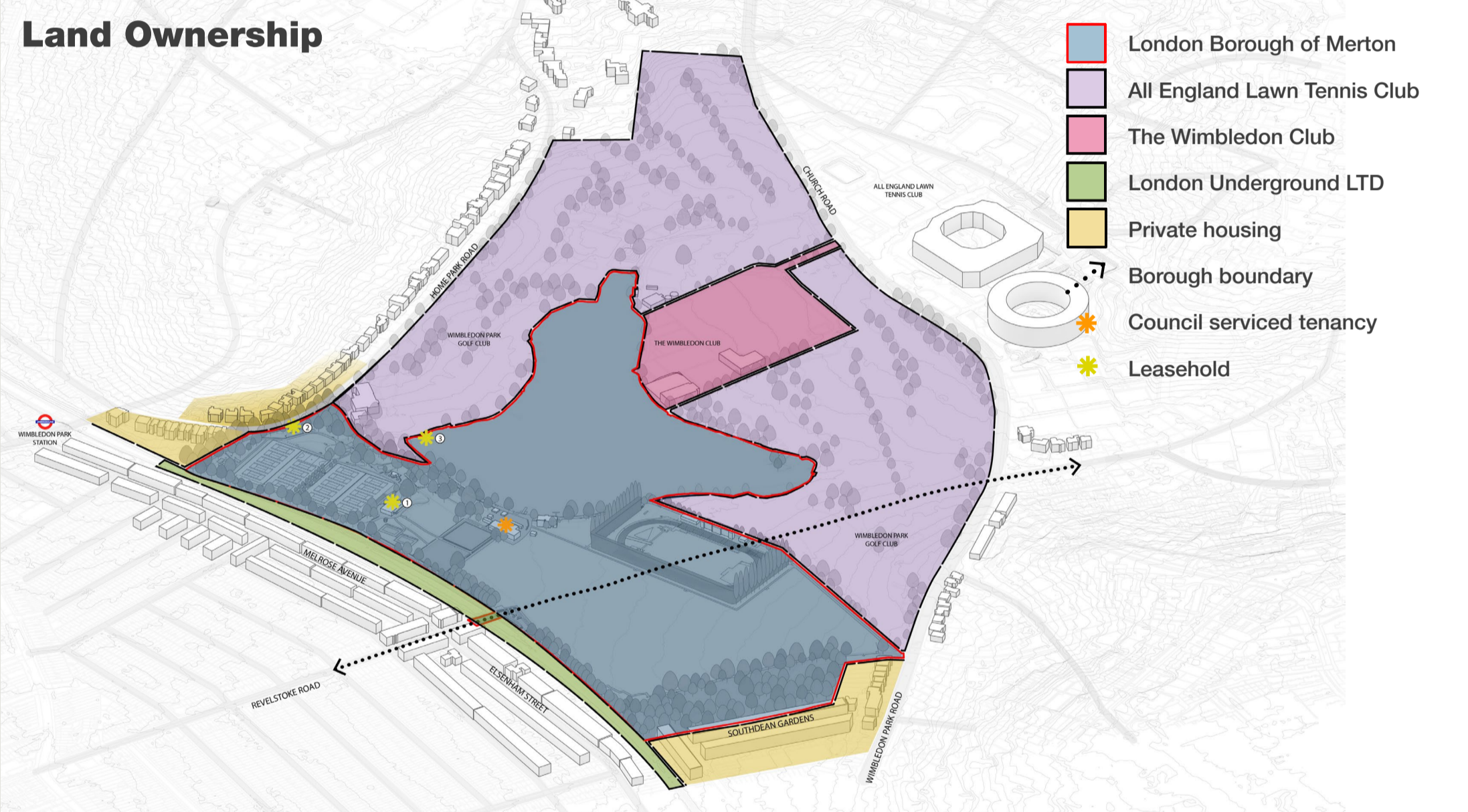
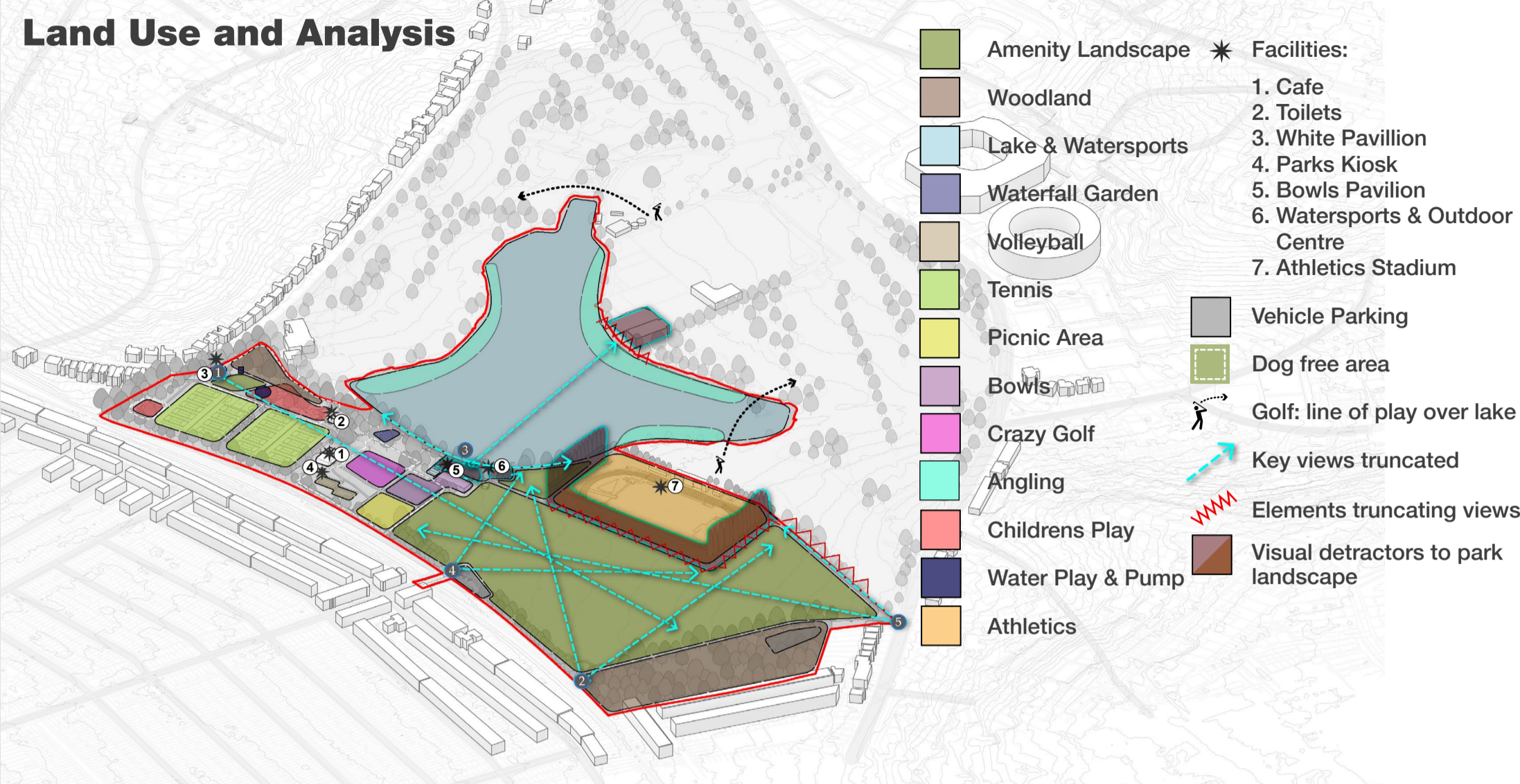

Wimbledon Park Proposed Masterplan

Proposed Land Use and Activities

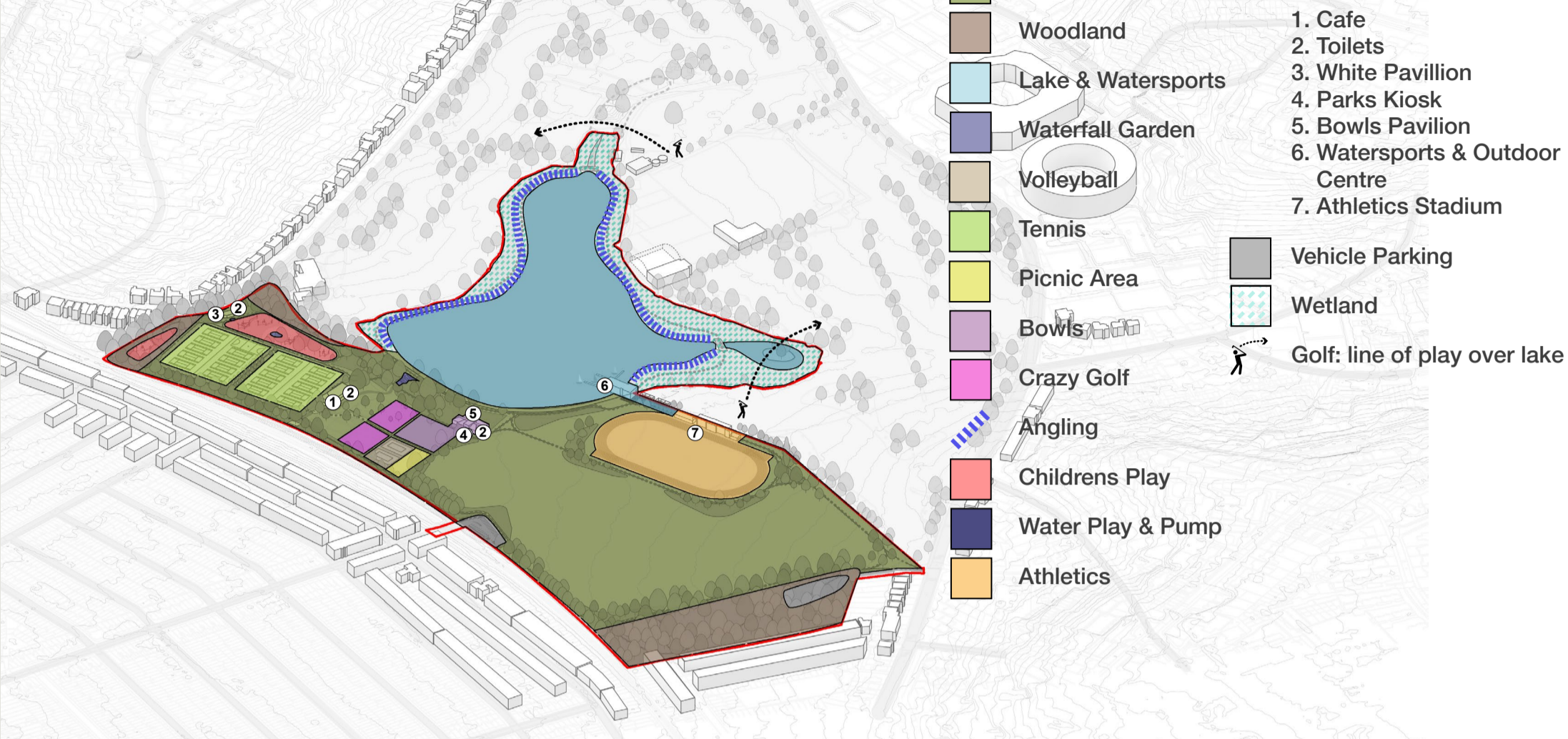

Buildings

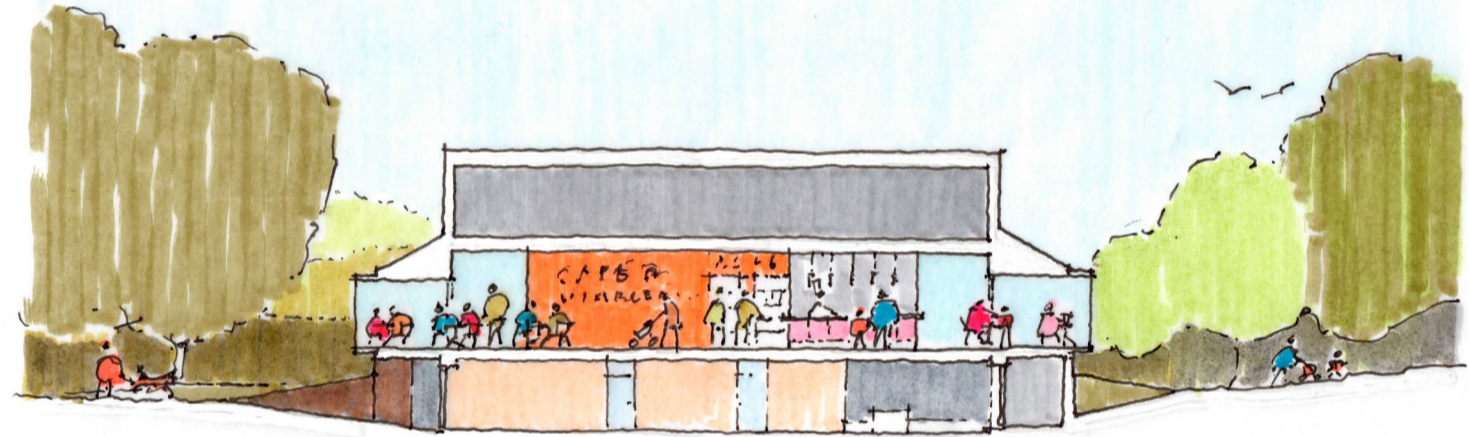

Cafe: Sketch showing section showing extended upper floor east and west

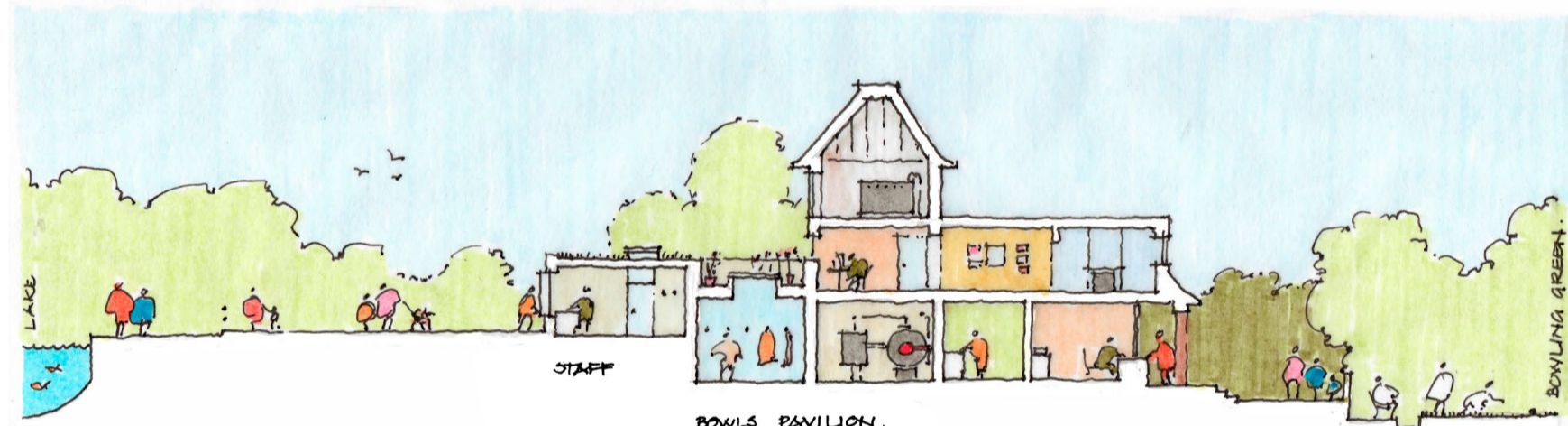

Cafe: Bowls Pavilion: Sketch section, showing new extension onto the lake

Proposed Vegetation Types and Management



Proposed Masterplan

KEY TO PROPOSED PARK FEATURES

- Lake
- Lake Embankment / Dam
- Waterfall Garden
- Brook
- "The Great Field"
- Horse Close Wood
- Ashen Grove
- Revelstoke Road entrance
- Wimbledon Park Road entrance
- Home Park Road entrance
- Revelstoke Road car park
- Woodand car park
- Golf Club boundary
- Railway embankment
- White Pavilion
- Toilet Block
- Play Area, incl. Water Play
- Toddler Play Area
- Tennis Courts
- Cafe Building
- Parks Maintenance / Staff
- Crazy Golf
- Beach Volleyball
- Bowls Pavilion
- Bowling Green 1
- Picnic Area (former bowling green)
- Existing Watersport & Outdoor Centre demolished
- New Watersport & Outdoor Centre
- Athletics Buildings
- Athletics Track
- New path around Lake

