

LONDON BOROUGH OF MERTON
CONTROLLED PARKING ZONE P3
CROSSOVER – RAVENSBURY TERRACE

THE MERTON (PARKING PLACES) (P3) (NO. 1) (AMENDMENT NO. 1) ORDER 2021
THE MERTON (WAITING AND LOADING RESTRICTION) (AMENDMENT NO. 488) ORDER
2021

1. **NOTICE IS HEREBY GIVEN** that the Council of the London Borough of Merton, on 10 May 2021, made the above-mentioned Orders under sections 6, 45, 46, 49 and 124 of and Part IV of Schedule 9 to the Road Traffic Regulation Act 1984, as amended.
2. The general effect of the ‘Places Places’ Order will be to amend the London Borough of Merton (Parking Places) (P3) (No. 1) Traffic Order 2012 so as to relocate the parking bays outside No. 12A Ravensbury Terrace to the opposite side of Ravensbury Terrace.
3. The general effect of the ‘Waiting and Loading’ Order will be to amend the Merton (Waiting and Loading Restriction) Order 1977 so that waiting by vehicles (otherwise than for the purpose of delivering or collecting goods or loading or unloading a vehicle) will be prohibited at any time outside No. 12A Ravensbury Terrace.
4. A copy of the Orders, which will come into force on 24 May 2021, and other documents giving more detailed particulars of the Orders, including a plan specifying the lengths of road affected by the Orders, can be inspected during normal office hours on Mondays to Fridays inclusive until the end of six weeks from the date on which the Orders were made at Merton Link, Merton Civic Centre, London Road, Morden, Surrey, SM4 5DX. The documents have also been made available for inspection at <https://www.merton.gov.uk/streets-parking-transport/traffic-management/consultations> .
5. Any person desiring to question the validity of the Orders or of any provision contained therein on the grounds that it is not within the relevant powers of the Road Traffic Regulation Act 1984, or that any of the relevant requirements thereof, or of any relevant regulations made thereunder has not been complied with in relation to the Orders may, within six weeks from the date on which the Orders were made, make application for the purpose to the High Court.

Dated: 10 May 2021.

Paul McGarry
Head of futureMerton
London Borough of Merton,
Merton Civic Centre,
London Road,
Morden Surrey, SM4 5DX



LONDON BOROUGH OF MERTON

TRAFFIC MANAGEMENT ORDER

2021 No. 23

The Merton (Parking Places) (P3) (Amendment No. 1) Order 2021

Made: 10 May 2021

Coming into force: 24 May 2021

THE COUNCIL OF THE LONDON BOROUGH OF MERTON, having consulted with the Commissioner for the Metropolitan Police, in exercise of the powers conferred by sections 45, 46, 49 and 124 of and Part IV of Schedule 9 to the Road Traffic Regulation Act 1984(a), as amended by Section 8 of and Part 1 of Schedule 5 to the Local Government Act 1985(b), and of all other powers so enabling, hereby make the following Order:-

1. The Order shall come into force on 24 May 2021 and may be cited as the Merton (Parking Places) (P3) (Amendment No. 1) Order 2021.
2. The interpretation Act 1978(c) shall apply for the interpretation of this Order as it applies for the interpretation of an Act of Parliament.
3. Without prejudice to the validity of anything done or to any liability incurred in respect of any act or omission before the coming into operation of this Order, the London Borough of Merton (Parking Places) (P3) (No. 1) Traffic Order 2012(d) shall have effect as though:
 - (a) for the item numbered 8 of Schedule 3 to that Order there were substituted the item similarly numbered and set out in columns 1, 2 and 3 of the Schedule to this Order.

Dated this tenth day of May 2021.

PAUL MCGARRY
Head of futureMerton
London Borough of Merton

(a) 1984 c.27 (b) 1985 c.51 (c) 1978 c.30 (d) L.B.M 2012/52 as amended by L.B.M. 2020/101 and 2020/107.

SCHEDULE

IN RELATION TO A PARKING PLACE REFERRED TO IN THIS SCHEDULE THE EXPRESSION "PERMITTED HOURS" MEANS THE PERIOD FROM 9.30AM TO 4.30PM MONDAY TO FRIDAY ANY SUCH DAY NOT BEING CHRISTMAS DAY GOOD FRIDAY OR A BANK HOLIDAY DURING WHICH A VEHICLE MAYBE LEFT

- (A) FOR A MAXIMUM PERIOD OF TWO HOURS IF IT DISPLAYS A VALID TICKET FROM A TICKET PARKING MACHINE, NO RETURN WITHIN TWO HOURS
- (B) IF IT DISPLAYS A VALID RESIDENTS PERMIT OR A VALID VISITORS PERMIT ISSUED IN RESPECT OF ZONE P3
- (C) IF IT DISPLAYS A VALID BUSINESS PERMIT ISSUED IN RESPECT OF ZONE P3
- (D) A VALID TEACHER PERMIT ISSUED IN RESPECT OF ZONE P3
- (E) A VALID TRADE PERMIT

Item No.	Designated Parking Place	Special manner of parking
1.	2.	3.
8.	RAVENSBURY TERRACE, the north-west side, from a point 4 metres south-west of the boundary of the London Borough of Merton with the London Borough of Wandsworth south-westward for a distance of 20 metres.	-



LONDON BOROUGH OF MERTON

TRAFFIC MANAGEMENT ORDER

2021 No. 24

The Merton (Waiting and Loading Restriction) (Amendment No. 488) Order 2021

Made: 10 May 2021

Coming into force: 24 May 2021

The Council of the London Borough of Merton, after consulting the Commissioner of Police of the Metropolis, in exercise of the powers conferred under sections 6 and 124 of, and Part IV of Schedule 9 to, the Road Traffic Regulation Act 1984(a), as amended by Section 8 of and Part 1 of Schedule 5 to the Local Government Act 1985(b), and of all other powers thereunto enabling, hereby make the following Order:-

1. This Order shall come into force on 24 May 2021 may be cited as the Merton (Waiting and Loading Restriction) (Amendment No. 488) Order 2021.
2. Without prejudice to the validity of anything done or to any liability incurred in respect of any act or omission before the coming into operation of this Order, the Merton (Waiting and Loading Restriction) Order 1977(c) shall have effect as though there were added to Schedule 1 to that Order, the item numbered 3273 and set out in columns 1, 2 and 3 of the Schedule to this Order.

Dated this tenth day of May 2021.

PAUL MCGARRY
Head of futureMerton
London Borough of Merton

(a) 1984 c.27 (b) 1985 c.51 (c) G.L.C. 1977/107 – the relevant amending Orders are L.B.M. 2002/37 and 2011/44.

Published by the London Borough of Merton
Merton Civic Centre
London Road, SM4 5DX

SCHEDULE

1. Item No.	2. Street/Description	3. Prescribed hours
3273.	Ravensbury Terrace (a) the south-east side, (b) the north-west side, (i) from the boundary of the London Borough of Wandsworth with the London Borough of Merton south-westward for a distance of 4 metres; (ii) from a point 4 metres south-west of the boundary of the London Borough of Wandsworth with the London Borough of Merton south-westward for a distance of 20 metres; (iii) from a point 24 metres south-west of the boundary of the London Borough of Wandsworth with the London Borough of Merton south-westward to its south-westernmost extremity.	A A ZG A

LONDON BOROUGH OF MERTON

**CONTROLLED PARKING ZONE P3
PROPOSED CROSSOVER – RAVENSBURY TERRACE**

**THE MERTON (PARKING PLACES) (P3) (NO. 1) (AMENDMENT NO. *) ORDER 202*
THE MERTON (WAITING AND LOADING RESTRICTION) (AMENDMENT NO. *) ORDER
202***

STATEMENT OF REASONS

(A brief statement of the general nature and effect of the Order)

Parking Places Amendment

The proposals are to relocate a designated parking place in Ravensbury Terrace to the opposite side of the road to facilitate a new crossover at No. 12A Ravensbury Terrace.

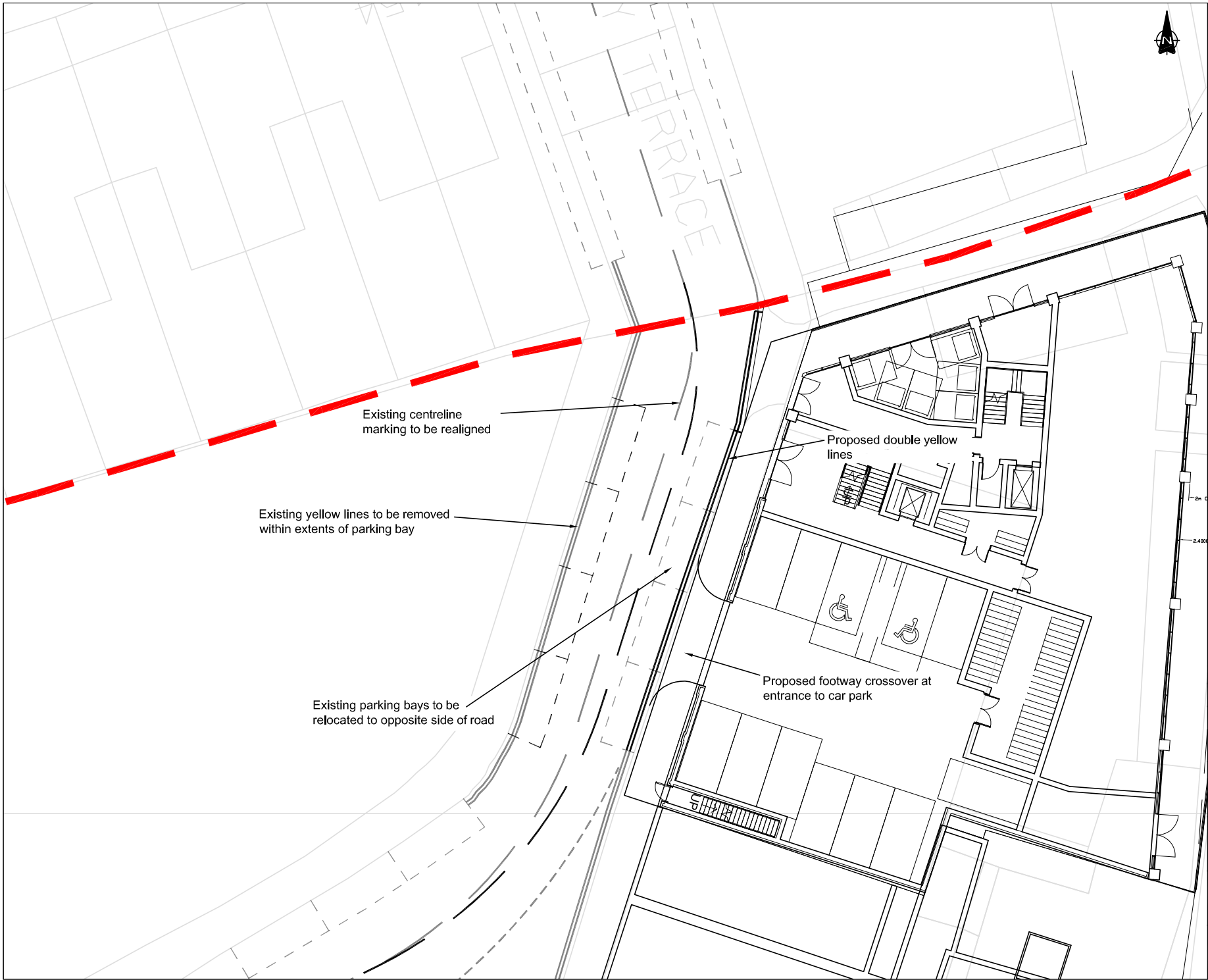

- Key:
- Existing Layout
 - Proposed Layout
 - Wandsworth/Merton Borough Boundary

Rev.	Date	Revision details	Drawn	Checked	Approved

© This drawing is the property of JMP Consultants Limited and the information can only be reproduced with their prior permission.

JMP 27-52 Old Jewry
London
EC2R 8DQ
T 020 3714 4400
E london@jmp.co.uk
W www.jmp.co.uk

Client
James Lawrence Group

Project
Land at Ravensbury Terrace Merton

Title
Existing and Proposed Layout

Drawn RM	Checked KR	Approved PWJ
Original dwp. size A3	Date 10/09/2015	Scale 1:200
Drawing Status PRELIMINARY	Drawing Number ST16108-10	Rev. -