



**LONDON BOROUGH OF MERTON**

**PROPOSED CYCLE TRACK AND WAITING RESTRICTIONS IN BISHOPSFORD ROAD AND LONDON ROAD**  
**PROPOSED RAISED TABLE AND WAITING RESTRICTIONS IN RIVERSIDE DRIVE**

**THE MERTON (WAITING AND LOADING RESTRICTION) (AMENDMENT NO. \*) ORDER 202\***

1. NOTICE IS HEREBY GIVEN that the Council of the London Borough of Merton under the powers conferred by sections 6 and 124 of, and Part IV of Schedule 9 to, the Road Traffic Regulation Act 1984, as amended, propose to make the above-mentioned Order.
2. The general effect of the Order would be to further amend the Merton (Waiting and Loading Restriction) Order 1977 so that waiting by vehicles (including for the purpose of delivering or collecting goods or loading or unloading a vehicle) would be prohibited at any time in the lengths of streets specified in the Schedule to this notice.
3. NOTICE IS ALSO HEREBY GIVEN that the Council, using powers under section 65 of the Highways Act 1980 propose to convert carriageway and footway in the lengths of Bishopsford Road and London Road specified in the Schedule to this notice to with-flow cycle tracks, stepped at a height of between 50mm and 75mm but flush with the carriageway at crossovers and junctions.
4. NOTICE IS ALSO HEREBY GIVEN that the Council, under section 90A-F of the Highways Act 1980, propose to introduce a raised table in Riverside Drive. The raised table would be flush with the footways on either side and extend from the eastern kerb-line of London Road eastward for a distance of 7.5 metres with a 1:20 gradient on either side of the table.
5. A copy of the proposed Order and other documents giving more detailed particulars of the Order, including a plan which indicates the lengths of road to which the Order relates and details of the raised table and cycle track can be inspected during the Council's normal office hours on Mondays to Fridays inclusive at Merton Link, Merton Civic Centre, London Road, Morden. Documents are also available for viewing at <https://www.merton.gov.uk/streets-parking-transport/traffic-management/consultations>.
6. Any person desiring to make representations or to object to the proposed Order, the proposed raised table or the proposed cycle track should send a statement in writing of their representations or objections and the grounds thereof, to the Environment and Regeneration Department, Merton Civic Centre, London Road, Morden, Surrey, SM4 5DX or alternatively by email to [trafficandhighways@merton.gov.uk](mailto:trafficandhighways@merton.gov.uk) quoting the reference **ES/LONDONROADCYCLETRACK** no later than 20 August 2021.

Dated 29 July 2021.

Paul McGarry  
Head of futureMerton  
London Borough of Merton  
Merton Civic Centre  
London Road  
Morden SM4 5DX

**SCHEDULE**

London Road,

- (a) the west side, between its junction with Bishopsford Road and its junction with Rawnsley Avenue;
- (b) the east side, between its junction with Bishopsford Road and the common boundary of Nos. 415a and 415b London Road;

Bishopsford Road

- (a) the west side, from a point 6 metres north of the common boundary of Ravensbury Court and the Esso petrol station to its junction with London Road;
- (b) the east side, from the northern kerb-line of the entrance to the Imperial Sports Ground to its junction with London Road

Riverside Drive, from the eastern kerb-line of London Road eastward for a distance of 7.5 metres.



## LONDON BOROUGH OF MERTON

### TRAFFIC MANAGEMENT ORDER

202\* No. \*

---

The Merton (Waiting and Loading Restriction) (Amendment No. \*) Order 202\*

Made: \* 202\*

Coming into force: \* 202\*

---

The Council of the London Borough of Merton, after consulting the Commissioner of Police of the Metropolis, in exercise of the powers conferred under sections 6 and 124 of, and Part IV of Schedule 9 to, the Road Traffic Regulation Act 1984(a), as amended by Section 8 of and Part 1 of Schedule 5 to the Local Government Act 1985(b), and of all other powers thereunto enabling, hereby make the following Order:-

1. This Order shall come into operation on \* 202\* may be cited as the Merton (Waiting and Loading Restriction) (Amendment No. \*) Order 202\*.
2. Without prejudice to the validity of anything done or to any liability incurred in respect of any act or omission before the coming into operation of this Order:- the provisions of Schedule 1 and 2 of the Merton (Waiting and Loading Restriction) Order 1977(c) are hereby revoked in so far as its provisions relate to any length of road specified in the Schedules to this Order.
3. Without prejudice to the validity of anything done or to any liability incurred in respect of any act or omission before the coming into operation of this Order, the Merton (Waiting and Loading Restriction) Order 1977(c) shall have effect as though:-
  - (a) for item numbered 166 in Schedule 1 to that Order there were substituted the item similarly numbered and set out in columns 1, 2 and 3 of Schedule 1 to this Order;
  - (b) there were added to Schedule 1 to that Order the item numbered \* and set out in columns 1, 2 and 3 of Schedule 1 to this Order;
  - (c) for items numbered 44 and 575 in Schedule 2 to that Order there were substituted the items similarly numbered and set out in columns 1, 2 and 3 of Schedule 2 to this Order;
  - (d) there were added to Schedule 2 to that Order the item numbered \* and set out in columns 1, 2 and 3 of Schedule 2 to this Order.

---

(a) 1984 c.27    (b) 1985 c.51    (c) G.L.C. 1977/107 – as amended

Dated this \* day of \* 202\*.

PAUL MCGARRY  
Head of futureMerton  
London Borough of Merton

## SCHEDULE 1

### [Restricted streets referred to in Article 5(1)]

1. Item No.	2. Street/Description	3. Prescribed hours
166.	<p>LONDON ROAD</p> <p>(a) the east and south-east sides,</p> <p>(i) from its junction with Bishopsford Road to a point 10 metres north of the northern kerb-line of Mitcham Park;</p> <p>(ii) from a point 10 metres north of the northern kerb-line of Mitcham Park to a point 10 metres south of the south-western kerb-line of Linden Place;</p> <p>(iii) from a point 10 metres south of the south-western kerb-line of Linden Place to a point 10 metres north of the north-eastern kerb-line of Linden Place;</p> <p>(iv) from a point 10 metres north of the north-eastern kerb-line of Linden Place to a point 10 metres south-west of the south-western kerb-line of Baron Grove;</p> <p>(v) from a point 10 metres south-west of the south-western kerb-line of Baron Grove to a point 10 metres north-east of the north-eastern kerb-line of Baron Grove;</p> <p>(vi) from a point 10 metres north-east of the north-eastern kerb-line of Baron Grove to a point 24.6 metres south-west of the south-western kerb-line of Elmwood Road;</p> <p>(vii) from a point 24.6 metres south-west of the south-western kerb-line of Elmwood Road, north-eastward to a point 10 metres north-east of the north-eastern kerb-line of Elmwood Road;</p> <p>(viii) from a point 10 metres north-east of its junction with Elmwood Road to a point opposite the party wall of the telephone exchange and nos. 263/265 London Road;</p> <p>(ix) from the party wall of the telephone exchange and Nos. 263/265 London Road, northward to a point 5 metres north of the southern flank wall of No. 191 London Road;</p> <p>(x) from a point 5 metres north of the southern flank wall of No. 191 London Road to a point opposite the southern kerb-line of Bond Road;</p> <p>(xi) between the southern kerb-line of Bond Road and a point 9.5 metres north of the north-eastern kerb-line of Gorringer Park Avenue;</p> <p>(xii) from a point 9.5 metres north of the north-eastern kerb-line of Gorringer Park Avenue northward to a point 6 metres south of the southern kerb-line of Inglemere Road;</p> <p>(xiii) from a point 6 metres south of the southern kerb-line of Inglemere Road to a point 10 metres north of the northern kerb-line of Inglemere Road;</p> <p>(xiv) from a point 10 metres north of the northern kerb-line of</p>	<p>A</p> <p>S</p> <p>A</p> <p>S</p> <p>A</p> <p>S</p> <p>A</p> <p>S</p> <p>A</p> <p>S</p> <p>A</p> <p>S</p> <p>A</p> <p>S</p>

1. Item No.	2. Street/Description	3. Prescribed hours
	<p>Inglemere Road to a point 10 metres south of the southern kerb-line of Grenfell Road;</p> <p>(xv) from a point 10 metres south of the southern kerb-line of Grenfell Road to a point 10 metres north of the northern kerb-line of Grenfell Road;</p> <p>(xvi) from a point 10 metres north of the northern kerb-line of Grenfell Road to a point 10 metres south of the southern kerb-line of Links Road;</p> <p>(xvii) from a point 10 metres south of the southern kerb-line of Links Road to a point 10 metres north of the northern kerb-line of Links Road;</p> <p>(xviii) from a point 10 metres north of the northern kerb-line of Links Road to the borough boundary with the London Borough of Wandsworth;</p>	<p>A</p> <p>S</p> <p>A</p> <p>A</p>
	<p>(b) the west and north-west sides,</p> <p>(i) from its junction with Bishopsford Road to a point 12 metres north of the northern kerb-line of Rawnsley Avenue;</p> <p>(ii) from a point 12 metres north of the northern kerb-line of Rawnsley Avenue northward to point 25 metres north-east of the north-western kerb-line of Lower Green West, the northern arm;</p> <p>(iii) from a point 25 metres north-east of the north-western kerb-line of Lower Green West, the northern arm to a point 28 metres south-west of the south-western kerb-line of Chatsworth Place;</p> <p>(iv) from a point 28 metres south-west of the south-western kerb-line of Chatsworth Place to a point 9.5 metres south-west of its junction with the unnamed service road leading to Deserete House;</p> <p>(v) from a point 9.5 metres south-west of its junction with unnamed service road leading to Deserete House northward to a point 5 metres north of the southern flank wall of No. 191 London Road;</p> <p>(vi) from the northern kerb-line of Bond Road to the southern kerb-line of Victoria Road;</p> <p>(vii) from the northern kerb-line of Victoria Road to a point 10 metres south of the southern kerb-line of Swains Road;</p> <p>(viii) from a point 10 metres south of the southern kerb-line of Swains Road to a point 9 metres north of the northern kerb-line of Swains Road;</p> <p>(ix) from a point 9 metres north of the northern kerb-line of Swains Road to the southern kerb-line of Arnold Road;</p> <p>(x) from the northern kerb-line of Arnold Road northward for a distance of 15 metres;</p> <p>(xi) from a point 15 metres north of the northern kerb-line of Arnold Road to a point 12 metres south of the southern</p>	<p>A</p> <p>S</p> <p>A</p> <p>S</p> <p>A</p> <p>A</p> <p>S</p> <p>A</p> <p>S</p> <p>A</p> <p>OO</p>

1. Item No.	2. Street/Description	3. Prescribed hours
	kerb-line of Finborough Road; (xii) from the southern kerb-line of Finborough Road southward for 12 metres; (xiii) from the northern kerb-line of Finborough Road northward to the borough boundary with the London Borough of Wandsworth.	A  S
*	BISHOPSFORD ROAD, (a) the west side, from its junction with London Road southward to a point 6 metres north of the common boundary of Ravensbury Court and the Esso petrol station; (b) the east side, from the northern kerb-line of the entrance to the Imperial Sports Ground.	A  A

## SCHEDULE 2

### [Restricted streets referred to in Article 5(2)(a)]

1. Item No.	2. Street/Description	3. Restricted hours
44.	<p>LONDON ROAD</p> <p>(a) the south-east side,</p> <p>(i) from its junction with Bishopsford Road to the southern kerb-line of Tramway Path;</p> <p>(ii) from the northern kerb-line of Tramway Path to a point 24.6 metres south-west of the south-western kerb-line of Elmwood Road;</p> <p>(iii) from a point 24.6 metres south-west of the south-western kerb-line of Elmwood Road, north-eastward to a point 10 metres north-east of the north-eastern kerb-line of Elmwood Road;</p> <p>(iv) from a point 10 metres north-east of its junction with Elmwood Road to a point opposite the party wall of the telephone exchange and Nos. 263/265 London Road;</p> <p>(v) from the party wall of the telephone exchange and Nos. 263/265 London Road, northward to a point 5 metres north of the southern flank wall of No. 191 London Road;</p> <p>(vi) from a point 5 metres north of the southern flank wall of No. 191 London Road northward to the southern kerb-line of Bond Road;</p> <p>(vii) between the southern kerb-line of Bond Road and a point 9.5 metres north of the north-eastern kerb-line of Gorrington Park Avenue;</p> <p>(viii) from a point 9.5 metres north of the north-eastern kerb-line of Gorrington Park Avenue northward to the borough boundary with the London Borough of Wandsworth;</p> <p>(b) the north-west side,</p> <p>(i) from its junction with Bishopsford Road to a point 10 metres north of the northern kerb-line of Rawnsley Avenue;</p> <p>(ii) from a point 9.5 metres north of the northern kerb-line of Rawnsley Avenue northward to point 40 metres south of the southern kerb-line of Morden Road</p> <p>(iii) from a point 40 metres south of the southern kerb-line of Morden Road to a point 15 metres south-west of the south-western kerb-line of Baron Grove;</p> <p>(iv) from a point 15 metres south-west of the south-western kerb-line of Baron Grove north-eastward for a point 10 metres south-west of the northern flank wall of No. 323 London Road, Mitcham;</p>	<p>1</p> <p>20</p> <p>1</p> <p>39</p> <p>1</p> <p>39</p> <p>1</p> <p>39</p> <p>1</p> <p>39</p> <p>1</p> <p>39</p> <p>20</p> <p>19</p>

1. Item No.	2. Street/Description	3. Restricted hours
	<ul style="list-style-type: none"> <li>(v) from a point 10 metres south-west of the northern flank wall of No. 323 London Road, Mitcham to a point 9.5 metres south-west of its junction with the unnamed service road leading to Deserete House;</li> <li>(vi) from a point 9.5 metres south-west of its junction with the unnamed service road leading to Deserete House northward to a point 5 metres north of the southern flank wall of No. 191 London Road;</li> <li>(vii) from to a point 5 metres north of the southern flank wall of No. 191 London Road to the southern kerb-line of Bond Road;</li> <li>(viii) from the northern kerb-line of Bond Road to the southern kerb-line of Victoria Road;</li> <li>(ix) from the northern kerb-line of Victoria Road to southern kerb-line of Arnold Road;</li> <li>(x) from the northern kerb-line of Arnold Road northward for a distance of 15 metres;</li> <li>(xi) from a point 15 metres north of the northern kerb-line of Arnold Road to a point 12 metres south of the southern kerb-line of Finborough Road;</li> <li>(xii) from the southern kerb-line of Finborough Road southward for 12 metres;</li> <li>(xiii) from the northern kerb-line of Finborough Road northward to the borough boundary with the London Borough of Wandsworth.</li> </ul>	<p>20</p> <p>1</p> <p>39</p> <p>1</p> <p>39</p> <p>1</p> <p>39</p> <p>1</p> <p>39</p>
575	<p>RIVERSIDE DRIVE</p> <ul style="list-style-type: none"> <li>(a) both sides, <ul style="list-style-type: none"> <li>(i) From the eastern kerb-line of London Road eastward for a distance of 7 metres;</li> <li>(ii) from a point 7 metres east of the eastern kerb-line of London Road eastward to a point 18.29 metres east of that kerb-line.</li> </ul> </li> </ul>	<p>1</p> <p>20</p>
*	<p>BISHOPSFORD ROAD,</p> <ul style="list-style-type: none"> <li>(a) the west side, from its junction with London Road southward to a point 6 metres north of the common boundary of Ravensbury Court and the Esso petrol station;</li> <li>(b) the east side, from the northern kerb-line of the entrance to the Imperial Sports Ground.</li> </ul>	<p>1</p> <p>1</p>



**LONDON BOROUGH OF MERTON**

**Statement of Reasons**

**PROPOSED WAITING AND LOADING RESTRICTIONS**

**THE MERTON (WAITING AND LOADING RESTRICTION) (AMENDMENT NO. \*) ORDER**  
**202\***

The above Order is considered necessary to improve safety and prevent obstructive parking in Bishopsford Road and London Road.

# The Beeches

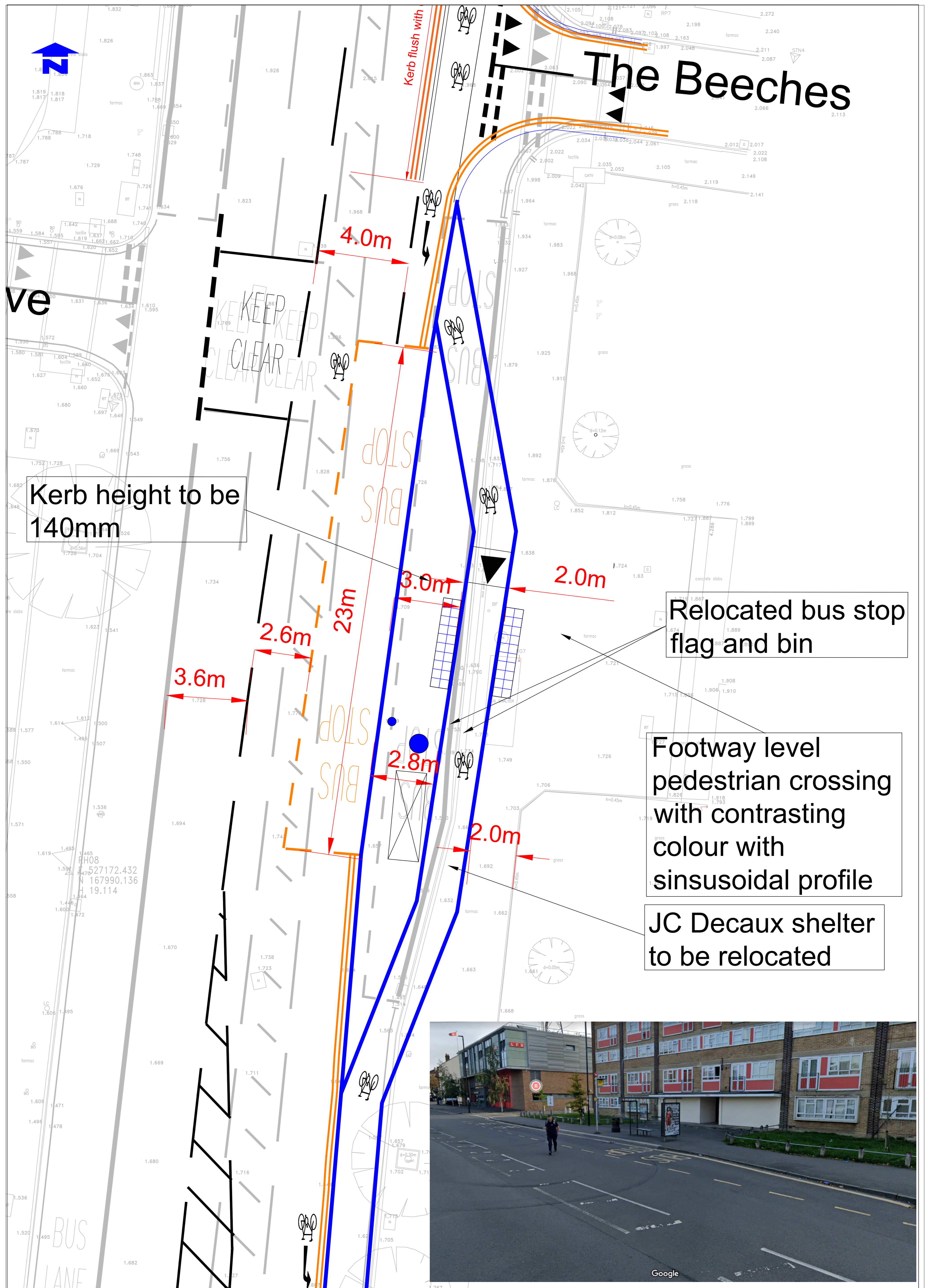

Kerb height to be 140mm

Relocated bus stop flag and bin

Footway level pedestrian crossing with contrasting colour with sinusoidal profile

JC Decaux shelter to be relocated



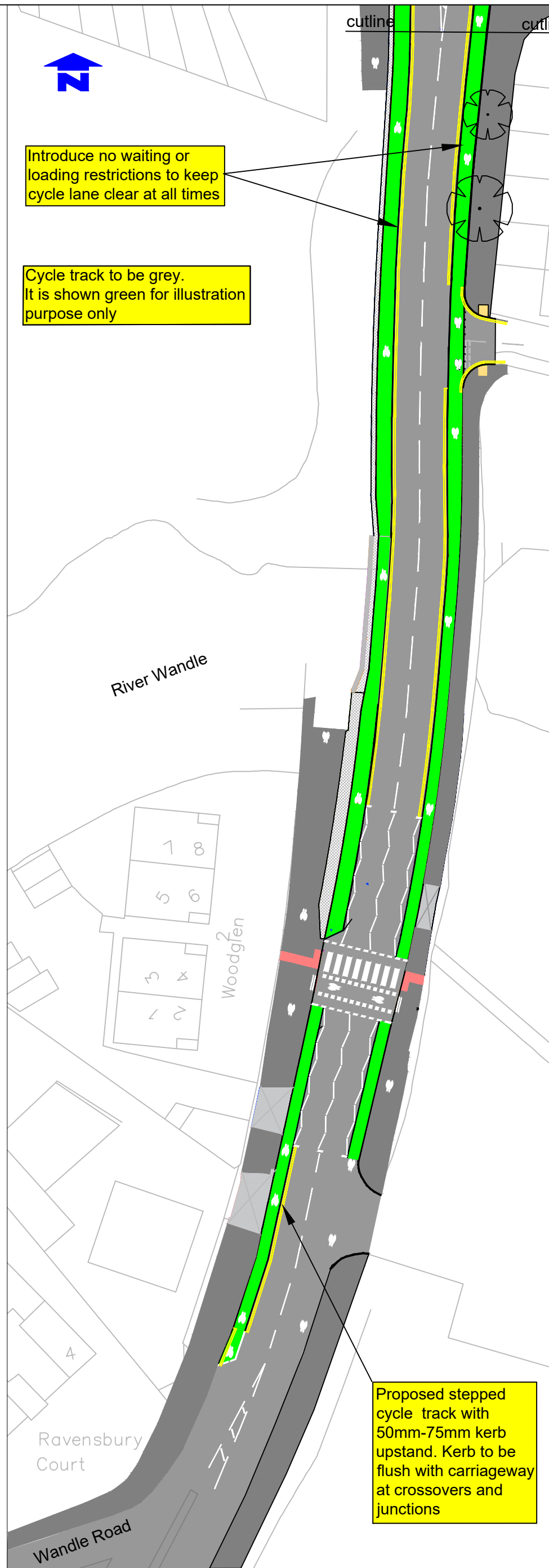
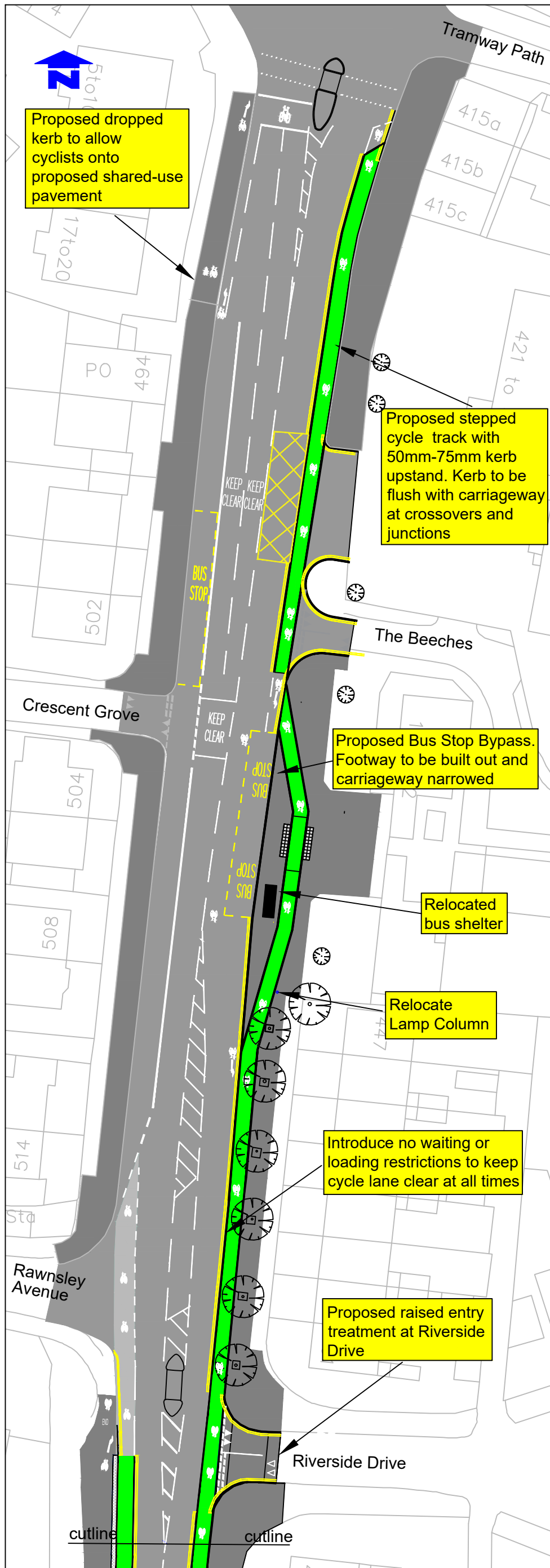

Notes

Rev	Date	Revisions	Drawn	Sig	Date	Checkd	Sig	Date	Appr	Sig	Date

environment & regeneration

Reproduced from the Ordnance Survey's 1:25000 map with the permission of the Controller of Her Majesty's Stationery Office.

Drawn by: [ ] Date: [ ]  
 Checked by: [ ] Date: [ ]  
 Approved by: [ ] Date: [ ]

PROJECT: LONDON ROAD  
 SEGREGATED CYCLE LANE  
 TITLE: GENERAL LAYOUT

Merton Civic Centre  
 London Road  
 Morden, Surrey  
 SM4 5DX  
 www.merton.gov.uk

Drawing No: GA1  
 Revision: -  
 Classification: INFORMATION  
 Scale: NTS