

However, it is important to note that the Council has just completed a statutory consultation on making a number of changes to parking charges throughout the borough including the permit tariff structure. Although you are being consulted on the existing permit prices, should the proposed parking charges be implemented, you would need to pay the new charges upon the renewal of your permits. The information can be found on the Council's website using the following links. www.merton.gov.uk/parkingconsultation2019

YOUR VIEWS COUNT

The decision on whether or not to proceed with the next step, which would be a statutory consultation on the proposals, will depend on the number and content of the responses received during this consultation. We would ask that you submit your questionnaire online using this link www.merton.gov.uk/cpzw2review

As part of this review consultation, we would also like to take the opportunity to ask you if you have any other suggestions as to how you consider the W2 CPZ could be amended to improve road safety and better benefit you as residents.

The online system has been created to keep costs down and allow the Council to process your views more efficiently. If, however, you require a hard copy, please contact Paul Atie, paul.atie@merton.gov.uk and one will be posted to you. Please let us have any comments or suggestions you may have by **7 June 2019** and it is only one vote per household or business.

We regret that due to the number of responses received during an informal consultation, it will not be possible to individually reply to each respondent. We welcome your comments on this proposal, which will be noted and included within

the proposed measures where appropriate.

WHAT HAPPENS NEXT

The results of the consultation along with officers' recommendations will be presented in a report to the Cabinet Member for Regeneration, Housing and Transport. Once a decision is made you will be informed accordingly. The website will also be updated.

HILLSIDE WARD COUNCILLORS

Cllr Daniel Holden

phone: 020 36385394

Email: daniel.holden@merton.gov.uk

Cllr David Simpson

Phone: 020 85433764

Email: david.simpson@merton.gov.uk

Cllr David Williams

Phone: 020 89478835

Email: david.williams@merton.gov.uk

Cabinet Member for Regeneration, Transport and Housing.

Cllr Martin Whelton

Phone: 020 8545 3425

Email: martin.whelton@merton.gov.uk

(The contact details of Ward Councillors are provided for information purposes only)

Controlled Parking Zone (CPZ)

Zone W2 review - Compton Road area



ISSUE DATE : 16 MAY 2019

Dear Resident / Business

You may remember that the Council conducted an informal consultation in June 2017 on proposals to extend the existing days and hours of operation of your parking zone. However, due to the poor response rate and lack of overall support the proposals did not go ahead. Since then the Council, the Cabinet Member and ward Councillors have received a number of communications from Compton Road, Alwyne Road and Worcester Road, asking for a fresh consultation to be carried out.

As a result, the purpose of this leaflet is to seek your views on proposals to extend the operational hours of W2 CPZ, currently Monday to Saturday between 8.30am and 6.30pm to between 8.30am and 11pm and also to include Sunday between 2pm and 6pm or 10am and 4pm.

There are several potential outcomes of this consultation; these include:-

1. Amendment to the boundary of zone - there may be a possibility of splitting the zone into two with different parking restrictions. One zone to include Brockham Close, Lake Road, Lake Close, Leeward Gardens, Pine Grove, St Mary's Road, Woodside between 38 and 60, and a second zone to include Worcester Road, Compton Road, Alwyne Road, Woodside between 62 and Wimbledon Hill Road and Alexandra Rd.
2. Retention of the status quo e.g. no change to operational days/hours or zone boundary
3. A change in the operational hours and days of the whole controlled zone

Regardless of the outcome, the Council will progress the introduction of new and additional parking spaces where it is safe and convenient as indicated on the plan. We will also recommend the introduction of the proposed double yellow lines where it is considered essential to maintain access at all times.

It is also proposed to convert some of the existing permit holders bays in Compton Road, Alwyne Road and Worcester Road to Resident permit holder only bays. Business permits will **not** be valid in those parking spaces.

A plan of the proposal is enclosed. Due to the scale it may be preferable to view this from the website www.merton.gov.uk/cpzw2review

Operational hours

- If the CPZ hours are extended to Monday to Saturday 8.30am – 11pm and Sunday 2pm – 6pm, it will offer maximum protection against both short and long term parking from non residents; however, the scheme will inevitably be less flexible for both you and your visitors who will need to display a visitor parking permit.
- If the CPZ hours are extended and you have a supply of existing W2 CPZ half-day visitor permits (valid 8.30am – 2pm or 12pm – 6.30pm) they will remain valid.

Permit costs

Currently the standard annual parking permit charges apply regardless of the operational hours and days of the zone.

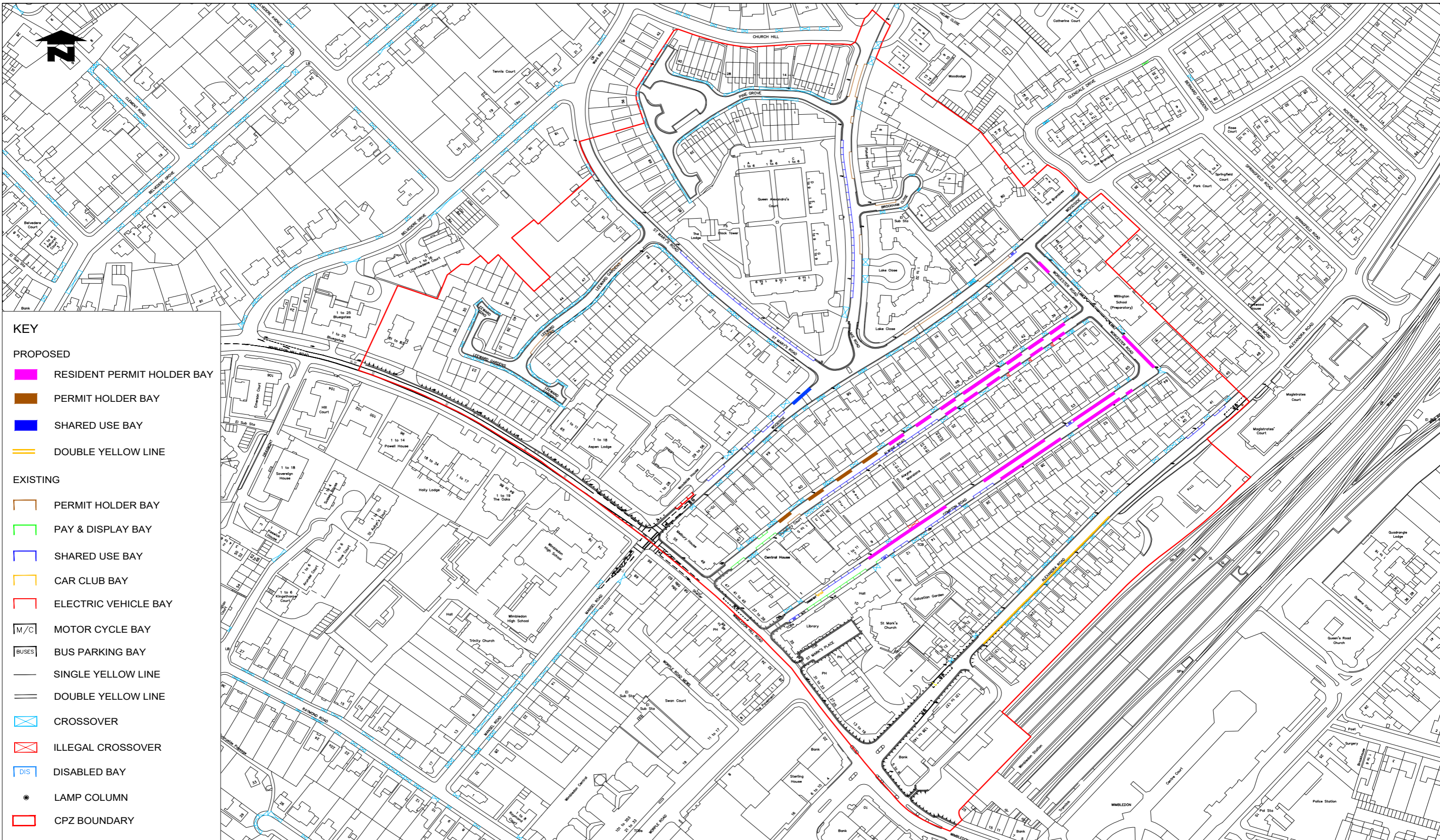

Notes
Do not scale from this drawing

Rev	Revisions	Drawn	Sig.	Date	Chkd.	Sig.	Date	App.	Sig.	Date

Street Scene & Waste
 environment & regeneration
TRAFFIC & HIGHWAYS

Reproduced from/based upon the Ordnance Survey's 1:1250 maps with the permission of the Controller of H.M.S.O., Crown Copyright Reserved. Unauthorized reproduction infringes Crown copyright and may lead to prosecution or civil proceedings. London Borough of Merton 100019259 2017

Drawn by	Sig.	Date
SC		Apr' 17
Checked by	Sig.	Date
Approved by	Sig.	Date

PROJECT CONTROLLED PARKING ZONES	 Merton Civic Centre London Road Morden, Surrey SM4 5DX www.merton.gov.uk	Drawing No. Z78-361-01 Revision - Classification CONSULTATION Scale NTS
TITLE W2 ZONE REVIEW SCHEME LAYOUT	A1	