

newspaper (The Guardian), London Gazette and posted on lamp columns in the vicinity. Representations against the proposals described in this Notice must be made in writing or email to trafficandhighways@merton.gov.uk by no later than **31 May 2017** quoting reference **ES/CH**. Objections must relate only to the elements of the scheme that are subject to this statutory consultation.

A copy of the proposed Traffic Management Orders (TMOs), a plan identifying the areas affected by the proposals and the Council's Statement of Reasons can be inspected at Merton Link, Merton Civic Centre, London Road, Morden, Surrey, SM4 5DX during the Council's normal office hours Monday to Friday, 9am to 5pm or at Raynes Park Library. This information is also available on Merton Council's website www.merton.gov.uk/cpzch

All representations along with Officers' comments and recommendations will be presented in a report to the Cabinet Member for Regeneration, Environment and Housing. **Please note that responses to any representations received will not be made until a final decision is made by the Cabinet Member.**

The Council is required to give weight to the nature and content of your representations and not necessarily the quantity. Your reasons are, therefore, important to us.

Further information on how CPZs work, details of permit costs can be found in our Frequently Asked Questions (FAQ's) at www.merton.gov.uk/cpzch

The Council is currently carrying out a statutory consultation on making a number of changes to parking charges throughout the borough including the permit tariff structure. Although the residents have been consulted on the existing permit prices, should the proposed parking charges be implemented, residents would need to pay the new

charges upon the renewal of their permits. The information can be found on the Council's website using the following links.

- www.merton.gov.uk/parkingconsultation2019

CANNON HILL WARD COUNCILLORS

Cllr Pauline Cowper
Phone - 020 8545 3425
Email: pauline.cowper@merton.gov.uk

Cllr Mark Kenny
Phone - 07810 275 076
Email: mark.kenny@merton.gov.uk

Cllr Nick McLean
Phone - 07497 088 970
Email: nick.mclean@merton.gov.uk

Cabinet Member for Regeneration, Housing and Transport.

Cllr Martin Whelton
Phone: 020 8545 3425
Email: martin.whelton@merton.gov.uk

(The contact details of Ward Councillors are provided for information purposes only)

Proposed Controlled Parking Zone (CPZ) CH - Mossville Avenue Area



ISSUE DATE : 09 MAY 2019

Dear Resident/Business

The purpose of this leaflet is to let you know the outcome of the informal consultation carried out out between 18th January and 8th February 2019 on the proposals to introduce a CPZ 'CH' to include Arundel Avenue, Ashridge Way, Hillcross Avenue, Leamington Avenue, Maycross Avenue, Monkleigh Road, Mossville Gardens, Northernhay Walk, Sheldon Drive, Westcroft Gardens and Woodland Way.

CH CPZ CONSULTATION RESULTS

The consultation resulted in a total of 393 questionnaires returned (after removing duplicates/multiple returns from households, staff and members of businesses), representing a response rate of 42%.

Of the 393 who responded, the majority of roads within the consulted area do not support the proposed scheme; only 3 roads, Arundel Avenue, Mossville Gardens and Woodland Way have demonstrated majority support

Taking the responses to the question "would you support parking controls if neighbouring roads did?" It is also acknowledged that Maycross Avenue has considered the impact of displacement and the majority view shifts in support of parking controls. This indicates majority in favour of parking controls from Arundel Avenue, Maycross Avenue, Mossville Gardens and Woodland Way with all other roads with a majority against the proposed parking controls.

Further analysis of the responses from Arundel Avenue, Maycross Avenue, Mossville Gardens and Woodland Way, the results for the preferred days of operation of the proposed CPZ scheme show 85% of respondents prefer Monday – Friday,

14% prefer Monday – Saturday and 1% unsure or no response.

Residents were also asked which hours of operation they would prefer should the CPZ be introduced in their road. 48% of respondents prefer 11am – 3pm, 30% prefer 8.30am – 6.30pm, 20% 10am – 4pm and 2% unsure or no reply.

The results of the consultation along with officers' recommendation were presented in a report to the Cabinet Member for Regeneration, Transport and Housing on the 3 April 2019. The report and the decision sheet can be viewed on our website. www.merton.gov.uk/cpzch. The following recommendations which were made to the Cabinet Member have now been agreed:

- to proceed with a statutory consultation to include Arundel Avenue, Maycross Avenue, Mossville Gardens and Woodland Way into the proposed CH CPZ, operational Monday to Friday between 11am and 3pm.
- to proceed with a statutory consultation to include the section of Leamington Avenue between, odd nos. 1 – 37 and even nos. 2 – 22 into the proposed CH CPZ.
- to proceed with the statutory consultation of the relevant Traffic Management Orders (TMOs) and the implementation of the 'At any time' waiting restrictions.
- to exercise his discretion not to hold a public inquiry on the consultation process.

WHAT HAPPENS NEXT

A Notice of the Council's intention to introduce the above measures will be published in a local

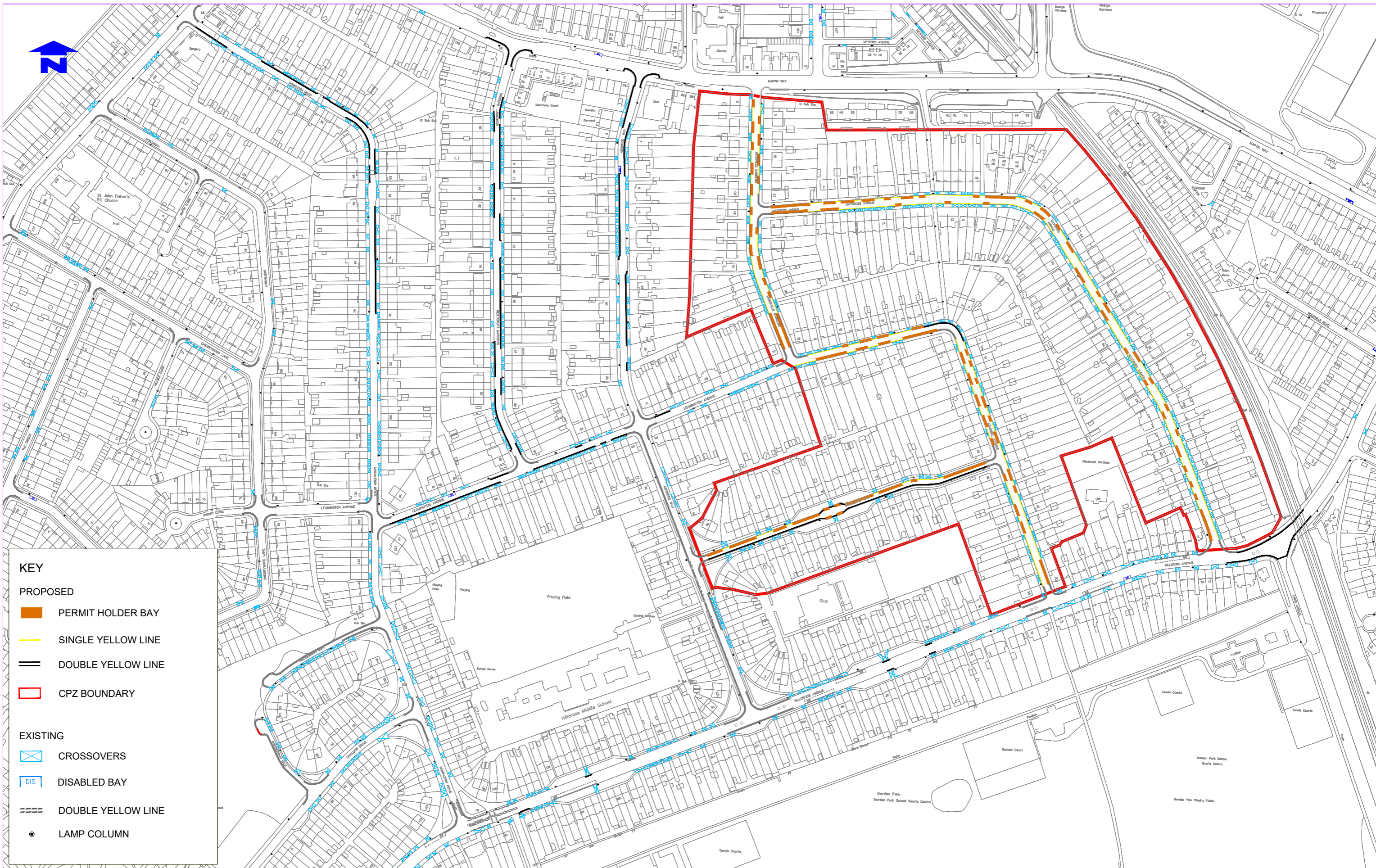

KEY

PROPOSED

- PERMIT HOLDER BAY
- SINGLE YELLOW LINE
- DOUBLE YELLOW LINE
- CPZ BOUNDARY

EXISTING

- CROSSOVERS
- DISABLED BAY
- DOUBLE YELLOW LINE
- LAMP COLUMN

Notes
Do not scale from this drawing

Rev	Revisions	Drawn	Sig.	Date	Chkd.	Sig.	Date	App.	Sig.	Date



Sustainable Communities
environment & regeneration

TRAFFIC & HIGHWAYS

Reproduced from/based upon the Ordnance Survey's 1:1250 maps with the permission of the Controller of H.M.S.O., Crown Copyright Reserved. Unauthorized reproduction infringes Crown copyright c and may lead to prosecution or civil proceedings.
London Borough of Merton 100019259 >>YEAR<<

Drawn by	Sig.	Date
DRW	SIG	DAT_DRW
Checked by	Sig.	Date
CHK	SIG	DAT_CHK
Approved by	Sig.	Date
APP	SIG	DAT_APP

PROJECT
CANNON HILL (CH)
CONTROLLED PARKING ZONE

TITLE
PROPOSED DESIGN LAYOUT
INCLUDING WAITING RESTRICTIONS



merton
Merton Civic Centre
London Road
Morden, Surrey
SM4 5DX
www.merton.gov.uk

Drawing No.
Z78-358-01A

Revision

Classification
CONSULTATION

Scale
NTS