

**Committee:** Cabinet Member Report

**Date:** 27<sup>th</sup> September 2021

**Agenda item:** N/A

**Wards:** Figge's Marsh

**Subject:** Low Traffic Neighbourhood (LTN) – Commonside East/Grove Road/Spencer Rd, Mitcham

**Lead officer:** Chris Lee, Director of Environment & Regeneration.

**Lead member:** Councillor Martin Whelton, Cabinet Member for Housing, Regeneration and the Climate Emergency

**Forward Plan reference number:** N/A

Contact Officer: Mitra Dubet, email: [mitra.dubet@merton.gov.uk](mailto:mitra.dubet@merton.gov.uk)

---

### **Recommendations:**

That the Cabinet Member considers the issues detailed in this report and

- A) Notes the results of the review and the Experimental Traffic Management Order used to the implement the LTN in Commonside East/Grove Road/Spencer Rd aimed at removing rat running, reduce speed of traffic and to encourage safer walking and cycling. Please see plan in Appendix 1.
- B) To consider all the representations received (as set out in appendix 2 and 4) and agrees to proceed with making the LTN permanent by making the permanent Traffic Management Order.
- C) Agrees to exercise his discretion not to hold a public inquiry on the consultation process.

### **1. PURPOSE OF REPORT AND EXECUTIVE SUMMARY**

- 1.1 This report presents the results of the review and the Experimental Traffic Management Order on the implementation of the LTN in Commonside East/Grove Road/Spencer Rd aimed at removing rat running and to create a better environment for the local residents. Please see plan in Appendix 1.
- 1.2 It seeks approval to make the LTN permanent.

## 2. DETAILS

- 2.1 In response to a green recovery, DfT / TfL provided funding (subject to a bid process) to boroughs to consider, consult and implement LTNs on a number of identified routes. These routes were identified by some residents and / or were previously known to be popular rat runs particularly during the peak periods.
- 2.2 A low traffic neighbourhood (LTN) is considered within a residential area, bordered by main roads (places where buses, lorries, non-local traffic should be), where "through" motor vehicle traffic could be discouraged or removed. Strategic road closures (bollards or planters) or banned movements prevent through traffic whilst maintaining access.
- 2.3 As part of the LTN programme, during trench 1 of the funding process, the Council was successful in its bid to DfT/TfL in securing funding to design and implement a LTN on Commonside East/Grove Road/Spencer Rd. However, due to extremely tight deadlines set by TfL/DfT, this LTN was introduced under an Experimental Order. As per legislation, the Council does need to make a decision no later than 18 months of the ETMO coming in to effect.

## 3.0 SCHEME

- 3.1 The scheme was introduced in September 2020 under an Experimental Traffic Management Order (EMTO) which enables the implementation of a scheme during the statutory consultation stage. An Experimental Order allows the restrictions and the Order to be in place for a maximum of 18 months before a final decision is made. Anyone can make a representation within the first six months (the statutory/formal consultation period) of the Experimental Order coming into force.
- 3.2 The EMTO allowed the Council to meet its extremely tight deadlines but more importantly, it enabled the residents and other road users to experience the restrictions, thereby allowing them to make an informed decision prior to responding to the consultation. Consultees had 6 months to respond to the consultation and residents were encouraged to allow sufficient time to experience the scheme before making representations.
- 3.3 The initial road closures included free standing planters, lockable removable bollards for use only by emergency services and non-motorised vehicles. The lockable bollards were subject to routine vandalism by a certain non-resident individual. This stopped when ANPR was introduced.
- 3.2 Although it is normal practice to undertake before and after surveys that can be used for an impact assessment, particularly on the neighbouring roads, due to the pandemic / lock down and a general change in traffic pattern and behavior, any survey at the time would not have yielded a true reflection of *normal* traffic – something that would be required for a meaningful before and after comparison. Notwithstanding this, Tamworth Lane and Grove Road are both local Distributor Roads; both are bus routes and primary emergency routes and therefore all traffic including all local traffic should use these roads rather than attempting to cut through this section of Commonside East.

## 4. CONSULTATION

- 4.1 The consultation on the LTN began on 7<sup>th</sup> September 2020 and concluded in March 2021. Newsletters were delivered to 334 properties within the catchment area (see plan in appendix 5). The newsletters detailed the consultation process; the proposed measures and a location plan. A copy of the newsletter with the plan for each LTN is attached in Appendix 1.

- 4.2 Residents were encouraged to submit their feedback on the Council's website using specific on-line feedback links; however, it appears that many made their representation shortly after the implementation of the scheme which did not allow them sufficient time to experience the improvement. All available information was also posted on the website. <https://www.merton.gov.uk/covid-19-transport-projects>. Street notices were erected on lamp columns and published in the local papers and the London Gazette.
- 4.3 After removing blanks and those without an address and combining multiple entries from the same person, the statutory consultation resulted in a total of 73 representations. There were 36 representations from within the catchment area which represents 10.8% of the consulted catchment area. There are 15 in support the scheme and 21 objections. This means 6.29% of those consulted object to the scheme. There is one additional representation which appears to agree to the scheme but with a negative comment. The majority of objections are based on inconvenience because of increased in journey times; congested traffic on the main roads increasing pollution; concerns for the emergency services. There were 30 objections, 7 support and 1 unsure from outside the consulted area. All responses are detailed in appendix 2.
- 4.4 It is essential to note that when making a decision based on the outcome of a statutory consultation, consideration must be given to the validity of objections rather than the number of objections. Additionally, although the on-line feedback link did ask views in terms of level of agreement and disagreement with regards to the scheme, within a statutory consultation, objections are invited and should be given due consideration. Although an assumption cannot be made in terms of level of support from many who did not participate within the consultation, a low response rate could be considered that majority do not object to the scheme. In this case, during the statutory consultation, 6.29% of consultees objected to the scheme.
- 4.5 All statutory bodies were consulted. Emergency Services did raise concerns regarding the use of lockable bollards that would impact their response time. At the time, funding was not available for ANPR camera enforcement; however, due to ongoing concerns raised by the Emergency services across London where many local authorities were also implementing LTNs, TfL / DfT agreed to provide the funding required for ANPR cameras. The use of an ANPR camera simply means a change in nature of enforcement which facilitates concerns and objections from Emergency services. Following a successful bid for additional funding, the Council was able to secure the necessary ANPR cameras which were installed. This addressed the objections and concerns raised by the Emergency services and some of the residents. The objections based on emergency access as raised by some residents can therefore be considered as addressed and thereby overruled. Those objections regarding mopeds in contravention of the LTN can also be overruled as this is also enforced by ANPR cameras.
- 4.6 Following the completion of the statutory consultation in March 2021, during June / July 2021 the Council carried out a further engagement with the residents via a questionnaire. In June 2021 a newsletter was delivered to all the properties within the catchment area and residents were asked to complete a simple on line questionnaire. Hard copies were also made available upon request. A copy of the newsletter is attached in appendix 3.
- 4.7 After removing blanks, multiple entries and those without an address, the outcome of the review / questionnaire resulted in a total of 72. There were 58 from within the catchment area representing a response rate of 17% of which 23 support the scheme, one unsure and 34 against. The majority of objections are based on inconvenience because of increased in journey times; congested traffic on the main roads increasing pollution; concerns for the emergency services. All responses are detailed in appendix 4.

4.7.1 As already mentioned, the outcome of this type of consultation is based on comments i.e. the reasons for resident's objections. Although the majority of those who responded do not support the scheme, after a closer analysis of the comments, it is clear that many consider the inconvenience of a longer journey is not acceptable and despite the fact that the posts have been removed, some residents continue to consider the LTN as a hinder to emergency access.

4.8 The local Ward Councillors have been engaged during the consultation process. The results of the consultation and officer's recommendations were presented to the Ward Councillors prior to preparing this report.

## **5. OFFICER'S RECOMMENDATION**

5.1 When considering the outcome of the statutory consultation and the review feedback, consideration must be given to the nature and validity of the comments / representations and the Council's objectives. Given the extremely low response rate during both the statutory consultation and the review and the nature and contents of the comments received vs the overall benefits, it is recommended that the LTN is made permanent. It is considered that the benefits outweigh some of the inconvenience some residents may experience. This scheme is in line with other policies and initiatives across the borough and London which is believed to be the right step forward in changing road user behavior as well as the general environmental benefits.

## **6. ALTERNATIVE OPTIONS**

6.1 To remove the LTN will result in an increase in volume of traffic through these roads; an increase in speed and will do nothing to meet the Council's various objectives in terms of improved air quality and environment.

## **7. TIMETABLE**

7.1 A newsletter detailing the results of the consultation and Cabinet Member decision will be distributed to all the consultees soon after a Cabinet Member decision is made and published. The permanent Traffic Management Order will be made and published soon after.

## **8. FINANCIAL RESOURCE AND PROPERTY IMPLICATIONS**

8.1 All the associated costs are covered by the LSP and LiP funding provided by DfT / TfL.

## **9. LEGAL AND STATUTORY IMPLICATIONS**

9.1 The Traffic Management Orders would be made under Section 6 and Section 45 of the Road

Traffic Regulation Act 1984 (as amended). The Council is required by the Local Authorities Traffic Order (Procedure) (England and Wales) Regulations 1996 to give notice of its intention to make a Traffic Order (by publishing a draft traffic order). These regulations also require the Council to consider any representations received as a result of publishing the draft order.

9.2 The Council has discretion as to whether or not to hold a public inquiry before deciding whether or not to make a traffic management order or to modify the published draft order. A public inquiry should be held where it would provide further information, which would assist the Council in reaching a decision.

9.3 The Council's powers to make Traffic Management Orders arise mainly under sections 6, 45, 46, 122 and 124 and schedules 1 and 9 of the RTRA 1984.

## **10 HUMAN RIGHTS & EQUALITIES AND COMMUNITY COHENSION IMPLICATIONS**

- 10.1 The Council carries out careful consultation to ensure that all road users are given a fair opportunity to air their views and express their needs.
- 10.2 Bodies representing motorists, including commuters are included in the statutory consultation required for draft traffic management and similar orders published in the local paper and London Gazette.

## **11. CRIME AND DISORDER IMPLICATIONS**

N/A

## **12. RISK MANAGEMENT IMPLICATIONS**

- 12.1 The risk of not acting in line with the majority feedback could lead to dissatisfaction amongst the objectors.
- 12.2 The risk of not doing anything would be that volume of traffic and speeding traffic will increase; it will not address all the various objectives regarding improved air quality and safer improved environment.

## **13. ENVIRONMENTAL IMPLICATIONS**

- 13.1 The removal of rat running / reducing volume of traffic will ensure a reduced road safety risk; a better environment for residents and vulnerable road users; a reduction in noise and pollution.

## **14. APPENDICES**

- 14.1 The following documents are to be published with this report and form part of the report.

Appendix 1	- Newsletter and plan – statutory consultation September 2020
Appendix 2	- Representations to statutory consultation September 2020 - March 2021
Appendix 3	- Newsletter- Review June / July 2021
Appendix 4	- Representations to Review questionnaire June /July 2021
Appendix 5	- Consultation area plan



Traffic & Highway Services London  
Borough of Merton  
Merton Civic Centre  
London Road  
Morden SM4 5DX

*Direct Line:* 020 8545 3054  
*Fax:* 020 8545 3038  
*Our Ref:* LTN-Commonside East  
*Date:* 27 August 2020

## COVID-19 - LOW TRAFFIC NEIGHBOURHOODS (LTN) COMMONSIDE EAST NEAR ITS JUNCTION WITH SPENCER ROAD EXPERIMENTAL ROAD CLOSURE

### Proposed Road Closure

As part of Merton's response in maintaining social distancing, removing rat running and to encourage safe walking and cycling, we will be introducing a temporary road closure on Commonside East near its junction with Spencer Road. The proposal will include free standing planters, lockable removable bollards for use only by the emergency services and authorised vehicles..

### Consultation process

The proposed measure is being introduced under an Experimental Traffic Management Order:

- This allows the Council to implement the restrictions during the consultation period.
- It allows the Council to assess and monitor the restrictions and its impact.
- It will enable the residents and other road users to experience the restrictions, thereby allowing them to make informed comments.
- 

The restrictions and the Order will be in place for a maximum of **18 months**. Anyone can object and make representations within the first six months (the statutory/formal consultation period) of the experimental Order coming into force and the implementation of the works. Consultees (mainly residents) are encouraged to make their comments at least 3 months after implementation. Consultees will have 6 months to respond to the consultation. All representations will be considered prior to making a final decision which could include its removal, making any necessary modifications or making it permanent.

Street notices will also be erected within the vicinity of the proposals to inform residents and road users of the start of the restrictions and the statutory consultation.

All available information including updates will be posted on the website. All representations must be made on line using the following link. Please note that you may not be able to submit any comments until end of September 2020

<https://www.merton.gov.uk/covid-19-transport-projects>

A response **will not** be made until the consultation is concluded and a final decision is made. The Council will monitor the situation and will make the appropriate adjustments if and when necessary.

### Date and Time of Works

Implementation of the proposal may be as soon as **7 September 2020**, weather permitting. See the general layout plan overleaf.

### Further Information and Contact Details for the Works

The people looking after these works are:

James Geeson Merton Council Engineer: 02085453054

Gus Smith FM Conway Ltd, Contract Manager 07748632920 / 02086368822

FM Conway will erect information boards on site and their staff will be able to update you on the progress as the works proceed. Please adhere to the social distancing rules.

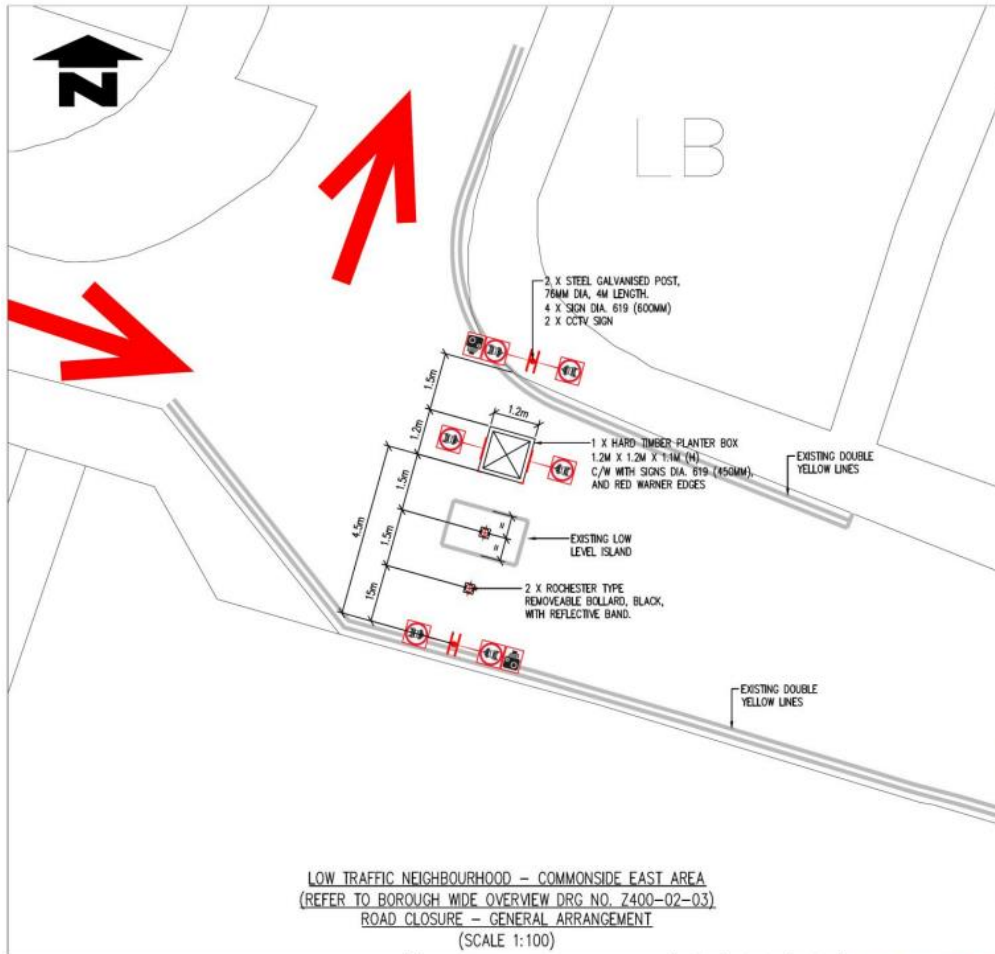

LOW TRAFFIC NEIGHBOURHOOD – COMMONSIE EAST AREA  
 (REFER TO BOROUGH WIDE OVERVIEW DRG NO. Z400-02-03)  
 ROAD CLOSURE – GENERAL ARRANGEMENT  
 (SCALE 1:100)

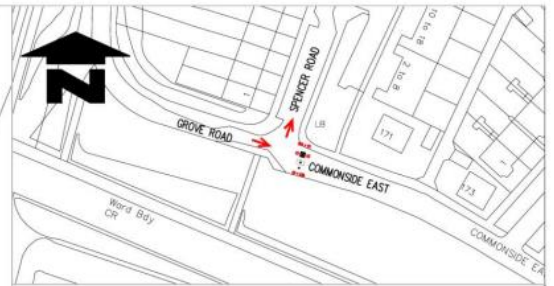

OVERVIEW  
 (SCALE 1:1000)

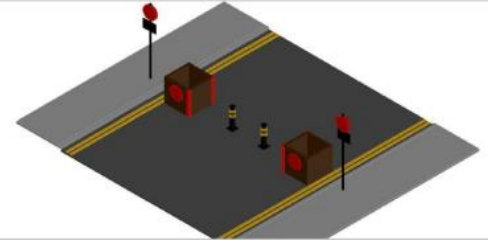

3D CONCEPT



GOOGLE MAPS STREET VIEW

Notes  
 Do not scale from this drawing

Revision	Date	By	Check	Appr	Scale	Notes

**Sustainable Communities**  
 Environment & Regeneration  
 FUTURE MERTON

Author	Yes	
Checked	Yes	
Approved	Yes	

PROJECT: COVID-19 TEMP SAFETY MEASURES  
 TITLE: LTN - TEMP ROAD CLOSURE COMMONSIE EAST

**merton**  
 Merton Civic Centre  
 London Road  
 Merton, Surrey  
 SM8 5DX  
 www.merton.gov.uk

Drawing No: Z400-02-02-03  
 Revision: -  
 Check status: DRAFT  
 Date: 1:100, 1:500

Road Name	views	Comments or representations
Brenley Close 6248186	Agree	Hi I live near the bit where you blocked off I walk around there every day and the plastic things Conway put in are there a chance you can put a wooden plant box there
Commonside East 6314646	Agree	I would like to see more restrictions on Commonside East. Maybe make it one way and divert the 118 bus a bit.
Commonside East 6284197	Agree	I regularly walk through grove road to Mitcham eastfields station- previously it was quite alarming how quickly people drove down the road. This has now stopped.
Commonside East 6249575	Agree	-
Commonside East 6283921	Disagree	The congested traffic in the area is already causing long ques with delay in driving through and around Mitcham. Enough is enough the fumes are not good and time factor for any travel is doubled. There is more traffic already from other closures of roads and from more housing that has been built increasing the amount of cars around Commonside East over the past few years.
Commonside East 6249575	Disagree	-
Spencer Road 6283964	Agree	In my view, it perhaps would have been kinder to motorists and more helpful to local residents to have installed the LTN barrier at the junction of Acacia Road with Grove Road, which is approximately midway between the Tamworth Lane and Commonside East arterial routes.
Spencer Road  6284027 6284024	Agree	Thank you for this change!  ----- I appreciate the changes that have been made in Grove Road and the subsequent reduction of traffic in Spencer Road Thank you
Spencer Road  2 submissions from same person 6248948 6291232	Agree	I am very pleased that finally the rat-run issues in Spencer Road have been stopped. There are many seniors in Spencer Road, including my lodger, who have mobility issues and the constant through traffic over these years has been dangerous. There have been multiple near misses and numerous damaged cars, all done by drivers with no regard to anyone's safety - because they are too lazy to spend a few extra minutes choosing another, wider route. As long as the emergency services have complete access, it would better if these temporary measures were to become permanent.  ----- Having the restriction in place has been wonderful. The 'rat-run' of Spencer Road has ended, and residents no longer have their vehicles damaged or their pets killed. (There was criminal damage done to the restriction bollards, but fortunately the Police have identified the two individuals). It would be ideal if we could have one or two more planters in place, instead of the bollards. The emergency services have been using the wider roads of Tamworth Lane and Cedars Avenue, which is quicker for them. The only other vehicles that use the Spencer Road Junction are Veolia, but that is only once a week, and surely they could adjust their route? This restriction is a good thing!!
Spencer Road  6283847 6291647	Agree	The scheme has turned Spencer Rd from a busy rat run with constant high speed traffic into a quiet, peaceful residential road. Wonderful. Having had a car damaged, another written off, and been knocked over (thankfully only minor injuries) by speeding rat runners over the past several years I am extremely happy that the council has finally taken action to improve the road I live on. The benefit massively outweighs the small extra time



		<p>needed on the occasions I need to use my car.</p> <p>-----</p> <p>This scheme has made a huge difference, for the better, to living in Spencer Road. I have lived here for over 25 years and have seen the steady increase in the amount of traffic in the road. This is a narrow one way street not built for the amount of traffic that comes through here. It has become a rat run over the years. The chicanes that were put in many years ago, do not slow the traffic down and drivers using this road as a rat run would speed through. Traffic was always continuous during rush hour and busy even at the weekend. Parking was always hazardous as you would more often than not have someone, in their car, right behind you as you manoeuvre. They would then get impatient, sound their horn and a cars waiting would pollute as they were waiting. My husband was once knocked down by a van using this road as a rat run. He was walking home from the train station and he ended up in A&amp;E in St. George's. We have also had a car written off; been rear ended and also had a wing mirror taken off. Neighbours have had similar incidents with their cars. It is now so much quieter in the street, which makes a huge difference, as our house is not set back far from the road. Without the number of cars cutting through our road the pollution has gone down too and I have seen several cyclists enjoying using the road now instead of sometimes going up on the pavement to get away from the cars. I wish this scheme had happened when my children were growing up here and using their bikes. I also feel that there may be less people using this road as a carpark for the station, which is great as there aren't enough parking spaces for the residents. I really hope this becomes permanent. Sometimes a bollard goes missing so that needs to watched.</p>
<p>Spencer Road</p> <p>Submitted twice</p> <p>6250651</p> <p>6250641</p>	<p>disagree</p>	<p>Dear Sir/Madam, As resident of Spencer Road who is directly affected by this scheme, I do not see the necessity for the blocks in order to allow space to social distance as in my experience there has been ample space to socially distance whilst walking before the blocks were put in place. In addition, the blocks significantly increase the amount of time taken for our daily commute into school and work affecting our concentration, especially for my brothers. Before the blocks were put in place, I have never felt that the cars that may use Spencer Road as a 'through' route were causing an issue to the neighbourhood; there was rarely any congestion/traffic on the roads and having some cars pass through the neighbourhood in fact helped me, as a resident, to feel safer as there were more people around in case of muggings or ambushes, which I know have happened on our road before. However, after the implementation of these blocks, I worry that Spencer Road has become very isolated and secluded which I believe may be a bigger danger, more relevant to this neighbourhood than the threat of road danger due to the existence of the through road. I think a different approach to increase physical activity would be better as the blocks interfere with commute times where it may not be the most convenient, for example, due to the distance of their school it is not possible for my brothers to walk/cycle to school however they love to practice football afterschool but due to the blocks they get home later leaving them with much less time to do so. I hope you consider my points and make the decision to remove the blocks in due time. Thank you.</p>

<p>Spencer Road</p> <p>6269564 6284213</p>	<p>Disagree</p>	<p>Emergency vehicles, this delays them getting to their destination, the time they have to stop and unlock the poles, will cost lives, bearing in mind as residence, our only way out is on to Tamworth lane, which brings u to the level crossing, which is congested at most times. There is no keep clear box there, residence should have at least access along there, some delivery lorries/vans have a hard job going along grove road the road is narrow, when there are road works on Tamworth or nearby, it adds to the traffic, this has not been thought through correctly, people are under enough stress as it is, as a key worker, having to leave even earlier to get to work is stressful enough. I feel you have wasted public money implementing these schemes, roads were built to be used. Spend it on repairing them. also people should be consulted first.</p> <p>-----</p> <p>Should have been consulted before implementation, residents should have access, like u have done on school roads, Tamworth road had roadworks, road closure and only route was level crossing, this puts extra delay time on journey, your pushing cars over the level crossing this effects at marks, congestion, causing more stress, emergency services don't have access, we seen them having to turn around, this cost lives, we all having bro come out into the level crossing this is wrong taking longer to get to work, etc, not thought through properly</p>
<p>Spencer Road</p> <p>2 submissions from same person 6283903 6307450</p>	<p>Disagree</p>	<p>The scheme has just aggravated the traffic problem existing in the area conveying all the traffic to one single road (Tamworth Lane) that with the train station isn't prepared to receive so much traffic. Also the area doesn't see that much traffic outside peak hours. This decision is wrong and should have been taken after consultation with the neighbourhood and not before.</p> <p>The restriction hugely impacts on traffic in the area at peak times, causing stationary traffic for long periods of time impacting on the environment in the area. I think that if there's safety concerns using humps can be a nice way of preventing speeding</p>
<p>Spencer Road</p> <p>6249216</p>	<p>Disagree</p>	<p>This road blockage has been implemented without consultation and consideration for the impact on the local residents and businesses. Whilst I understand the rationale for these projects, the means by which they are implemented is not effective and has not been thoroughly investigated. The reasons being: 1. The traffic on Commonsides East and Tamworth Lane, as well as all roads leading to and from Mitcham East, have been severely affected and this area was already highly congested. 2. Residents who have children, particularly those with physical disabilities, are severely disadvantaged by this measure due to the increased traffic and the time it takes to get to and from school. This impacts on pollution levels, parental stress and school readiness and all this, at a time when we as a society are already going through substantial disruption. 3. There is an increase in the number of vehicles driving around the one way system that leads to Spencer Road as they attempt to exit on to Commonsides East, causing frustration for drivers, increase pollution and traffic on this road and difficulties maneuvering, particularly for larger vehicles. 4. Residents of Spencer Road and Grove Road are disproportionately affected by this measure as this prevents direct access to Commonsides East, instead requiring us to drive a further distance and in congested roads, which increases pollution. 5. Impact on house prices for properties on Spencer Road and Grove Road as new buyers are likely deterred by the lack of access. 6. Increased pollution as the refuse trucks (and any other services requiring access) have to drive further to access Spencer Road and Grove road as there is no longer direct access. 7. The increased impact on local traffic levels has affected the speed with which emergency services can respond to situations.</p>
<p>Spencer Road</p> <p>6250968</p>	<p>Disagree</p>	<p>I live on Spencer road off common side east and it has added 20 mins + to my journey. Due to the train station at the end of the road. I now have to sit in the endless amounts of traffic due to the train line. Not only in the evening but in the morning as well. I have to leave my house 30 mins earlier than before due to road closure.</p>

<p>Spencer Road</p> <p>6269965 6270133 6247414</p> <p>All 3 from same address 2 from same person</p>	<p>Disagree</p>	<p>I am a resident of Spencer road and have lived here for nearly 40 years and think this road closure has been placed in the wrong location. I feel it is totally unacceptable to place a road closure on a residential street stopping residents from gaining access to their own properties. I am all for reducing traffic in residential roads etc but feel that this closure would have been more beneficial on the end of Acacia Road, as this would still allow residents to gain access to Spencer road, kings Road and grove road one way system but stopping the vehicles using this route as a cut through to Tamworth Lane. I feel the council's decision to go ahead and install these road closures, without consulting residents absolutely disgraceful, I feel you would have received an abundance of good ideas and suggestions from the local residents who use these roads regularly, whether that be by foot, car or bike.</p> <p>-----</p> <p>You recently installed the most ridiculous road closure to Spencer road and then on 24th October 2020 you decide to carry out road works to Tamworth Lane, which is road you now force me to drive down in order to get to my property. This meant I was unable to get my myself and my 3 year old daughter home. I live next door to dad, who has recently been diagnosed with a high grade brain tumor and if we have required any medical assistance over this weekend by either a doctor or ambulance, they would of been unable to get to us and I feel this is disgraceful and very unacceptable.</p> <p>-----</p> <p>I think the closing of access into my road (Spencer road) from Commonsides East is absolutely ridiculous and completely unnecessary. FIRSTLY only providing residents with two weeks' notice of this road closure is absolutely disgusting and in my opinion a sneaky way of implementing something that you know full well would be strongly opposed. SECONDLY this has already caused significant disruption as NO SIGNAGE WHATSOEVER has been put up at junction of Acacia Road / Tamworth Lane and all traffic is now stuck doing laps of our block !! THIRDLY the travel time now to get to my own home from Commonsides East side is now a ridiculous 15-20 mins during rush hours and school turnout time due to Tamworth Lane always being backed up because of the Railway Crossing being down so often during these times, I don't think that whatever clever clogs came up with this road closure considered that did they !! FORTHLY Emergency services are going to be SEVERLY hampered by this closure and I hope you are fully prepared for the fact that a resident within our block could end up losing there life because emergency services are stuck in the backed up traffic on the diverted route in Tamworth Lane !! FIFTHLY it is a complete and utter waste of money that could be put to much better use in the community and the fact you are using the Coronavirus situation as an excuse to waste this money is a beyond a joke. I have much more to say on this subject and expect for a council representative or planner to contact me asap.</p>
<p>Spencer Road</p> <p>6249974</p>	<p>Disagree</p>	<p>It is absolutely ridiculous and as an elderly person living alone I am terrified of how long it will take for an ambulance or emergency services to reach my address if I am in trouble. As an elderly person I rely heavily on food delivery services and since this road closure has been in place I have already had two deliveries fail to arrive because the traffic is so bad on the long way round. I have lived in my house since it was first built in 1976 and in all my years here I have never experienced so much disruption to mine or my neighbours lives. The majority of people in my street are good, hard working, honest people that do not deserve the incredible inconvenience's that are being caused by closing off the main access to there homes. I want it removed completely as soon as possible so I can get back to feeling safe that emergency services can get to me should anything happen.</p>
<p>Grove Rd</p> <p>6280348</p>	<p>Agree!?</p>	<p>I don't believe adequate consideration was given to close proximity of the level crossing and the impact it has on traffic even during lockdown with most residents working from home etc</p>

Grove Rd 6300829	Disagree	I am deeply agitated with the new LTN application at Commonsides East. As a key worker, I must drive at work everyday going past Cedars Avenue. Grove Road, where I currently live in is already a one way road, so with the new LTN I 1) can't get to Acacia Road and onto Tamworth Lane without having to circle around the neighborhood, which already has tight roads and immense traffic (especially during rush hour - because of the nearby train station) and because there is a ONE WAY SYSTEM ALREADY IN PLACE. 2) I can't get to Cedars Avenue (where I need to go past everyday) without spending up to 30 mins on traffic circling around. Either get rid of the LTN here or made Grove Road a two way system road. I work in construction myself so stop making these stupid decisions and offloading OUR TAX money on stupid applications like this.
Grove Rd 6250541	Disagree	We have lived in this house on Grove Road since 2006, paying council tax and supporting the local community. We walk every day, are fit and healthy and our children are in excellent health and also take part in many sports. We use the car only when necessary which includes the school run and my journey to work. I take my son to school in Croydon every morning and then must get back to St Thomas of Canterbury Mitcham by 8.50am for my daughter to get to school on time. My son cannot arrive to his school before 8.15am due to Covid restrictions. This leaves me with a very tight turnaround to get my daughter to STOC by 8.50. Since the restrictions on Commonsides East it has added 20 mins to my morning journey and my daughter has been late to school most days, thus impacting an already disturbed education due to Lockdown. When the map reroutes me from the end of my own road it deduces that due to very heavy traffic on Tamworth Lane, I need to take a left on Tamworth Lane, up towards Streatham, along Meopham and down through Thornton Heath to get to a road that I usually reach within 5 minutes from the end of my own road. All because I can't exit the road on which I live. I have then received PCNs for entering the road outside STOC school on commonsides east in Mitcham since there is NO opportunity to drop my daughter in the middle of the busy road and time does not allow me to return to my home on Grove Road, park and walk her in, after returning from dropping my son at 8.15am in Lloyd Park. It MAY if I was able to enter the access to Grove Road via Spencer Road on the way back, but I am rerouted down Cedars, along Tamworth Lane (where the level crossing leaves traffic very heavy on that road), down Acacia and then finally onto Grove Road. I am actually struggling so much with the stress this is causing that I am going to have to seek reduced hours at work as I simply cannot make the 2 school runs and then get back up to Streatham in time for my 9.15 start.
Kings Road 6284108	Agree	Please don't get rid of it. It has improved our quality of life and the safety of our road dramatically. My son was nearly knocked over twice by people racing down Spencer road. There is hardly any traffic and parking is massively improved.
Kings Road 6284074	Agree	Please keep restrictions. Previously people have used Spencer Road as a quick cut through and many cars fly down this road. I'm surprised that nobody has been hurt considering how often this has happened. I have a four and nine year old and have always worried about the traffic coming through at such a rate. I worry for anyone that could be hurt here. Since the restrictions this has cut most of these vehicles flying through. It has meant more time for me driving in and out to certain places, but that is an absolutely fine price to pay for safety.
Kings Road 6301382	Agree	I think the restricted traffic has made the surrounding streets safer as a pedestrian and a cyclist
Kings Road 6284204	Agree	-
Kings Road 6254797	Disagree	The impact on Tamworth lane is awful. It has made the traffic terrible as all traffic is forced onto the road with the level crossing and the high school. Which adds considerable time to all journeys not to mention the heightened pollution outside a school. I'm also concerned about the added time it will mean for emergency vehicles to reach residents in Grove rd, Spencer rd, Acacia rd, kings road. I don't think it has done anything to help anyone.

Kings Road 6247355	Disagree	Hello I'm a resident of King's road and blocking off this road as you have means I will now have to essentially drive around the block past my house twice before I can park on my road outside my home. Which is just going to add to the traffic on two now extremely busy roads. How can this be thought to be a good idea, it makes no sense and does not seem to have been thought out at all. We already have silly Chicanes blocking the traffic that does make it to these roads, how on Earth is the traffic that does make it here now meant to drive around and around kicking out more fumes meant to be good for the environment! Please have a rethink on this ridiculous idea of blocking off this road!
Kings Road  6247365 6248048 6251822 From same person	Disagree	It will put more traffic on Cedars Ave and Tamworth lane as well as cause longer tail backs on the bee hive bridge which will back into Mitcham town Centre which is busy at the best of times. I live in the Cul De Sac end of Kings road, I now have to go round into Cedars Ave then Tamworth Lane, turn left into Acacia into Grove road and back into spencer road to get back into Kings road. I see it causing problems with emergency service getting to people that need help and wasting valuable time. I live in kings Road and now have only one way to get to kings road, I used to come in from Commonsideside east then spencer road, I now have to go down Cedars Avenue then Tamworth Lane into Acacia road, grove road then kings road. Lack of signage is also problem, there is one small sign as you turn left into commonside East as you come from Mitcham but nothing if your turning right, there is no signage in Acacia road or Grove road to say there is no exit on to Commonsideside East, so many cars are now doing laps to come back out into Acacia Road to then exit onto Tamworth lane. Emergency access is now also going to be a problem for Ambulances and valuable time wasted if someone were to have a serious problem such as a Stroke or Heart Attack as the First Hour or ( the Golden Hour ) as it is known is crucial for a good recovery. I have lived in Kings Road for 26 years and would not class this as a rat run. As a resident of kings Road for 26 years i think this is ill convinced idea, on average since you blocked off Commonsideside East it now takes me on average 20 to 25 minuets in the morning to get to commonsideside East via Tamworth lane and Cedars Avenue, adding to the problems is the level crossing at Mitcham Eastfield's when down it causes grid lock in Tamworth lane which then goes into cedars Avenue, at these times i just hope emergency vehicles can get down said roads in time to save lives.
Kings Road 6288421 6302123	Disagree	By closing the exit to common side east and making exiting and entering the road by Tamworth Lane has made it impossible to get in or out of the road in traffic it would have been better if at all to have closed the end and left the entry via common side I do not think or won't main entrance at Tamworth Lane ----- I strongly recommend re opening entrance from common side east Mitcham and closing the entrance to Tamworth Lane which is very promomatrice entering and leaving acacia road into Tamworth Lane both myself and my hubby are not happy with this
Worcester Close 6284113	Agree	Congratulations on finally listening to the residents that it was a rat run from Commonsideside to Tamworth Lane. Back about 30 years ago I got up a petition against the removal of the one way section in Acacia Road where it was no entry towards the common just beyond Worcester Close and the closing of Grove Road to through traffic at the roundabout. I was told then it would not make a rat run, but traffic has continued to rise. Despite repeated complaint's and traffic counters etc you have finally listened. The volume using the rat run is bourne out by the complaints of more traffic in Tamworth Lane. I can now sleep at night without the constant noise of traffic racing over the speed humps outside my house. All you need to do is catch the person who keeps removing the bollards at the closure and put in CCTV
Worcester Close 6283967	Disagree	It is a nightmare trying to turn left or right into Tamworth Lane from Acacia Road especially when the level crossing is down also a nightmare turning left into Tamworth Lane from Cedars Avenue trying to get to Worcester Close when traffic built up due to level crossing. The closure at Spencer Road is not good for the environment as I use far more fuel going all round the houses than I would if there was no closure. I am disabled so walking or cycling is not an option.

Worcester Close 6284931	Disagree	Takes me 30 minutes longer to get home which means more traffic along tamworth lane and more pollution as cars sit with engines running
Worcester Close 6283949	Disagree	There already exists a phenomenal amount of traffic in this area, Mitcham and around the level-crossing causing unnecessary build of heavy traffic and so having the opposite effect of better smoother and eco friendly movement of vehicles. It has been consistently noticed by residents that closing roads has a diverse effect on traffic flow. It always always is clearer without more obstruction.

### Outside consultation catchment area

Queens Annes Gardens  6285464	Agree	I have cycled throughout London since 1993, when I first moved here. That was prior to any bike lanes being here at all, of course. Every bike ride to work or otherwise was an exercise in taking one's life in one's hands. Somehow I managed to come through unscathed, as the new Mayor of London started instituting a city wide network of bike lanes. I continued cycling to work, at one point ten miles each way per day, something which urged me toward much longer charity rides. Suddenly, on Feb 17th 2012, a grey HGV cut in to the blue cycle highway I was in, clipped my handlebars and dragged my along under one of its wheels. The fact that I'm alive at all continues to surprise me daily, and I was left with some debilitating leg injuries, and mental scars, both of which I have worked hard to overcome the limitations of. I currently live in Mitcham, and cycle in to a training course in Balham every day. On weekends, I am a care worker, on my bike from 6am in the morning to 10pm at night. I have only started these on my bike since the LTN work, both in Mitcham, and along the main route from Colliers Wood through to Balham. Without them, I would not have had the courage to start cycling again, some 8 1/2 years after an abrupt halt. To be cycling, knowing that there is a barrier between yourself and HGV's going by, as well as buses and smaller lorries is a freedom that has sometimes made me laugh for joy. It has given me back my freedom, and the ability to build my confidence back, so much so that I am now taking other routes too, and have been able to take on the aforementioned care work. My husband and I decided that we would not get a car until we could get an electric one. In fact we realised that we don't need to buy one at all, as long as we still have freedom to move either by bike, walking or public transport. The health and environmental benefits for the Mitcham community are of equal weight and import. It must be a beginning, not just a short term experiment
Valley Road 6305745	Agree	-
Bennetts Close 6283997	Agree	-
Rowan Crescent 6250762 6250763	Agree	I misread this the first time I responded. If this is on the spur of Commonside East to stop people turning off the main Commonside East before Cedars Avenue then I agree, If it is on the main Commonside East I deeply disagree
Northway 6302358	Agree	-
Priory Crescent Wembley 6300603	Agree	-
Woodside 6267028	agree	Very good scheme. Hopefully will be permanent as want reduced pollution and more exercise

Lammas Avenue 6283978	Disagree	Just causing more traffic chaos, Mitcham is bad enough as it is!
Chestnut Grove 6250390 6298278	Disagree	<p>I think that your plans are simply ludicrous making everyone's journeys longer on purpose creating unnecessary traffic jams.. not all people are only going out to take kids to school. Some people have to get to work too far to walk. One thing you cannot give back to people is there time and take back the unnecessary stress you are placing people under. We pay our road tax and now cannot even drive on the roads, the roads are not private roads. You are out to cash in on people whose budgets have already been squeezed enough after the government decides to unlawfully lock down the country and you adding to it by working as there puppets following orders making peoples lives an absolute misery you should be ashamed. I'm disgusted you have already taken our right to park where we live away by coming along one day and painting yellow lines everywhere.</p> <p>-----</p> <p>Making cars travel further to reach there destination does not make for cleaner air. Forcing cars to all travel on the same roads will cause greater congestion. Road users pay taxes on roads they can no longer drive on in the way they were 1st designed. Reducing limits to 20mph making journeys longer so more petrol being used therefore greater pollution. Its all part of the agenda sadly and despite residents and commuters who strongly disagree you will do what you want any way. Its all on purpose.. money making schemes to catch people on cameras.. when you block routes with planters more people will die when ambulancesand fire engines have time added to there journeys when trying to save lives.. you must have no brain cells if u thinks these plans are for the greater good.. they are being rolled out all over the place regardless of general consensus. I do not concent to any of the plans you have to close roads and restrict access.</p>
Tamworth Lane 6249631	Disagree	Surely it will simply push the traffic on to neighbouring roads. The weight of traffic along Commonsides East isn't going to be able to be diverted along Tamworth Lane or Croydon Road. Commonsides East isn't a wholly residential road so it doesn't make sense to do it there. Why don't you consider making Cedars Ave 2-way again - with giveaway sections to reduce speed. THAT would do loads to reduce the traffic having to go all the way in to Mitcham which is a proven bottle neck area
Manor Way 6249427	Disagree	It's a main thoroughfare to access mitcham town centre. These schemes just cause more pollution by increasing journey times, and push traffic onto surrounding roads. Mitcham has so many bottle necks already. Why make things even worse?! This feels like box ticking to meet a government target.
Melrose Avenue 6247709	Disagree	-
Melrose Avenue 6250004	Disagree	It is totally unfair with the elderly people, kids, and also for emergency services, if streets will close how they going to responds.
George's Road 6283954	Disagree	There already exists a phenomenal amount of traffic in this area, Mitcham and around the level-crossing causing unnecessary build of heavy traffic and so having the opposite effect of better smoother and eco friendly movement of vehicles. It has been consistently noticed by residents that closing roads has a diverse effect on traffic flow. It always always is clearer without more obstruction.
Esher Road 6250934	Disagree	How can you implement a plan forcing further traffic onto and already congested A236. Until you resolve this issue then the suggested LTN in Commonsides East will cause additional pollution through Mitcham Town Centre, and could possibly lead to delays in Emergency Services attending incidents.

St Marks Road 6247987	Disagree	Following LTN implementation in wandsworth at the same time as the TFL space programme we have seen an increase in pollution, more congested traffic and roads close to the LTNs have become busier and more congested. Worst of all we have seen multiple blue light vehicles stuck in traffic while trying to respond to emergencies. This particular route is in between three major hospitals so it would not be wise at this point in time to increase congestion here. Considering covid infection rates are going up not everyone can walk or cycle, we have seen buses stuck in the same traffic as cars and my journey into work had been horrendous. It has been 2 hours longer everyday. The implementation in wandsworth has divided neighbours and has caused a number of business to close. Even key workers such as bin men and post men have not been able to do their jobs. Considering merton has a fortnightly collection that's a risk I'm not willing to take Vulnerable residents have missed hospital treatments such as chemo & dialysis. Furthermore, this money should be spent on introducing santander bike system or escooters, feeding school children, cycling programs. Please do not bother implementing this scheme, we've already seen a number of councils having to suspend and remove the LTNs in place.
Mulholland Road 6249571	Disagree	It has put even more pressure on Cedars Avenue and Tamworth Lane. Both these roads get grid locked during rush hour already, closing Spencer Road has made things worse. To be able to access Eastfields Estate via Mitcham Common, using Spencer Road when the train gates are down is the only viable route. Closing Spencer Road will also have an impact on the 463 bus route, as the buses will be stuck in traffic for longer when in Tamworth Lane. Cedars Avenue and Tamworth Lane pollution levels will sky rocket as a result of this road closure
Strathdon Drive 6309092	Disagree	I most strongly object to this scheme, having first hand experience with LTN's in other boroughs of London. They bring nothing but bitterness and division adding extra stress at an already extremely stressful time. Using the Covid pandemic is a disgusting excuse and you should be ashamed of yourselves for even considering a scheme such as this when as residents of this city we are warned against using public transport. Not all of us work 9 - 5 jobs in the city with well equipped shower facilities. I for one work very early and very late shifts and would not feel safe walking or cycling past the junkies, drug dealers and prostitutes that gather outside the gates I have to pass through to get to our work studio in the early hours of the morning. I'd like to take you with me so you could see for yourself and then see if you're still so keen to add to an already stressful existence.
Franklin Way 6283980	Disagree	-
Pentlands Close 6304463	Disagree	-
Beatrice Avenue 6284251	Disagree	Total joke the whole country has gone mad with all these schemes making it impossible to get anywhere. Why import millions of people into this country with no thought of infrastructure then expect them to cycle and walk everywhere?
Potter Close 6249975	Disagree	This is causing so much more traffic on the other roads around for example Tamworth Lane was at a absolute stand still. The traffic is being forced onto the roads where two schools are located. Acacia road is always at a stand still every morning now. My mum lives on Kings Road and now has to leave home twenty mins earlier just to get out onto commonside east. This road block needs to be removed I don't believe it is fair on the residents of Spencer Road, Kings Road, Grove Road and Acacia Road.
Avoca Road Submitted twice 6318900 6318899	Disagree	My Pal who has #MS, and who can only get around by car, can no longer drive directly home because of #LTN #LTNs The longer journey time means he regularly soils himself But I guess you, as an Abelist, are OK with that You should be ashamed for being so selfish This is what LTNs do These comments apply to all of your proposed LTN schemes



Beech Grove 6285026	Disagree	I think the scheme is bad as it causes mountainous amounts of traffic in the area during rush hour on Tamworth Lane and Commonsides East as they are the two major roads in order to get out of the area to get to other destinations. Having that road open as an option to get around was better because there was less congestion. Stationary cars increases air pollution and in this area in particular there are not many people who cycle but rather walk and the inhalation of fumes for them is not good. Buses are meant to flow but they too get caught in the traffic and are unable to get people to their destinations on time. I think the LTNs are a bad idea in general and should be removed.
Edge Hill 6309816	Disagree	This has increased the congestion for traffic in the area to unacceptable levels. It's all very well telling people to walk but many are unable or the journey too long. It's made living here truly miserable. I hope to vote in local elections for someone who can address this and have these removed.
Laburnum Road 6283965	Disagree	This has increased the congestion for traffic in the area to unacceptable levels. Its all very well telling people to walk but many are unable or the journey too long. It's made living here truly miserable. I hope to vote in local elections for someone who can address this and have these removed.
Robinson Road 6318759	Disagree	The best way to solve traffic problems is to allow cars and vans to move freely around all roads, the white van man and the mums/dads in cars with kids, the shopping and the grandparents CAN NOT use bicycles or walk!! People have a right to get in and out of their roads how they wish using all entry and exit points. Also how do disabled drivers get in and out?? LTN's and road turning restrictions belong in communist Countries!! Not the UK:)
Merton High Street 6318738	Disagree	Blocking access will divert traffic on another route which will cause more traffic and congestions in those roads. Public still need to travel and this will not stop it but just divert causing more issues and congestions.
Shaftesbury Road 6250443	Disagree	-
Taunton Avenue 6303437	Disagree	Haven't seen enough of the detail to make a reasonable judgment, but would always advise caution introducing a new road layout when we are still in a lockdown and have no real information on how things will look at the end of that time.
Sycamore Road 6253356	Disagree	The area becomes completely congested, with long tail backs and long waits for the traffic to clear, and lots of fumes and pollution emitted by cars as they wait to drop off children or wait to be able to drive through the traffic jam.
Cambridge Close 6309704	Disagree	-
Peterborough Road 6285055	Disagree	All you are doing is building traffic everywhere else which causes vehicles to sit there and destroy the air quality even more and doing so in every other street which can't be fair surely. How is it fair to build traffic in other streets or does the health residents in some streets matter more than others?
3 Furlong close Wallington 6271014	Disagree	This road closure has caused my family nothing but trouble. My parents live down Spencer road, and my dad is extremely poorly with brain cancer. Trying to get him to treatment early in the morning at the Marsden hospital for a solid 6 weeks when he is already feeling so poorly and then having to sit in traffic and diversions for even longer was a nightmare. My dad collapsed today and need an ambulance to be called! The ambulance could not get down the road and was unaware there was even a road closure which could have had life changing consequences for someone. If my sister has not been standing at the end of road and asked a neighbour at number 2 who has a key for the bollard to open the padlock, my dad would have had to wait even longer because both entrances to common side east are now blocked!!!! Please remove this road closure! The ambulance had trouble squeezing through the small gap and I think when it's restricting the emergency services getting to residents in a timely manner, then it needs to be removed. Please take this seriously! I lived with my parents at Spencer road for 30 years

		and the road was never busy and it was never a bother being used as a cut through. Please please take this closure away
Wessex Avenue 6309263	Disagree	it's not the right way to restrict traffic and redirect it to other roads which are packed already. find efficient measures instead of easy ones.
Grand Drive 6252905	Disagree	This will lead to increased traffic when traffic in the area is already bad. Increased traffic leads to increased pollution
Nairne Grove 6248195	Disagree	-
Ruskin Drive Worcester 6264677	Unsure	-

### Full Address not provided

Kings Rd – 6260138 -6250491

To whom it may concern I'm not sure who's bright idea it is to close off Spencer Road/Kings Road, but i have been living in Kings road for over 44 years, and you now decide to close the road for (what i can see no good reason), but what you call (LTN), i haven't got a clue what you hope to achieve from this, but let me just explain for three mornings on the trot it has taken me nearly ten minutes to get out of Acacia Avenue onto Tamworth Lane, Because of the Railway crossing ,. And following on from there, on Friday afternoon (18/9/20) it took me approx 20 mins to get from the bottom of Beehive Bridge, down to Cedars road, then left into cedars road, then left into Tamworth lane, and then left into Acacia avenue, if this is going to be the norm, thanks very much indeed, because i don't think you people sitting in your ivory towers have an iota of the upset you cause , because you sit there having to justify your existence if you see this sounds facetious it is, i have never before complained about anything that Merton council has carried but this takes the biscuit thanks very much ( I'm sure there will be many more people complaining against this proposal

To whom it may concern Further on from my first e-mail, i would like to bring to your attention, that on the 4/10/20 (sun), at approx 2.50 pm i suffered a TIA (Stroke), when the ambulance turned up they informed me, that it took them an extra 3 mins to get to me because of the blocked road, at Spencer Road, That 3 mins could have been a matter of life or death, thank you for taking my life in your hands. I am strongly going to protest these changes, as it has also caused our one way road into a two way road, as we have now noted 5 cars coming down the wrong way, and one big van backing down the road, we have also noticed some lorries now coming down Spencer road, because they have not noticed the signs in Tamworth Lane, that it is a non through road, and have to go all the way back, nice

June 2021

## COMMONSIDE EAST- LTN - REVIEW

**REVIEW OF LOW TRAFFIC NEIGHBOURHOOD (LTN)**

Dear Occupier,

As you are aware, during September 2020 the Council introduced a Low Traffic neighbourhood scheme on Commonside East under an Experimental Order. The 6-months statutory consultation closed in March 2021 and we are currently considering all the feedback received.

It is appreciated that some residents had concerns and some reservations when the LTN was first introduced particularly during the settling down period, but it is hoped that despite some minor inconvenience to some residents, many of you have come to enjoy and acknowledge the benefits.

Some concerns were also raised regarding access for emergency services and the routine vandalism which has been resolved by the installation of an ANPR camera.

Before making a final decision, it has been agreed to undertake a review of the scheme. As part of this review, we are asking you to submit your views to a simple on- line questionnaire using the <https://consult.merton.gov.uk/survey/857> on the Council's website.

Those who do not have access to a computer, can call 020 8545 3700 and ask for a hard copy of the questionnaire and one will be posted to you.

The deadline for submission is **2<sup>nd</sup> July 2021**. Please note that it is only one submission per household and as part of this review individual responses to comments will not be made.

The Cabinet Member will make a decision based on the feedback received during the statutory consultation and the outcome of this review. Your participation within this review is, therefore, important.

You will be informed of the Cabinet Member decision once a final decision is made.

Figge's Marsh Councillors (contact details of Ward Councillors are provided for information purposes only)

Councillor Geraldine Stanford [Geraldine.Stanford@merton.gov.uk](mailto:Geraldine.Stanford@merton.gov.uk)  
Councillor Agatha Akyigyina [Agatha.Akyigyina@merton.gov.uk](mailto:Agatha.Akyigyina@merton.gov.uk)  
Councillor Mike Brunt [Mike.Brunt@merton.gov.uk](mailto:Mike.Brunt@merton.gov.uk)

Cllr Martin Whelton, Cabinet Member for Housing, Regeneration and the Climate Emergency.  
[martin.whelton@merton.gov.uk](mailto:martin.whelton@merton.gov.uk)

Cllr Rebecca Lanning - Cabinet Member for Adult Social Care and Public Health  
[rebecca.lanning@merton.gov.uk](mailto:rebecca.lanning@merton.gov.uk)

Acacia Road 6338418	Yes	Please don't take the barriers away, if people are concerned about access for emergency vehicles puts a gate there that they can open. Gone has the cut through traffic, of which I welcome, no more danger two kids crossing the road no more fast cars with blaring stereos, no more parents or at least not as many parents dropping off the kids for school, making their kids walk to get some exercise, and not blocking the already busy crossing. Even the drug dealers that used the back of the chip shop alleyway to drop off drugs, that I used to watch opposite, have moved on, probably because they know they haven't got an escape route, brilliant !! (It was every day). I know some residents will be opposed to this, but that is because it was an easier access, they're not looking at the full picture just personal gain. Again thank you for placing the barriers there, I hope they remain so we can have a quieter life and peace of mind. And also may I say I have seen the police use it to their advantage when cars turned down the road and I can't get back out. Thank mark.
Acacia Road 6338655	Yes	much more peaceful now the rat run is closed. My car used to get covered in scratches usually due to 'white van man' doing 30+ mph down the road trying to beat oncoming traffic
Brenley Close 6338920	No	We have lived here for over twenty years and have never had an issue with using this road to access our property. This is so unnecessary as its already a one way system, now it has now caused us to be on the road longer, especially when traffic. When my wife finishes late at work and cant park on our close she has to then drive all the way around to park on the other side of the bollards. You have now installed a camera to gain revenue, yet you are unable to install CCTV for fly tippers in this area - What does our opinion matter, do do what you want?
Brenley Close 6339305	No	the scheme has caused more traffic to come down our close simply for turning purposes. Children play outside and cars fly down the road to turn. I would also add that my mum lives in Spencer Road which is the next road along. She is 91 years old and needs constant attention. I used to be able to drive there in 2 minutes if needed but now i have to go all of the way around Cedars Road, back down Acacia Road and back to where I started! The restrictions have not eased the traffic flow at all in this area and indeed, people are parking in front of the barriers at night and therefore, there would be no access at all for the emergency services. It is unsightly and could possibly be a death trap if the emergency services are unable to access.
Commonside East 6339398	No	Just slows things down; delivery drivers having to drive 1/2 mile out of the way for next delivery, takes me twice as long to get to the local shops or chippy as before, and recently seen lots of cars simply driving through it as one of the posts keeps getting vandalised (unsurprisingly). But still lots of cars an loud bikes driving along the roads, so it isn't really achieving much beyond annoying people.
Commonside East 6339378	No	-
Commonside East 6338398	No	We wasn't consulted said you was putting in and didn't give us a chance to contest. It makes traffic worse. I'm a nurse and can get out of my road to join the main road in the morning and my partner disabled can't even drive him to station or shop I want it taken down and so do all the residents in the woodlands we are all so upset about it. Merton council were very sly how they went about this. Gemma
Grove Road 6339700	Yes	Traffic diverted to near school entrance at St Marks maybe should just have one way
Grove Road 6339677	Yes	It has made Grove Rd safer for residents with less speeding and anti social through traffic. My only concern would be the increase in traffic in Tamworth Lane and the need when return from Mitcham fair green to go this way and the increased congestion. A small price to pay but one that needs monitoring by the council.
Grove Road 6338927	Yes	- There are number of benefits: Reduced road traffic in residential area Saver streets in residential area Better parking for residents / reduced station commuter parking Reduced anti social behaviour e.g. speeding scooters.

6341748		- It has stopped drivers speeding through Spencer Road and Grove Road to cut the corner off their journey. It has reduced traffic and created a safe space for people to walk. I have noticed many more people cycling and walking down Grove Road making use of the new cycle path section that joins the roundabout. There are also some children in Grove Road that have been out cycling in the road which was never previously possible due to the high frequency of drivers that were using Grove Road and Spencer Road as a cut through
Grove Road 6339334	Not sure	I am not sure about the low traffic, the traffic is not a problem to me. I work from home and there are times when I have to pop out in my car, and I find it very annoying that I have to make a longer journey that only takes 5 minutes. I feel a lot of people feel better about traffic control but that really doesn't bother me. I am more concerned about quick fast journeys which saves me a lot of time and effort and petrol. I live on Grove Road and at the top of the road people are always dumping rubbish massive furniture parts and all sorts I will be happy for my street to be cleaned up not to worry about traffic. What about putting a camera there to catch the culprits that would be better for me. Grove Road needs to be cleaner. My preference is to have the road reopened so I have easy access to go to Mitcham town center and other areas Croydon etc, its just ridiculous. And also going to Acacia Road one still get stuck in traffic. It would be good to revert the road as it was.
Grove Road 6339939	No	The blockage has made it difficult to drive in this area. By having to drive via Acacia road and onto the main road where the train barriers of Mitcham eastfields station cause traffic. Furthermore, by reducing the traffic, we have noticed the fly tipping issue at the corner of Grove road (joining onto Spencer road) has become more frequent often resulting in road blockages, and simply a messy corner where rubbish flies around. Despite requests and petitions from the residents to the council to add a camera here to avoid this this had not been actioned. The corner is poorly lit and as it is a blind area, it is not the safest. Previously, traffic would at least deter any wrongdoers.
Grove Road 6339370	No	the diversion in Spencer Road creates more traffic in Cedars Ave
Grove Road 6338466	No	I'm not happy with the changes as there is now only one access through to my road which means I have to sit in the traffic queuing for the eastfield train crossing. Also when I leave my house I'm always caught up in the queuing traffic from the school and train crossing. I think it's causing more traffic on the road where the eastfield train crossing is therefore putting more cars and considerable congestion which has the adverse effect. I would like the scheme to be scrapped.
Grove Road 6339757	No	It has caused increased wait time by 5x its original and has caused traffic to neighbouring roads/areas.
Grove Road 6341172	No	It has caused severe traffic congestion in the surrounding area at busy times. This has caused a great deal of stress to me and my family because we have children who need to get to schools in the mornings. At busy times from the junction of Grove Rd and Commonsides East it can take up to forty minutes to complete the journey home. Before the LTN this would have been a three minute journey along Stanley Rd and Kings Rd. All traffic is now directed to Cedars Avenue and Tamworth Lane where the railway crossing contributes to huge delays. In this aspect the LTNs have surely failed to address climate concerns. Cars sitting in traffic jams for long periods of time generate more pollutants than they would have done. Restrictions on traffic outside St Thomas of Canterbury at the same time as the introduction of the LTN . There is now no safe place to stop to drop off children. As a consequence I have now paid hundreds of pounds in fines because of these two measures. The bollard was removed permanently earlier this year. At the same time that the camera was introduced. This seems to be another cash cow for Merton Council. It is disingenuous to claim that it has been out there to stop vandalism. I have lived in Grove Rd for 15 years and just beyond the field of view of the camera at the end of Grove Rd is a favoured fly tipping spot that has caused great distress for residents over the years and continues to do so, on occasion blocking the road completely. Is this not a form of vandalism? The nature in which this was introduced was not in keeping with democratic rule. The initial notification of the LTN was given with very little notice. It included unsubstantiated claims that it would help with social distancing measures. Please do provide further details of this. The prediction that traffic would evaporate has not

		happened. Traffic did reduce because of lockdown but now the queues are worse than ever. Allow local residents to drive through the LTN ju
Grove Road 6340803	No	Absolutely disgusting to restrict our access. Grove Road was low traffic and low speed traffic road anyway. You are spending our money ( to be precise 5.9% more than last year ) on cameras and planters that don't have any real value apart from making my journey home tortuous. It would be great if I was stay at home mum and walked my child to nursery however I work full time and have to drive. It is particularly pleasant when I bring my tired screaming child back from nursery and the traffic has build up due to the barriers at the station so I have to queue because I can't turn into Acacia Road which I the ONLY entrance to Grove Road!!! You have no care for working families. I am considering moving out as can't keep spending extra 20 to 30 mins a day in traffic due to you decision. Please make me an offer and buy my house for council housing, only pensioners and council housing residents ( who do not work, not the working ones!! Anyone that need to leave the house won't be able to cope with this). I work full time and have young child so that leaves me with very little personal time for rest or development. Selling and moving to reasonable area will give me minimum of 2h per week back, 8h per month which will help me rest more and investment in further qualifications. This ruined my quality of living in the area, if this was in place when I was buying the house I would have NEVER spent my money here!!!
Grove Road 6338656	No	It has caused long delays. With the traffic from the train crossing and schools you have made a mistake doing this. It hasn't stopped fly tippers at all it's just grid locked the whole area I can't do school run as takes too long and long delays getting to work
Grove Road 6339131	No	Rather than low traffic schemes hook a tram link down Red House Road through Wagner's Road and along Commonsides. This would decimate traffic.
Grove Road 6339893	No	As a local resident who lives adjacent to an exit from Mitcham Eastfields station, I believe the scheme to be overall more detrimental to the environment than before. The rat run traffic you are targeting is merely displaced onto Tamworth Lane, Cedars Avenue and Acacia Road. I regularly see traffic chaos at the junction of Tamworth Lane and Acaia Road causing long tailbacks of cars idling and producing excess emissions. When I drive I am forced to travel at least twice the direct route distance and contribute more to the destruction of the environment. A well intentioned scheme that is counter productive and rewards some residents to the detriment of others
Grove Road 6339324	No	This is an obnoxious intrusion into any journey that I make on any given day. Especially to and from work and when i am doing the school run. It forces me to sit in an additional 10 to 15 minutes of traffic breathing in noxious fumes and also contributes to more stationary traffic and increased pollution in the area.
Kings Road 6338467	yes	I think the scheme has benefited the community in terms of air and noise pollution.
Kings Road 6338580 6338578	Yes	- Please keep. - This scheme has reduce the non resident traffic flow and the night racing between chicanes which in turns has stopped residents' car from being hit and damaged
Kings Road 6340410	No	It forces all traffic especially for residents onto the same road as the level crossing which not only takes much longer it blocks the road for long periods. Delivery vans have all taken to reversing (at speed) into our road to avoid going all the way round. Emergency vehicles also being delayed.
Kings Road 6338853	No	Hello I'm on kings road and closing the top of spencer road as you have now means we have to drive in a spiral to get onto this road as the whole thing has been one way for years coursing the traffic to follow the road round and it has worked very well, right up until this was added. now as well as all the added distance we now have to drive just to get home each day the extra traffic that is now pushed onto roads like Tamworth lane and Cedars Ave just to sit there pumping out fumes which seem to me rather counterproductive.
Kings Road 6340680	No	My entire household is against the Low Traffic neighbourhood scheme on Commonsides East. The closure to motor vehicles on the road leading to Spencer Road has caused issues to not being able to access residential area. We have a vulnerable child so access to this road is crucial. In addition, emergency vehicles such firehouse engines and ambulances do not have

		access so this makes it more difficult. There are times when the road is closed off when trains are passing by which can be anywhere from 5 minutes to 30 minutes if there are multiple trains and this also affects access to the commonside east area which is detrimental. When considering this decision, we ask that you take in account the vulnerable persons and residents of Spencer Road and Kings Road. Imposing the low traffic scheme would affect all residents. We hope that you consider the residents and allow the residents to use this road with motor vehicles by issuing permits to those who live on Spenser Road and Kings Road.
Kings Road 6340971	No	i've driven this way to and from home since first started driving 6 years ago and now all of a sudden you cannot go this way putting 25minutes on my journey home. Worst bit is your issuing fixed penalty notices for doing so. Personally i think it's a way of clawing money back for covid it's wrong.
Kings Road 6339117	No	The closure of Commonside East/Grove rd made the traffic on Tamworth Lane even worst then before. It is not only the extreme level of air pollution on Tamworth Lane in area close to St Mark Academy, but on top of that during rush hours is very dangerous in the area close to the level crossing on Tamworth Lane/Mitcham Easfields as because of the huge traffic jam some drivers drive very dangerously, going in the opposite direction line, and that is next to St Mark Academy and so many students crossing the road! I think is just a matter of time for severe accident to happen! If you want to improve the roads in Merton I would suggest invest in building road bridges(for example instead of level crossing next to Mitcham Eastfields station build a bridge for the cars)or tunnels. Closing streets may look like an easy solution but it solve nothing and just causing more traffic jams and increased air pollution!
Kings Road 6339978	No	The scheme has made a huge negative impact on my daily commute to and from work and as a security office manager I have no choice but to drive to and from work. It has put lots of extra time on my commute as well as built up extra traffic causing more pollution. Since the scheme it has made Kings Road very dangerous as now many drivers has been seen driving down the road the wrong way, speeding and reversing down the road which I have reported on many occasions to the police. I also have video evidence of this. Grove Road on the bend by the scheme has also now become a dumping ground from beds, paint pots, rubbish sacks and general waste, which I have also reported. I feel it would be in everyones interest and safety to remove the scheme.
Kings Road 6342958	No	1 a few days after this was introduced, i had a mini stroke and required an ambulance, (twice), and because of this LTN the ambulance took approx 4 minutes longer because it had to turn round and come the long way round, that could have been the difference between life and death, 2 it can now take me twenty minutes to get to my house from commonside east all the way down cedars avenue, and down tamworth lane if the level crossing is down the whole area it gets snarled up,. it can also take ages trying to get out onto tamworth lane from acacia avenue when there are trains due 3 we are now like an estate one way in and one way out 4 it is also an haven for fly tipping at the top of grove road by commonside east it has been a problem but its even worse now 5 lorries still come round from acacia avenue and get stuck down the bottom of spencer road, (i have had to go out and move my car so they can get out through kings road , so the whole LTN , hasn't improved anything but made everything worse,.
Spencer Road 6338858	Yes	Putting in the with restriction at Grove Road/Spencer Road has instantly closed a major rat run in the area. Residents in Spencer Road have been for years having to put up with this intolerable situation. I have over a period of time witnessed many accidents and dangerous driving incidents at the junction of Grove Road/Spencer Road which in my opinion could have been fatal on many occasions. It must by now be obvious to Merton Council that the width restriction is really unpopular with the motorists who for years used this rat run just by the amount of times it was removed by illegal methods. Please please leave the width restriction in place as it is a huge traffic calming benefit for the area and thank you for installing it in the first place.
Spencer Road 6341533	Yes	The road is a lot more quiet. However there a number of vehicles now driving the wrong way down Spencer Road. Generally entering from Kings Road

Spencer Road 6338654	Yes	-
Spencer Road 6338659	Yes	This cuts the traffic to very low, and reducing LOW EMMISION which is even better.
Spencer Road 6338453	Yes	Spencer and Grove Road have been rat runs for years. Vehicles were frequently damaged, pets killed, and numerous near misses, including myself and my lodger. Whereas the camera is now a money maker for Merton, it has not stopped all of the traffic flow. How about using some of the extra money, in addition to the extortionate council tax, and put another camera on the corner of Grove Road into Spencer Rd, which is a continual fly tip. Every day my neighbour goes around collecting rubbish, and reported that corner. What exactly are Merton doing for the money we give you?
Spencer Road 6339847	Yes	Huge success, once the vandalism stopped - less traffic, less pollution, safer road. These are very important given household members have asthma; and I have been run over (minor injuries thankfully) by rat running speeding vehicle and had own cars damaged and written off by rat running speeding vehicles. I use my car less; and accept the minor inconvenience in longer journey when I do use my car - a price well worth paying for the benefits.
Spencer Road 6339741	Yes	The scheme has had lots of benefits and should be made permanent for the following reasons: The area is now significantly safer as it has stopped cars speeding down the road, which is particularly important given the high volume of children that live in the area and the number of children that use the area to access the local park. The Low Traffic Neighbourhood should be kept to keep all of these children safe. It has also significantly reduced pollution which had made the area a much nicer and healthier to live on. It has greatly improved my partners asthma so the scheme should be made permanent for everyones health. It has also cut down noise on the road from cars passing through which makes it much nicer for everyone. Please make it permanent. The scheme has been a great success.
Spencer Road 6339690	Yes	The scheme on our road has made it much safer. It used to be a 'rat run' through to Streatham. but since the barriers have been installed the road is much quieter and safer for families with young children and dog walkers using the local part. It also feels more like a community. As Spencer Road is a narrow road it has made it much easier to park without the pressure of a build of traffic taking a short cut through.
Spencer Road 6338581	Yes	I'm completely in favour of the scheme as it's eliminated a great deal of rat run traffic in Spencer Road. However, Spencer Road still suffers from many drivers at very high speed, as fast as they can go, undeterred by the few narrow sections. This road, in common with EVERY OTHER ROAD in the neighbourhood, requires speed bumps. You'd have to test and measure to believe the speeds achieved. It is highly dangerous and should have been stopped long ago.
Spencer Road 6338522	Yes	The No Entry from Grove Road into Commonsides East could be lifted to one way for access to C/East as at the moment you have to drive down Spencer Road to the end of Acacia Road to turn right into traffic onto Tamworth Lane where a road is opposite and other vehicles are trying to get across or joining traffic onto the main stream, you have traffic waiting to go to Eastfields station, traffic due to Crossing Lights , and traffic waiting to turn right into road you are trying to get out of, it is very dangerous!!
Spencer Road 6338909	Yes	It had been an accident-prone area before the introduction of Low Traffic Neighbourhood on Commonsides East. Now it is a quiet and accident-free area. Effective CVTV will bring about more safety.
Spencer Road 6339950	Yes	It's very good It has made our road safer as it is now not a rat run. Vehicles, mirrors in particular are not getting damaged.
Spencer Road 6338631	Yes	It has made Spencer road a peaceful joy to live in. It has stopped the cars and bikes speeding down the road using it as a rat run. Residents cars were continually being damaged by hit and run drivers. Parking has become easier. It has alleviated Sat Nav's sending lorries down a road that was not suitable for HGV's and they were getting stuck at the Kings Rd end of Spencer Rd. Although there are still cars squeezing through the gap where a pole used to be,



		even though there is camera signs. I did email Merton stating the pole was missing but it has not been replaced. Please keep this traffic calming as it has made our road safe, and we the residents were very concerned that one day there would be an accident. It has not restricted the Emergency services as Ambulances have come down the road. Thank you
Spencer Road 6338657	Yes	-
Spencer Road 6340127	No	Adds unnecessary time on a journey. Pushes all the traffic towards the level crossing and for us only being able to exit via Acacia Rd/Tamworth lane crossroad, causes more issues than needed. Very disappointed we were not consulted about our opinions before it was placed.
Spencer Road 6338456	No	I don't think it is necessary to have this road blocked off, it has caused a lot of traffic issues for residents. I don't believe there was a huge amount of traffic when this road was open and i haven't heard of any accidents so i am not sure why this was even considered. it is a huge inconvenience to residents that i have spoken too
Spencer Road 6338413	No	It puts an extra 20 mins per day on my commute to and from work
Spencer Road 6341780	No	No consultation before putting it in, you have forced more traffic on to main roads, causing more pollution, there are 3 schools very near by, this is not good for the children, the only access is one way very narrow road, deliveries are finding it hard to deliver, only route out to the level crossing road, very difficult, when level is down, road works on this said road, temp lights have been a nightmare, residence should have access to this road. its been done in other boroughs. With the camera, it's just easy money for you, as it has been left open, a trap for many, as the signs are not clear. it has nothing to do with Covid, else other boroughs would not have removed it, in previous correspondence you said 18 myths max why? Please sort this out, as it's caused division with neighbours, police have had to get involved.
Spencer Road 6338599	No	It is an inconvenience I have had to call an ambulance in was horrible waiting time and push more traffic in Mitcham
Spencer Road 6338916	No	Add more traffic to Carers Road and Tamworth Lane adding sometimes half an hour add to journey if the barriers are down at Eastfield Station also a member of the taxi scheme card service which adds more expenses onto an elderly person and add pollution to the area I have lived in Spencer Road for 47 years and had no problem with traffic
Spencer Road 6338411	No	Emergency access to our homes is restricted. Have had to call the police and ambulance before and those extra minutes they take to reach us are crucial. Also haven't really noticed a difference in traffic outside our homes, only very occasionally when the barrier was down by Mitcham Eastfields Station, but it's barely noticeable
Worcester Close 6342649	Yes	Has made life much better with no rat running in Acacia Road although some kind of controlled parking is still needed for railway station traffic using free parking, perhaps even 11-1 daily
Worcester Close 6339031	Yes	I have found the scheme to be a vast improvement on previous arrangements. The route, prior to the closure of Commonsides East, was unsustainable in terms of congestion, pollution and above all road safety. With cars parked both sides of the road and traffic bumper to bumper in either direction which could only move in a single lane has made crossing the road extremely difficult with the addition of cyclists weaving in and out in an attempt to make their way through the traffic. Given the circumstances it was only a matter of time before there was a serious accident. In view of the above the current arrangement has proved to be a very satisfactory solution in all respects and I and my neighbours very much hope that this arrangement will continue.
Worcester Close 6338607	No	I object to LTN because it's going to make traffic jams worse on the main road. Traffic jams with engines on pumps a lot of emissions to the air. Also taking away the opportunity to have road diversions, and I have general concerns of access for emergency services vehicles

Worcester Close 6338579	No	Traffic
Worcester Close 6341025	No	Since the low traffic scheme Tamworth Lane has traffic back up and running engines creating more pollution. My journey from work used to take 10 mins max.... now I frequently wait in traffic 20-30 minutes when the barriers are down. The number of cars turning in my driveway has increased dramatically. It is the pollution that this scheme has caused making people wait so long in congestion that before was not a problem.
Worcester Close 6338409	No	Under this scheme all traffic leaving Kings Road, Spencer Road, Acacia Road, Grove road and Worcester Close is forced to exit into Tamworth Lane causing extreme congestion especially when Eastfields level crossing is closed and during rush hour. This also causes heavier traffic into cedars avenue. In addition, when Tamworth Lane was closed for repair work there was absolute chaos as all traffic had to divert over the level crossing or go towards Streatham. Being able to leave and return via Commonsides East would have alleviated these problems. As there is an ANPR camera now in situ perhaps only residents that have registered their number plates in the aforementioned roads could be allowed through. This also may help to stop possible fly tipping in Grove Road.
Worcester Close 6338408	No	There was no consultation before the closure of the road , the opinions and views of all residents were not taken onto account . This closure causes considerable delay at certain times of the day due to the level crossing and build up of traffic in Tamworth lane. The top of Acacia road is often blocked meaning residents affected by the closure are unable to enter or exit Acacia , the only way to access Worcester Close and the surrounding streets. Residents are using more petrol, more fumes in the air and a lot of time sat in a traffic jam which at times winds around the corner into Cedars Avenue. Very frustrating to have only one entrance and exit and I am concerned if I had a personal emergency that I would not be able to leave.

