



LONDON BOROUGH OF MERTON

AMENDMENTS TO CONTROLLED PARKING ZONES 4F, 5F, CH, GC3, M2, MP1, P1, P2s and RPC CONVERSION OF PARKING PLACES TO WAITING RESTRICTIONS IN VARIOUS ROADS

THE MERTON (PARKING PLACES) (4F) (AMENDMENT NO. 1) ORDER 2021

THE MERTON (PARKING PLACES) (W5 AND 5F) (AMENDMENT NO. 1) ORDER 2021

THE MERTON (PARKING PLACES) (CH) (AMENDMENT NO. 1) ORDER 2021

THE MERTON (PARKING PLACES) (GC3) (AMENDMENT NO. 1) ORDER 2021

THE MERTON (PARKING PLACES) (M1 AND M2) (AMENDMENT NO. 1) ORDER 2021

THE MERTON (PARKING PLACES) (MP1) (AMENDMENT NO. 1) ORDER 2021

THE MERTON (PARKING PLACES) (WIMBLEDON PARK) (NO. 2) (AMENDMENT NO. 1) ORDER 2021

THE MERTON (PARKING PLACES) (RPC) (AMENDMENT NO. 1) ORDER 2021

1. NOTICE IS HEREBY GIVEN that the Council of the London Borough of Merton, on 9 March 2021, made the above mentioned Orders under the powers conferred by sections 45, 46, 49 and 124 of and Part IV of Schedule 9 to the Road Traffic Regulation Act 1984, as amended.
2. The general effect of the Orders will be to convert sections of existing parking places in lengths of roads generally fronting the locations referred to in the Schedule to this notice, to single yellow line waiting restrictions matching the operational times of the controlled parking zone operating at each of those locations to facilitate proposed vehicle crossovers.
3. A copy of each of the Orders, which will come into force on 22 March 2021, and other documents giving more detailed particulars of the Orders, including plans which indicate the roads or lengths of roads to which the Orders relate, can be inspected Mondays to Fridays inclusive during normal office hours at Merton Link, Merton Civic Centre, London Road, Morden, subject to pandemic related closures or on-line at <https://www.merton.gov.uk/streets-parking-transport/traffic-management/consultations>. Alternatively, those without internet access can receive a copy of the documents by post, by phoning 020 8274 4901 or by sending a request to us by post to:- the Environment and Regeneration Department at the Merton Civic Centre, London Road, Morden, Surrey, SM4 5DX. The letter of request should be prominently marked: **ES/CROSSOVER20**.
4. Any person desiring to question the validity of the Orders or of any provision contained therein on the grounds that it is not within the relevant powers of the Road Traffic Regulation Act 1984, or that any of the relevant requirements thereof, or of any relevant regulations made thereunder has not been complied with in relation to the Orders may, within six weeks from the date on which the Orders were made, make application for the purpose to the High Court.

Dated 9 March 2021.

Paul McGarry
Head of futureMerton
London Borough of Merton
Merton Civic Centre,
London Road
Morden Surrey, SM4 5DX

SCHEDULE

Outside (o/s) No. 40 Arundel Avenue, SM4 (CPZ CH)	O/s No. 78 Kenilworth Avenue, SW19 (CPZ P2s)
O/s No. 2 Bristol Road, SM4 (CPZ M2)	O/s No. 50 Kingswood Road, SW19 (CPZ 5F)
O/s No. 85 Circle Gardens, SW19 (CPZ MP1)	O/s No. 22 Pelham Road, SW19 (CPZ 4F)
Amity Grove, adjacent to No. 100 Durham Road, SW20 (CPZ RPC)	O/s No. 24A Pelham Road, SW19 (CPZ 4F)
O/s No. 36 Hill Road, CR4 (CPZ GC3)	O/s No. 98 The Crescent, SW19 (CPZ P1)



LONDON BOROUGH OF MERTON

TRAFFIC MANAGEMENT ORDER

2021 No. 7

The Merton (Parking Places) (4F) (Amendment No. 1) Order 2021

Made: 9 March 2021

Coming into force: 22 March 2021

THE COUNCIL OF THE LONDON BOROUGH OF MERTON, having consulted with the Commissioner for the Metropolitan Police, in exercise of the powers conferred under sections 45, 46, 49 and 124 of, and Part IV of Schedule 9 to, the Road Traffic Regulation Act 1984(a), as amended by Section 8 of and Part 1 of Schedule 5 to the Local Government Act 1985(b), and all other powers, so enabling, hereby make the following Order:-

1. The Order shall come into force on 22 March 2021 and may be cited as the Merton (Parking Places) (4F) (Amendment No. 1) Order 2021.
2. The interpretation Act 1978(c) shall apply for the interpretation of this Order as it applies for the interpretation of an Act of Parliament.
3. Without prejudice to the validity of anything done or to any liability incurred in respect of any act or omission before the coming into operation of this Order, the London Borough of Merton (Parking Places) (4F) (No. 1) Traffic Order 2012(d) shall have effect as though:
 - (a) for paragraph "d" of the item numbered 6 in Schedule 2 to that Order there were substituted the paragraph similarly labelled and set out in column 2 of the Schedule to this Order;
 - (b) there were added to the item numbered 6 in Schedule 2 to that Order the paragraph labelled "da" and set out in column 2 of the Schedule to this Order.

Dated this ninth day March 2021.

PAUL MCGARRY
Head of futureMerton
London Borough of Merton

(a) 1984 c.27 (b) 1985 c.51 (c) 1978 c.30 (d) L.B.M 2012/42 – as amended by L.B.M. 2016/58, 2018/51 and 2019/97.

Published by the London Borough of Merton
Merton Civic Centre
London Road, SM4 5DX

SCHEDULE

1. Item	2. Designated Parking Place	3. Special Manner of Parking
6.	PELHAM ROAD, the south side; (d) from a point in line with the eastern boundary of No. 20 Pelham Road westwards for a distance of 14 metres; (da) from a point 38 metres west of a point in line with the eastern boundary of No. 20 Pelham Road eastward for a distance of 14.5 metres.	- -



LONDON BOROUGH OF MERTON

TRAFFIC MANAGEMENT ORDER

2021 No. 8

The Merton (Parking Places) (W5 and 5F) (Amendment No. 1) Order 2021

Made: 9 March 2021

Coming into force: 22 March 2021

THE COUNCIL OF THE LONDON BOROUGH OF MERTON, having consulted with the Commissioner for the Metropolitan Police, in exercise of the powers conferred by sections 45, 46, 49 and 124 of and Part IV of Schedule 9 to the Road Traffic Regulation Act 1984(a), as amended by Section 8 of and Part 1 of Schedule 5 to the Local Government Act 1985(b), and of all other powers so enabling, hereby make the following Order:-

1. The Order shall come into force on 22 March 2021 and may be cited as the Merton (Parking Places) (W5 and 5F) (Amendment No. 1) Order 2021.
2. The interpretation Act 1978(c) shall apply for the interpretation of this Order as it applies for the interpretation of an Act of Parliament.
3. Without prejudice to the validity of anything done or to any liability incurred in respect of any act or omission before the coming into operation of this Order, the Merton (Parking Places) (W5 and 5F) Traffic Order 2018(d) shall have effect as though:-
 - (a) in column 2 of Part 1 of Schedule 2 to that Order, paragraph "(o)" of item 7 were omitted.

Dated this ninth day of March 2021.

PAUL MCGARRY
Head of futureMerton
London Borough of Merton

(a) 1984 c.27 (b) 1985 c.51 (c) 1978 c.30 (d) L.B.M – as amended
by 2018/16, 2018/133, 2019/9, 2019/102, 2019/139, 2020/104 and 2020/110.

Published by the London Borough of Merton
Merton Civic Centre
London Road, SM4 5DX



LONDON BOROUGH OF MERTON

TRAFFIC MANAGEMENT ORDER

2021 No. 9

The Merton (Parking Places) (CH) (Amendment No. 1) Order 2021

Made: 9 March 2021

Coming into force: 22 March 2021

THE COUNCIL OF THE LONDON BOROUGH OF MERTON, having consulted with the Commissioner for the Metropolitan Police, in exercise of the powers conferred by sections 45, 46, 49 and 124 of and Part IV of Schedule 9 to the Road Traffic Regulation Act 1984(a), as amended by Section 8 of and Part 1 of Schedule 5 to the Local Government Act 1985(b), and of all other powers so enabling, hereby make the following Order:-

1. The Order shall come into force on 22 March 2022 and may be cited as the Merton (Parking Places) (CH) (Amendment No. 1) Order 2021.
2. The interpretation Act 1978(c) shall apply for the interpretation of this Order as it applies for the interpretation of an Act of Parliament.
3. Without prejudice to the validity of anything done or to any liability incurred in respect of any act or omission before the coming into operation of this Order, the Merton (Parking Places) (CH) Order 2019(d) shall have effect as though:-
 - (a) there were substituted for the item numbered 17 in Schedule 2 to that Order, the item similarly numbered and set out in columns 1, 2, 3 and 4 of the Schedule to this Order.

Dated this ninth day of March 2021.

PAUL MCGARRY
Head of futureMerton
London Borough of Merton

(a) 1984 c.27

(b) 1985 c.51

(c) 1978 c.30

(d) L.B.M 2019/90.

SCHEDULE

1. Item No.	2. Designated Parking Place	3. Maximum number of spaces	4. Special manner of parking
17.	Arundel Avenue , the south-west side, from the common boundary of Nos. 38 and 40 south-westward for a distance of 5 metres.	1	-



LONDON BOROUGH OF MERTON
TRAFFIC MANAGEMENT ORDER

2021 No. 10

The Merton (Parking Places) (GC3) (Amendment No. 1) Order 2021

Made: 9 March 2021

Coming into force: 22 March 2021

THE COUNCIL OF THE LONDON BOROUGH OF MERTON, having consulted with the Commissioner for the Metropolitan Police, in exercise of the powers conferred by sections 45, 46, 49 and 124 of and Part IV of Schedule 9 to the Road Traffic Regulation Act 1984(a), as amended by Section 8 of and Part 1 of Schedule 5 to the Local Government Act 1985(b), and all other powers, so enabling, hereby make the following Order:-

1. This Order shall come into force on 22 March 2021 and may be cited as the Merton (Parking Places) (GC3) (Amendment No. 1) Order 2021.
2. Without prejudice to the validity of anything done or to any liability incurred in respect of any act or omission before the coming into operation of this Order, the Merton (Parking Places) (GC3) Order 2020(c) shall have effect as though:-
 - (a) the item numbered 126 were omitted from Schedule 2 to that Order.

Dated this ninth day of March 2021.

PAUL MCGARRY
Head of futureMerton
London Borough of Merton

(a) 1984 c.27 (b) 1985 c.51 (c) L.B.M 2020/64

Published by the London Borough of Merton
Merton Civic Centre
London Road, SM4 5DX



LONDON BOROUGH OF MERTON

TRAFFIC MANAGEMENT ORDER

2021 No. 11

The Merton (Parking Places) (M1 and M2) (Amendment No. 1) Order 2021

Made: 9 March 2021

Coming into force: 22 March 2021

THE COUNCIL OF THE LONDON BOROUGH OF MERTON, having consulted with the Commissioner for the Metropolitan Police, in exercise of the powers conferred by sections 45, 46, 49 and 124 of and Part IV of Schedule 9 to the Road Traffic Regulation Act 1984(a), as amended by Section 8 of and Part 1 of Schedule 5 to the Local Government Act 1985(b), and of all other powers so enabling, hereby make the following Order:-

1. The Order shall come into force on 22 March 2021 and may be cited as the Merton (Parking Places) (M1 and M2) (Amendment No. 1) Order 2021.
2. The interpretation Act 1978(c) shall apply for the interpretation of this Order as it applies for the interpretation of an Act of Parliament.
3. Without prejudice to the validity of anything done or to any liability incurred in respect of any act or omission before the coming into operation of this Order, the London Borough of Merton (Parking Places) (M1 and M2) (No. 1) Traffic Order 2012(d) shall have effect as though:-
 - (a) for paragraph “f)” of the item numbered 10 in Part 2 of Schedule 2 to that Order were substituted the following:

“f) from a point 5.0 metres north-west of the common boundary wall of properties Nos. 6 and 8 Bristol Road, south-eastward for a distance of 17 metres;”
 - (b) there were added as paragraph “ff)” of the item numbered 10 in Part 2 of Schedule 2 to that Order the following:-

“ff) from a point 13.2 metres north-west of the north-western kerb-line of St Helier Avenue north-westward for a distance of 10.8 metres;”

(a) 1984 c.27 (b) 1985 c.51 (c) 1978 c.30 (d) L.B.M 2012/46 – as amended by 2016/11, 2016/45, 2016/67, 2016/83, 2017/44, 2017/120, 2018/9, 2018/33, 2018/77, 2018/99, 2019/7, 2019/117, 2020/21, 2020/99 and 2020/105.

Dated this ninth day of March 2021.

A handwritten signature in black ink, appearing to read 'P. McGarry', with a long, sweeping underline that extends to the right.

PAUL MCGARRY
Head of futureMerton
London Borough of Merton



LONDON BOROUGH OF MERTON
TRAFFIC MANAGEMENT ORDER

2021 No. 12

The Merton (Parking Places) (RPC) (Amendment No. 1) Order 2021

Made: 9 March 2021

Coming into force: 22 March 2021

THE COUNCIL OF THE LONDON BOROUGH OF MERTON, having consulted with the Commissioner for the Metropolitan Police, in exercise of the powers conferred by sections 45, 46, 49 and 124 of and Part IV of Schedule 9 to the Road Traffic Regulation Act 1984(a), as amended by Section 8 of and Part 1 of Schedule 5 to the Local Government Act 1985(b), and all other powers, so enabling, hereby make the following Order:-

1. This Order shall come into force on 22 March 2021 and may be cited as the Merton (Parking Places) (RPC) (Amendment No. 1) Order 2021.
2. Without prejudice to the validity of anything done or to any liability incurred in respect of any act or omission before the coming into operation of this Order, the London Borough of Merton (Parking Places) (RPC) Order 2018(c) shall have effect as though:
 - (a) for the item numbered 8 in Schedule 2 to that Order there were substituted the item similarly numbered and set out in columns 1, 2, 3 and 4 of the Schedule to this Order.

Dated this ninth day of March 2021.

A handwritten signature in black ink, appearing to read "Paul McGarry".

PAUL MCGARRY
Head of futureMerton
London Borough of Merton

(a) 1984 c.27 (b) 1985 c.51 (c) L.B.M 2018/128 – as amended by L.B.M 2019/119, 2019/143, 2020/1 and 2020/94.

Published by the London Borough of Merton
Merton Civic Centre
London Road, SM4 5DX

SCHEDULE

1. Item	2. Designated Parking Place	3. Maximum number of spaces	4. Special Manner of Parking
8.	AMITY GROVE, the north side, from a point 9.8 metres east of the eastern kerb-line of Durham Road eastward for a distance of 14.1 metres.	3	-



LONDON BOROUGH OF MERTON

TRAFFIC MANAGEMENT ORDER

2021 No. 13

The Merton (Parking Places) (Wimbledon Park) (No. 2) (Amendment No. 1) Order 2021

Made: 9 March 2021

Coming into force: 22 March 2021

THE COUNCIL OF THE LONDON BOROUGH OF MERTON, having consulted with the Commissioner for the Metropolitan Police, in exercise of the powers conferred by sections 45, 46, 49 and 124 of and Part IV of Schedule 9 to the Road Traffic Regulation Act 1984(a), as amended by Section 8 of and Part 1 of Schedule 5 to the Local Government Act 1985(b), and of all other powers so enabling, hereby make the following Order:-

1. The Order shall come into force on 22 March 2021 and may be cited as the Merton (Parking Places) (Wimbledon Park) (No. 2) (Amendment No. 1) Order 2021.
2. The interpretation Act 1978(c) shall apply for the interpretation of this Order as it applies for the interpretation of an Act of Parliament.
3. Without prejudice to the validity of anything done or to any liability incurred in respect of any act or omission before the coming into operation of this Order, the London Borough of Merton (Parking Places) (Wimbledon Park) (No. 2) Traffic Order 2012(d) shall have effect as though:-
 - (a) for paragraph “(f)” of the item numbered 1 in column 2 of Part 4 of Schedule 3 to that Order there were substituted the paragraph “(f)” set out in Schedule 1 to this Order; and
 - (b) there were added to column 2 of the item numbered 1 in Part 4 of Schedule 3 to that Order the paragraph “(ff)” set out in Schedule 1 to this Order;
 - (c) for paragraph “(d)” of item 6 of Part 3 of Schedule 2 to that Order there were substituted the paragraph “(d)” set out in Schedule 2 to this Order;
 - (d) there were added to column 2 of the item numbered 6 in Part 3 of Schedule 2 to that Order the paragraphs “(da)” and “(db)” set out in Schedule 2 to this Order.

Dated this ninth day of March 2021.

PAUL MCGARRY
Head of futureMerton
London Borough of Merton

(a) 1984 c.27 (b) 1985 c.51 (c) 1978 c.30 (d) L.B.M 2012/43 – as amended.

SCHEDULE 1

- (f) from a point 36 metres south of the southern kerb-line of Arthur Road southward for a distance of 26.60 metres;
- (ff) from a point 0.6 metres north of a point opposite the northern kerb-line of Crescent Gardens southward for a distance of 50 metres;

SCHEDULE 2

- (d) from a point 1.0 metre north-east of the common boundary of Nos. 88 and 90 Kenilworth Avenue, south-westward for a distance of 10.5 metres;
- (da) from a point 0.3 metre south-west of a point in line of the south-west flank wall of No. 84 Kenilworth Avenue south-westward for to a 0.4 metre north-east of a point in line with the north-east flank wall of No. 78 Kenilworth Avenue;
- (db) from a point 0.8 metre north-east of a point in line with the common boundary of Nos. 76 and 78 Kenilworth Avenue south-westward for a distance of 8.8 metres;



LONDON BOROUGH OF MERTON

TRAFFIC MANAGEMENT ORDER

2021 No. 14

The Merton (Parking Places) (MP1) (Amendment No. 1) Order 2021

Made: 9 March 2021

Coming into force: 22 March 2021

The Council of the London Borough Of Merton, having consulted with the Commissioner for the Metropolitan Police, in exercise of the powers conferred by sections 6, 45, 46, 49 and 124 of and Part IV of Schedule 9 to the Road Traffic Regulation Act 1984(a), as amended by Section 8 of and Part 1 of Schedule 5 to the Local Government Act 1985(b), and all other powers, so enabling, hereby make the following Order:-

1. This Order shall come into force on 22 March 2021 and may be cited the Merton (Parking Places) (MP1) (Amendment No. 1) Order 2021.
2. Without prejudice to the validity of anything done or to any liability incurred in respect of any act or omission before the coming into operation of this Order, the London Borough of Merton (Parking Places) (MP1) Traffic Order 2003(c) shall have effect as though:-
 - (a) for the item numbered 73 in Schedule 2 to that Order there were there were substituted the item similarly numbered and set out in columns 1, 2 and 3 of the Schedule to this Order.

Dated this ninth day of March 2021.

Paul McGarry
Head of futureMerton
London Borough of Merton

(a) 1984 c.27 (b) 1985 c.51 (c) L.B.M 2003/20 as amended by L.B.M. 2004/45, 2005/5, 2005/28, 2009/10, 2009/44, 2010/42, 2016/41, 2016/84, 2017/46, 2017/65, 2017/92, 2017/121, 2018/10, 2018/43, 2018/72, 2018/78, 2019/49, 2019/99, 2019/108, 2019/118, 2019/128, 2020/66 and 2020/100.

SCHEDULE

1. Item No.	2. Designated Parking Place	3. Maximum number of spaces	4. Special Manner of Standing
73.	Circle Gardens – Outer kerb-line from a point 14.0 metres south-west of the western kerb-line of Poplar Road at its northern-most junction with Circle Gardens, south-westward for a distance of 5 metres.	1	—



LONDON BOROUGH OF MERTON

**AMENDMENTS TO CONTROLLED PARKING ZONES 4F, 5F, CH, GC3, M2, MP1, P1, P2s and RPC
PROPOSED CONVERSION OF PARKING PLACES TO WAITING RESTRICTIONS IN VARIOUS ROADS**

THE MERTON (PARKING PLACES) (4F) (AMENDMENT NO. *) ORDER 202*
THE MERTON (PARKING PLACES) (W5 AND 5F) (AMENDMENT NO. *) ORDER 202*

THE MERTON (PARKING PLACES) (CH) (AMENDMENT NO. *) ORDER 202*

THE MERTON (PARKING PLACES) (GC3) (AMENDMENT NO. *) ORDER 202*

THE MERTON (PARKING PLACES) (M1 AND M2) (AMENDMENT NO. *) ORDER 202*

THE MERTON (PARKING PLACES) (MP1) (AMENDMENT NO. 1) ORDER 2020

THE MERTON (PARKING PLACES) (WIMBLEDON PARK) (NO. 2) (AMENDMENT NO. *) ORDER 202*

THE MERTON (PARKING PLACES) (RPC) (AMENDMENT NO. 2) ORDER 2020

1. NOTICE IS HEREBY GIVEN that the Council of the London Borough of Merton under the powers conferred by sections 45, 46, 49 and 124 of and Part IV of Schedule 9 to the Road Traffic Regulation Act 1984, as amended, propose to make the above mentioned Orders.
2. The general effect of the Orders would be to convert sections of existing parking places in lengths of roads generally fronting the locations referred to in the Schedule to this notice, to single yellow line waiting restrictions matching the operational times of the controlled parking zone operating at each of those locations to facilitate proposed vehicle crossovers.
3. A copy of each of the proposed Orders and other documents giving more detailed particulars of the Orders, including plans which indicate the roads or lengths of roads to which the Orders relate, can be inspected, subject to closures due to the pandemic, Mondays to Fridays during normal office hours at Merton Link, Merton Civic Centre, London Road, Morden. The documents are also available for inspection at <https://www.merton.gov.uk/streets-parking-transport/traffic-management/consultations>. Alternatively, those without internet access can receive a copy of the document by post, by phoning 020 8274 4901 or by sending a request to us by post to:- the Environment and Regeneration Department at the Merton Civic Centre, London Road, Morden, Surrey, SM4 5DX. The letter of request should be prominently marked: ES/CROSSOVER20.
4. Any person desiring to comment on the proposed Orders should send a statement in writing of their representations or objections and the grounds thereof, to the Environment and Regeneration Department at the Merton Civic Centre, London Road, Morden, Surrey, SM4 5DX, or alternatively by email to trafficandhighways@merton.gov.uk quoting reference **ES/CROSSOVER20** no later than 19 February 2021.

Dated 28 January 2021.

Paul McGarry
Head of futureMerton
London Borough of Merton
Merton Civic Centre,
London Road
Morden Surrey, SM4 5DX

SCHEDULE

Outside (o/s) No. 40 Arundel Avenue, SM4 (CPZ CH)	O/s No. 78 Kenilworth Avenue, SW19 (CPZ P2s)
O/s No. 2 Bristol Road, SM4 (CPZ M2)	O/s No. 50 Kingswood Road, SW19 (CPZ 5F)
O/s No. 85 Circle Gardens, SW19 (CPZ MP1)	O/s No. 22 Pelham Road, SW19 (CPZ 4F)
Amity Grove, adjacent to No. 100 Durham Road, SW20 (CPZ RPC)	O/s No. 24A Pelham Road, SW19 (CPZ 4F)
O/s No. 36 Hill Road, CR4 (CPZ GC3)	O/s No. 98 The Crescent, SW19 (CPZ P1)

LONDON BOROUGH OF MERTON

AMENDMENTS TO CONTROLLED PARKING ZONES 4F, 5F, CH, GC3, M2, MP1, P1, P2s and RPC PROPOSED CONVERSION OF PARKING PLACES TO WAITING RESTRICTIONS IN VARIOUS ROADS

THE MERTON (PARKING PLACES) (4F) (AMENDMENT NO. *) ORDER 202*

THE MERTON (PARKING PLACES) (W5 AND 5F) (AMENDMENT NO. *) ORDER 202*

THE MERTON (PARKING PLACES) (CH) (AMENDMENT NO. *) ORDER 202*

THE MERTON (PARKING PLACES) (GC3) (AMENDMENT NO. *) ORDER 202*

THE MERTON (PARKING PLACES) (M1 AND M2) (AMENDMENT NO. *) ORDER 202*

THE MERTON (PARKING PLACES) (MP1) (AMENDMENT NO. 1) ORDER 2020

THE MERTON (PARKING PLACES) (WIMBLEDON PARK) (NO. 2) (AMENDMENT NO. *) ORDER 202*

THE MERTON (PARKING PLACES) (RPC) (AMENDMENT NO. 2) ORDER 2020

STATEMENT OF REASONS

(A brief statement of the general nature and effect of the Orders)

Parking Places Amendments

The proposals are to amend and remove designated parking places to accommodate the introduction of crossovers at various locations.

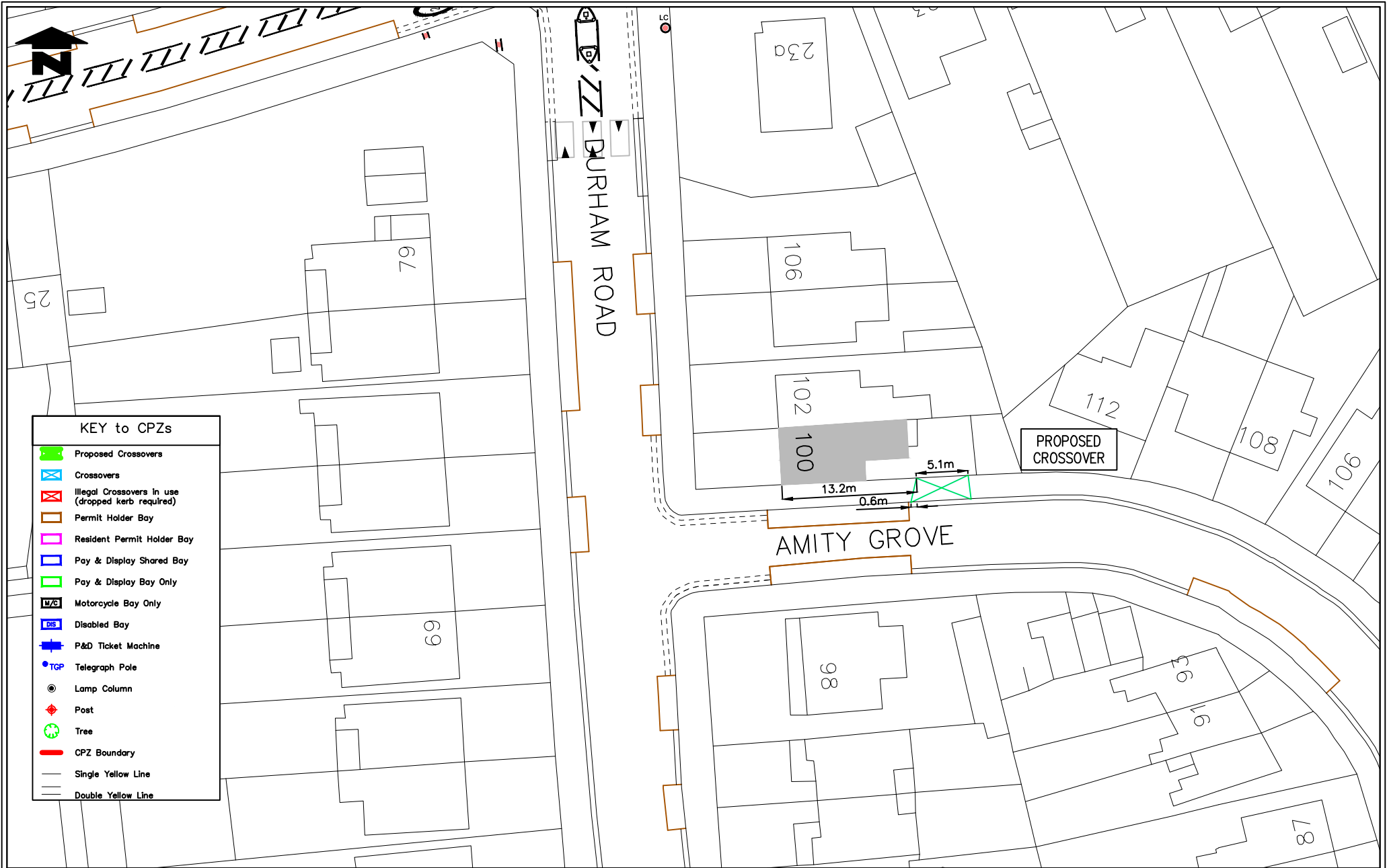

KEY to CPZs	
	Proposed Crossovers
	Crossovers
	Illegal Crossovers in use (dropped kerb required)
	Permit Holder Bay
	Resident Permit Holder Bay
	Pay & Display Shared Bay
	Pay & Display Bay Only
	Motorcycle Bay Only
	Disabled Bay
	P&D Ticket Machine
	Telegraph Pole
	Lamp Column
	Post
	Tree
	CPZ Boundary
	Single Yellow Line
	Double Yellow Line

Notes
Do not scale from this drawing

Rev	Revisions	Drawn	Sig	Date	Checked	Sig	Date	App.	Sig	Date

Future Merton
environment & regeneration

TRAFFIC & HIGHWAYS

Reproduced from/based upon the Ordnance Survey's 1:1250 maps with the permission of the Controller of H.M.S.O. Crown Copyright Reserved. Unauthorised reproduction infringes Crown copyright and may lead to prosecution or civil proceedings. London Borough of Merton 100016230

Drawn by TJ	Sig	Date 13-01-21
Checked by	Sig	Date
Approved by	Sig	Date

PROJECT
Controlled Parking Zones
5823

TITLE
100 DURHAM ROAD
SW20 0TL

merton

Merton Civic Centre
London Road
Morden, Surrey
SM4 5DX
www.merton.gov.uk

Drawing No.	5823
Revision	-
Classification	APPLICATION
Scale	1: 500

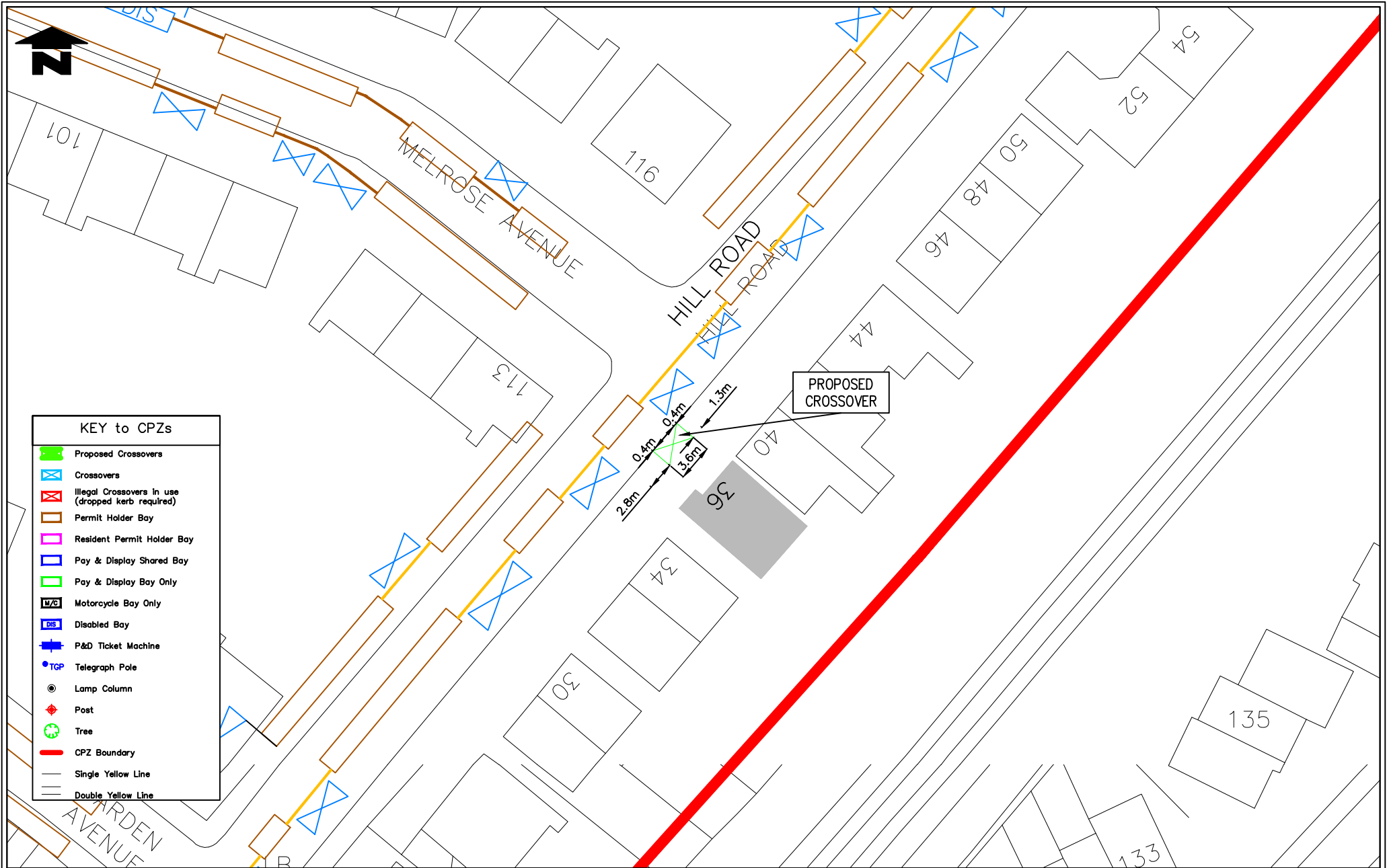

KEY to CPZs	
	Proposed Crossovers
	Crossovers
	Illegal Crossovers in use (dropped kerb required)
	Permit Holder Bay
	Resident Permit Holder Bay
	Pay & Display Shared Bay
	Pay & Display Bay Only
	Motorcycle Bay Only
	Disabled Bay
	P&D Ticket Machine
	Telegraph Pole
	Lamp Column
	Post
	Tree
	CPZ Boundary
	Single Yellow Line
	Double Yellow Line

Notes
Do not scale from this drawing

Rev	Revisions	Drawn	Sig	Date	Checked	Sig	Date	App.	Sig	Date

TRAFFIC & HIGHWAYS

Reproduced from/based upon the Ordnance Survey's 1:1250 maps with the permission of the Controller of H.M.S.O. Crown Copyright Reserved. Unauthorised reproduction infringes Crown copyright and may lead to prosecution or civil proceedings.
London Borough of Merton 100016250

Drawn by TJ	Sig	Date 15-01-21
Checked by	Sig	Date
Approved by	Sig	Date

PROJECT
Controlled Parking Zones
6043

TITLE
36 HILL ROAD
CR4 2HQ

Merton Civic Centre
London Road
Morden, Surrey
SM4 5DX
www.merton.gov.uk

Drawing No.	6043
Revision	-
Classification	APPLICATION
Scale	1: 500



KEY to CPZs	
	Proposed Crossovers
	Crossovers
	Illegal Crossovers in use (dropped kerb required)
	Permit Holder Bay
	Resident Permit Holder Bay
	Pay & Display Shared Bay
	Pay & Display Bay Only
	Motorcycle Bay Only
	Disabled Bay
	P&D Ticket Machine
	Telegraph Pole
	Lamp Column
	Post
	Tree
	CPZ Boundary
	Single Yellow Line
	Double Yellow Line

Notes
Do not scale from this drawing

Rev	Revisions	Drawn	Sig	Date	Chkd	Sig	Date	App	Sig	Date

TRAFFIC & HIGHWAYS

Reproduced from/based upon the Ordnance Survey's 1:1250 maps with the permission of the Controller of H.M.S.O., Crown Copyright Reserved. Unauthorised reproduction infringes Crown copyright and may lead to prosecution or civil proceedings.
London Borough of Merton 100016250

Drawn by TJ	Sig	Date 18-01-21
Checked by	Sig	Date
Approved by	Sig	Date

PROJECT Controlled Parking Zones 6177	TITLE 98 THE CRESENT SW19 8DR
---	-------------------------------------

Merton Civic Centre
London Road
Morden, Surrey
SM4 5DX
www.merton.gov.uk

Drawing No. 6177	Revision
Classification APPLICATION	Scale 1: 500

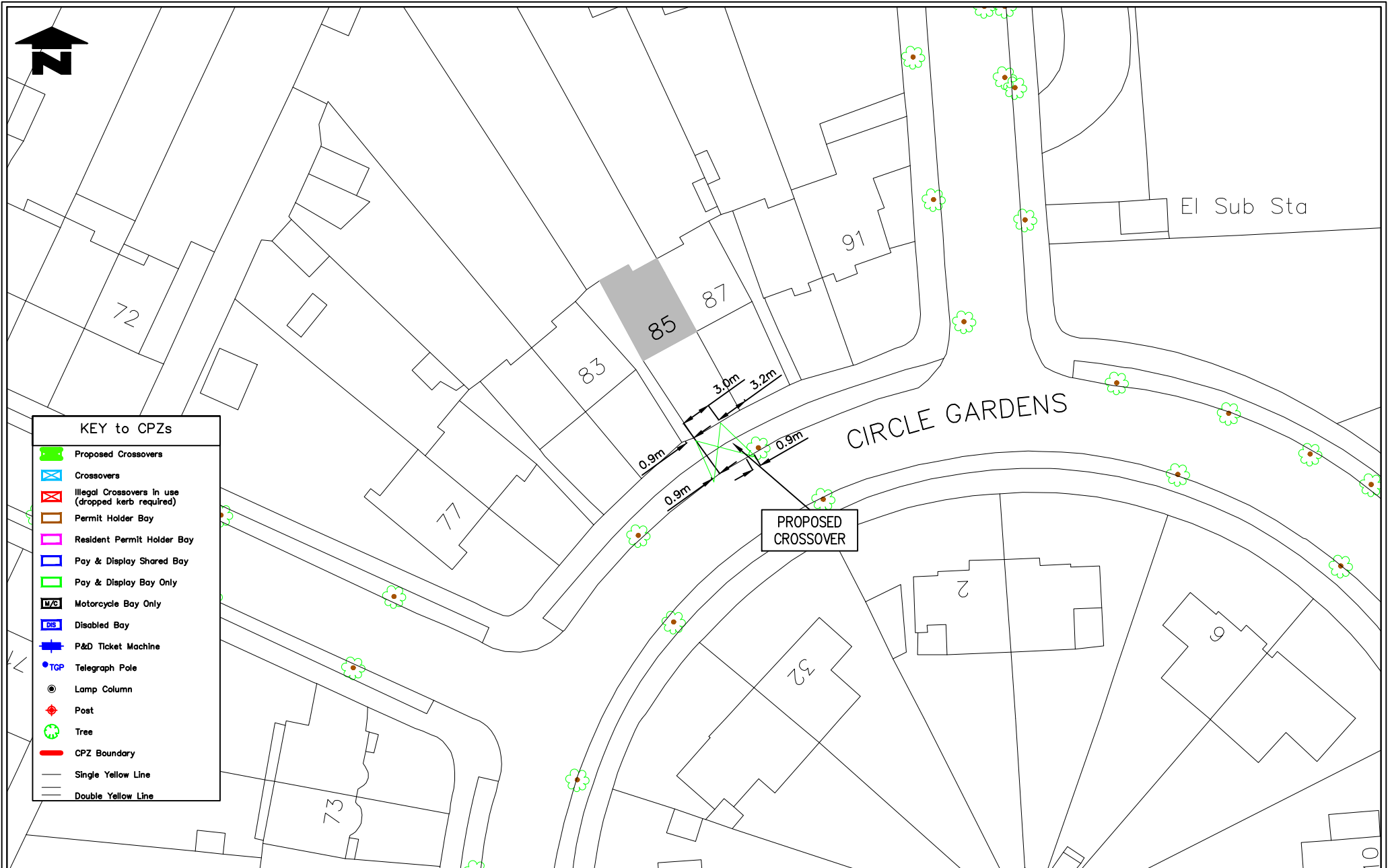

KEY to CPZs

- Proposed Crossovers
- Crossovers
- Illegal Crossovers in use (dropped kerb required)
- Permit Holder Bay
- Resident Permit Holder Bay
- Pay & Display Shared Bay
- Pay & Display Bay Only
- Motorcycle Bay Only
- Disabled Bay
- P&D Ticket Machine
- Telegraph Pole
- Lamp Column
- Post
- Tree
- CPZ Boundary
- Single Yellow Line
- Double Yellow Line

Notes
Do not scale from this drawing

Rev	Revisions	Drawn	Sig	Date	Checked	Sig	Date	App.	Sig	Date

TRAFFIC & HIGHWAYS

Reproduced from/based upon the Ordnance Survey's 1:1250 maps with the permission of the Controller of H.M.S.O. Crown Copyright Reserved. Unauthorised reproduction infringes Crown copyright and may lead to prosecution or civil proceedings. London Borough of Merton 100016250

Drawn by TJ	Sig	Date 14-01-21
Checked by	Sig	Date
Approved by	Sig	Date

PROJECT
**Controlled Parking Zones
7121**

TITLE
**85 CIRCLE GARDENS
SW19 3JT**

Merton Civic Centre
London Road
Morden, Surrey
SM4 5DX
www.merton.gov.uk

Drawing No.	7121
Revision	-
Classification	APPLICATION
Scale	1: 500

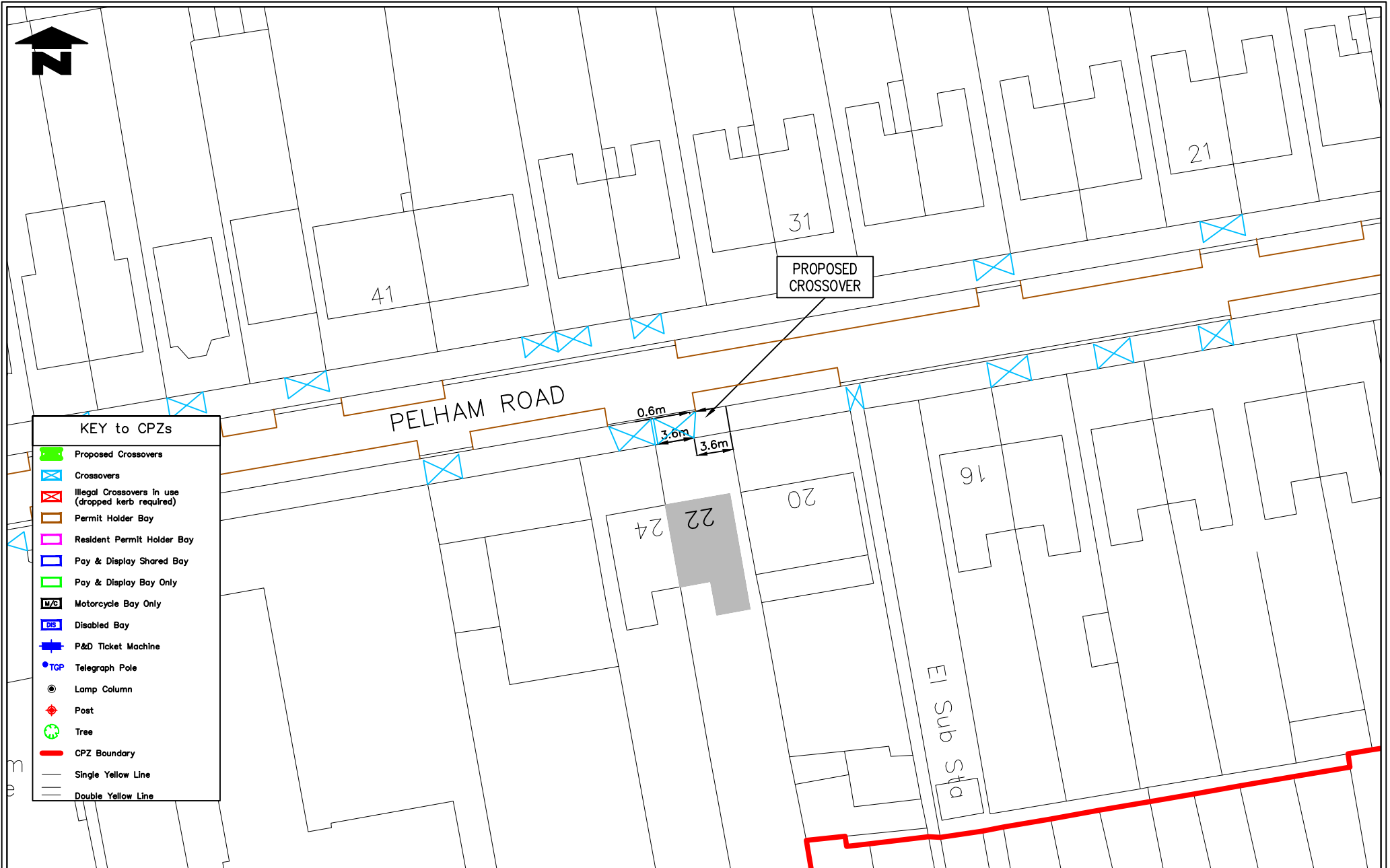

KEY to CPZs	
	Proposed Crossovers
	Crossovers
	Illegal Crossovers in use (dropped kerb required)
	Permit Holder Bay
	Resident Permit Holder Bay
	Pay & Display Shared Bay
	Pay & Display Bay Only
	Motorcycle Bay Only
	Disabled Bay
	P&D Ticket Machine
	Telegraph Pole
	Lamp Column
	Post
	Tree
	CPZ Boundary
	Single Yellow Line
	Double Yellow Line

Notes
Do not scale from this drawing

Rev	Revisions	Drawn	Sig	Date	Checked	Sig	Date	App.	Sig	Date

Future Merton environment & regeneration

TRAFFIC & HIGHWAYS

Reproduced from/based upon the Ordnance Survey's 1:1250 maps with the permission of the Controller of H.M.S.O., Crown Copyright Reserved. Unauthorised reproduction infringes Crown copyright and may lead to prosecution or civil proceedings.
London Borough of Merton 100016250

Drawn by TJ	Sig	Date 14-01-21
Checked by	Sig	Date
Approved by	Sig	Date

PROJECT
Controlled Parking Zones
7148

TITLE
22 PELHAM ROAD
SW19 1SX

merton

Merton Civic Centre
London Road
Morden, Surrey
SM4 5DX
www.merton.gov.uk

Drawing No.	7148
Revision	-
Classification	APPLICATION
Scale	1: 500



KEY to CPZs

- Proposed Crossovers
- Crossovers
- Illegal Crossovers in use (dropped kerb required)
- Permit Holder Bay
- Resident Permit Holder Bay
- Pay & Display Shared Bay
- Pay & Display Bay Only
- Motorcycle Bay Only
- Disabled Bay
- P&D Ticket Machine
- Telegraph Pole
- Lamp Column
- Post
- Tree
- CPZ Boundary
- Single Yellow Line
- Double Yellow Line

Notes
Do not scale from this drawing

Rev	Revisions	Drawn	Sig	Date	Chkd	Sig	Date	App	Sig	Date

TRAFFIC & HIGHWAYS

Reproduced from/based upon the Ordnance Survey's 1:1250 maps with the permission of the Controller of H.M.S.O. Crown Copyright Reserved. Unauthorised reproduction infringes Crown copyright and may lead to prosecution or civil proceedings. London Borough of Merton 100016250

Drawn by TJ	Sig	Date 18-01-21
Checked by	Sig	Date
Approved by	Sig	Date

PROJECT
**Controlled Parking Zones
7458**

TITLE
**8 KENILWORTH AVENUE
SW19 7LR**

Merton Civic Centre
London Road
Morden, Surrey
SM4 5DX
www.merton.gov.uk

Drawing No.	7458
Revision	-
Classification	APPLICATION
Scale	1: 500

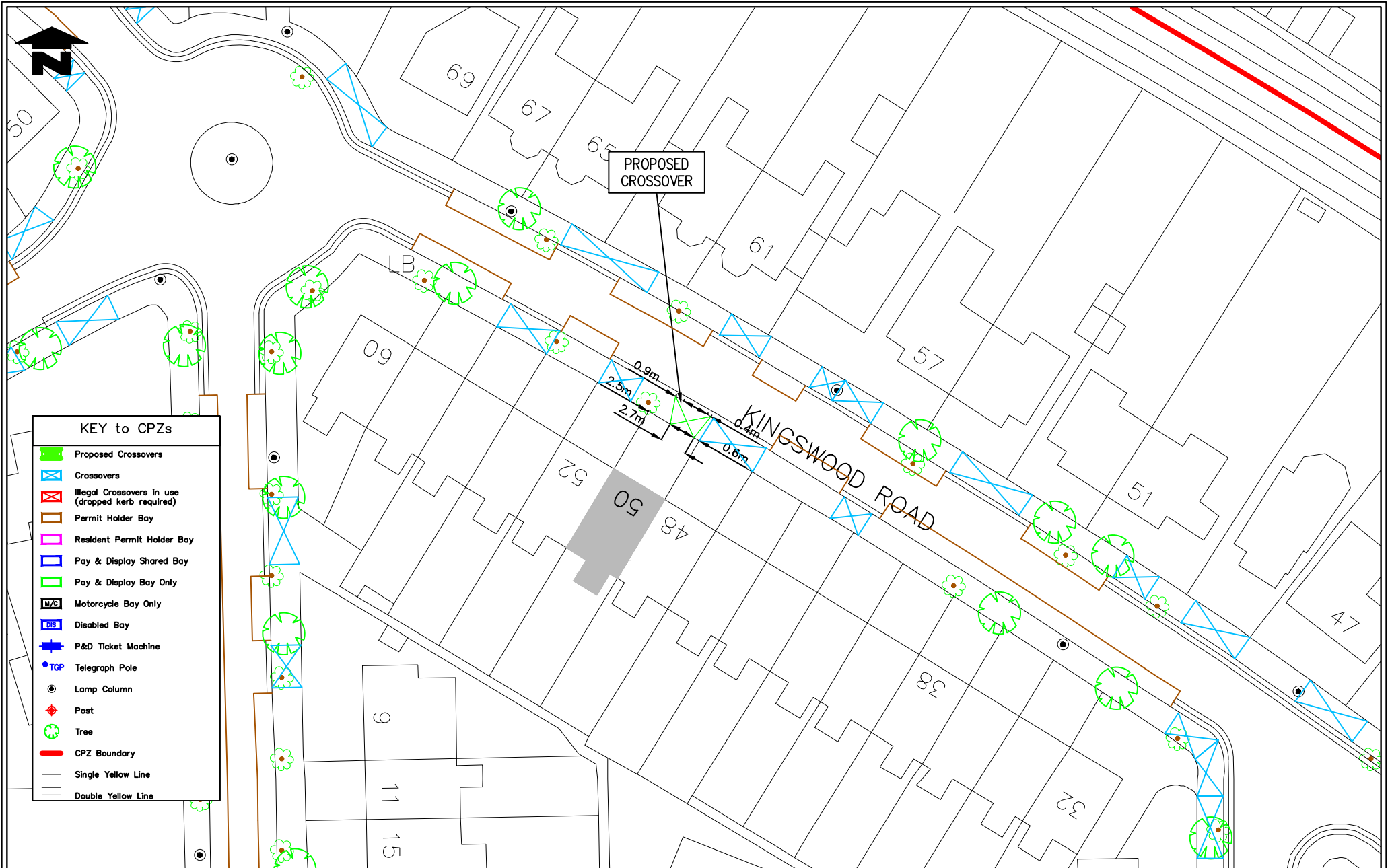

KEY to CPZs	
	Proposed Crossovers
	Crossovers
	Illegal Crossovers in use (dropped kerb required)
	Permit Holder Bay
	Resident Permit Holder Bay
	Pay & Display Shared Bay
	Pay & Display Bay Only
	Motorcycle Bay Only
	Disabled Bay
	P&D Ticket Machine
	Telegraph Pole
	Lamp Column
	Post
	Tree
	CPZ Boundary
	Single Yellow Line
	Double Yellow Line

Notes
Do not scale from this drawing

Rev	Revisions	Drawn	Sig	Date	Checked	Sig	Date	App.	Sig	Date

Future Merton

 environment & regeneration

TRAFFIC & HIGHWAYS

Reproduced from/based upon the Ordnance Survey's 1:1250 maps with the permission of the Controller of H.M.S.O. Crown Copyright Reserved. Unauthorised reproduction infringes Crown copyright and may lead to prosecution or civil proceedings. London Borough of Merton 100016250

Drawn by TJ	Sig.	Date 15-01-21
Checked by	Sig.	Date
Approved by	Sig.	Date

PROJECT Controlled Parking Zones 7807
TITLE 50 KINGSWOOD ROAD SW19 3NE

merton

 Merton Civic Centre
 London Road
 Morden, Surrey
 SM4 5DX
 www.merton.gov.uk

Drawing No. 7807
Revision
Classification APPLICATION
Scale 1: 500

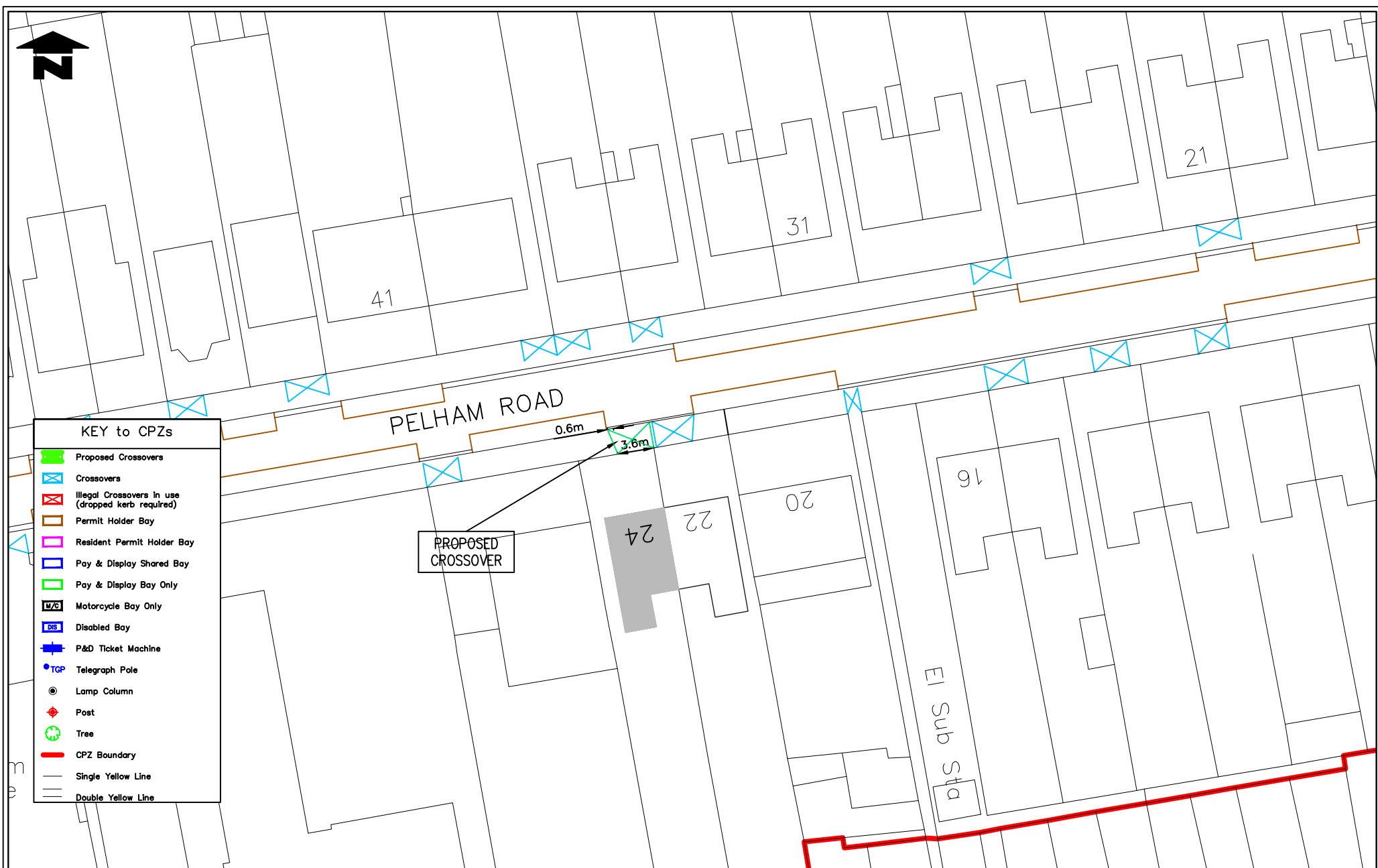

KEY to CPZs

- Proposed Crossovers
- Crossovers
- Illegal Crossovers in use (dropped kerb required)
- Permit Holder Bay
- Resident Permit Holder Bay
- Pay & Display Shared Bay
- Pay & Display Bay Only
- Motorcycle Bay Only
- Disabled Bay
- P&D Ticket Machine
- Telegraph Pole
- Lamp Column
- Post
- Tree
- CPZ Boundary
- Single Yellow Line
- Double Yellow Line

Notes
Do not scale from this drawing

Rev	Revisions	Drawn	Sig	Date	Chkd	Sig	Date	App	Sig	Date

TRAFFIC & HIGHWAYS

Reproduced from/based upon the Ordnance Survey's 1:1250 maps with the permission of the Controller of H.M.S.O., Crown Copyright Reserved. Unauthorised reproduction infringes Crown copyright and may lead to prosecution or civil proceedings.
London Borough of Merton 100016250

Drawn by TJ	Sig	Date 14-01-21
Checked by	Sig	Date
Approved by	Sig	Date

PROJECT
**Controlled Parking Zones
7148**

TITLE
**24A PELHAM ROAD
SW19 1SX**

Merton Civic Centre
London Road
Morden, Surrey
SM4 5DX
www.merton.gov.uk

Drawing No.	7872
Revision	-
Classification	APPLICATION
Scale	1: 500

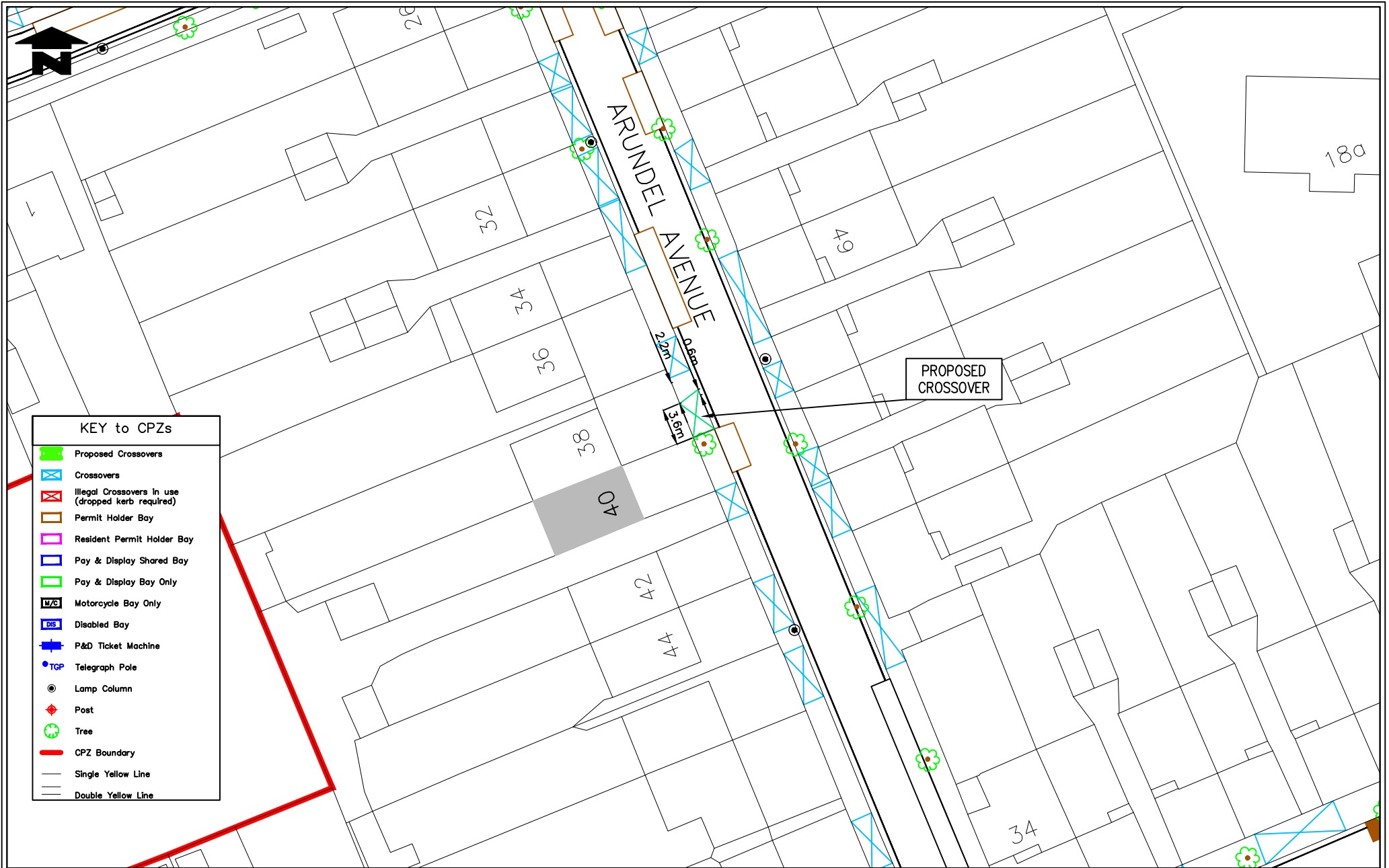

Notes
Do not scale from this drawing

Rev	Revisions	Drawn	Sig	Date	Checked	Sig	Date	App.	Sig	Date

Future Merton
 environment & regeneration
 TRAFFIC & HIGHWAYS

Reproduced from/based upon the Ordnance Survey's 1:250 maps with the permission of the Controller of HMSO. Crown Copyright Reserved. Unauthorised reproduction infringes Crown copyright and may lead to prosecution or civil proceedings.
 London Borough of Merton 100019239

Drawn by TJ	Sig.	Date 18-01-21
Checked by	Sig.	Date
Approved by	Sig.	Date

PROJECT
Controlled Parking Zones 8079
 TITLE
40 ARUNDEL AVENUE SM4 4DX

merton
 Merton Civic Centre
 London Road
 Morden, Surrey
 SM4 5DX
 www.merton.gov.uk

Drawing No.	8079
Revision	-
Classification	APPLICATION
Scale	1: 500

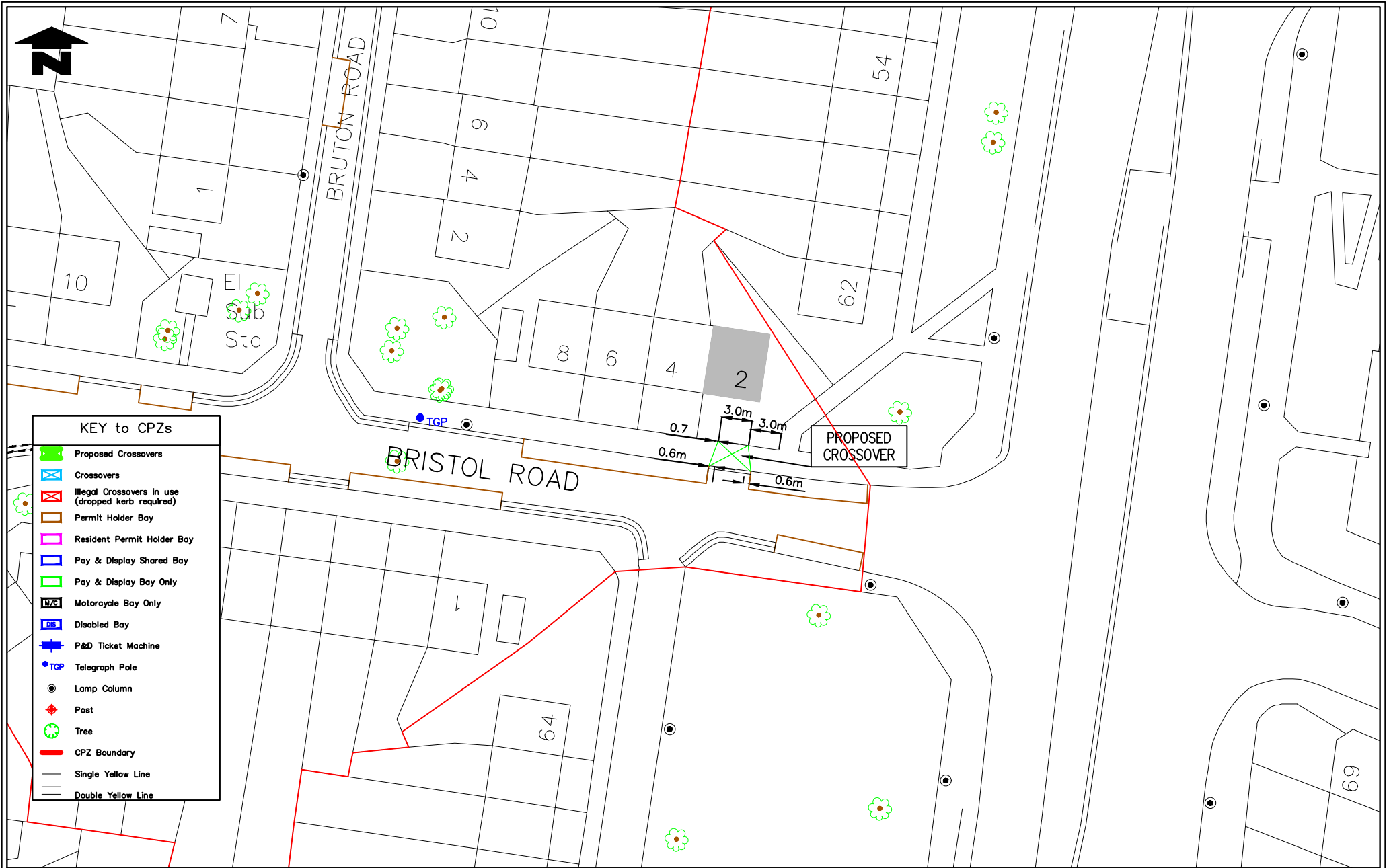

KEY to CPZs

- Proposed Crossovers
- Crossovers
- Illegal Crossovers in use (dropped kerb required)
- Permit Holder Bay
- Resident Permit Holder Bay
- Pay & Display Shared Bay
- Pay & Display Bay Only
- Motorcycle Bay Only
- Disabled Bay
- P&D Ticket Machine
- Telegraph Pole
- Lamp Column
- Post
- Tree
- CPZ Boundary
- Single Yellow Line
- Double Yellow Line

Notes
Do not scale from this drawing

Rev	Revisions	Drawn	Sig	Date	Chkd	Sig	Date	App	Sig	Date

Future Merton
environment & regeneration

TRAFFIC & HIGHWAYS

Reproduced from/based upon the Ordnance Survey's 1:1250 maps with the permission of the Controller of H.M.S.O. Crown Copyright Reserved. Unauthorised reproduction infringes Crown copyright and may lead to prosecution or civil proceedings.
London Borough of Merton 100016250

Drawn by TJ	Sig	Date 15-01-21
Checked by	Sig	Date
Approved by	Sig	Date

PROJECT
Controlled Parking Zones
8123

TITLE
BRISTOL ROAD
SM4 5SA

merton

Merton Civic Centre
London Road
Morden, Surrey
SM4 5DX
www.merton.gov.uk

Drawing No.	8123
Revision	-
Classification	APPLICATION
Scale	1: 500