

IMPORTANT – THIS COMMUNICATION AFFECTS YOUR PROPERTY

TOWN AND COUNTRY PLANNING ACT 1990

ENFORCEMENT NOTICE – OPERATIONAL DEVELOPMENT

ISSUED BY THE LONDON BOROUGH OF MERTON

1. **THIS IS A FORMAL NOTICE** issued by the Council because it appears that there has been a breach of planning control under Section 171A(1)(a) of the above Act, at the land described below. The Council considers it expedient to issue this notice, having regard to the provisions of the development plan and to other material considerations.

2. **THE LAND AFFECTED**

Land at 6 Wilberforce Way, Lauriston Road, Wimbledon, London SW19 4TH in the London Borough of Merton shown edged red on the attached plan ('the Land').

3. **THE BREACH OF PLANNING CONTROL ALLEGED**

Without planning permission the erection on the Land of one set of double gates and brick pillars more than one metre high where adjoining the highway

4. **REASONS FOR ISSUING THIS NOTICE**

- (a) It appears to the Council that the above breach of planning control has occurred within the last four years.
- (b) The gates and brick pillars by virtue of their height and design are considered to result in a loss of openness to the surrounding street scene and to have a harmful impact upon the character and appearance of the surrounding conservation area contrary to policies BE.1 BE.22 and BE.23 of the Council's Adopted Unitary Development Plan (October 2003).

Copies of the above policies are attached.

5. **WHAT YOU ARE REQUIRED TO DO**

- (a) Either remove the gates and brick pillars or reduce them to a height of no greater than one metre above the highway and
- (b) Remove all materials resulting from the works referred to in paragraph 5(a) above from the Land

Time for Compliance: one month from the date this notice takes effect.

6. WHEN THIS NOTICE TAKES EFFECT

This notice takes effect on 1st March 2006 unless an appeal is made against it beforehand.

Dated: 27th January 2006

Signed.....

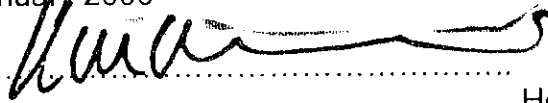

Head of Civic and Legal Services

Address to which all communication should be sent:-
Head of Civic and Legal Services, London Borough of Merton, Merton Civic Centre,
London Road, Morden, Surrey SM4 5DX (Ref: CE/LE/TH/2005P416)

YOUR RIGHT OF APPEAL

You can appeal against this notice by using the Enforcement Notice Appeal forms enclosed with this notice or by submitting an appeal online (www.planningportal.gov.uk/pcs). Please note however that any appeal must be received, or posted in time to be received, by the Planning Inspectorate before the date this notice takes effect. The enclosed booklet "Making Your Enforcement Appeal" sets out your rights and the procedure to be followed. Read it carefully. You should also read sections 171-177 of the Act which are also enclosed. If you decide to appeal, you should send two copies of the enclosed appeal forms and one copy of the enforcement notice, to the Planning Inspectorate. The other appeal form and the other copy of the enforcement notice are for you to keep for your own records.

FEE PAYABLE FOR THE DEEMED APPLICATION

If your ground of appeal is, or includes ground (a) that planning permission should be granted, you must include with your appeal a fee, which is double that payable for a normal planning application. The total fee payable is **£270**.

Half the fee is payable to the Planning Inspectorate and half to the Council.

You should therefore include:

One cheque for **£135** payable to The Office of the Deputy Prime Minister

One cheque for **£135** payable to the London Borough of Merton

The fee can be sent with your appeal form.

WHAT HAPPENS IF YOU DO NOT APPEAL

If you do not appeal against this enforcement notice, it will take effect on the date indicated above and you must then ensure that the notice is complied with. Failure to comply with an enforcement notice that has taken effect, is a criminal offence and can result in legal proceedings and/or remedial action by the Council.

COMMON

MURRAY ROAD

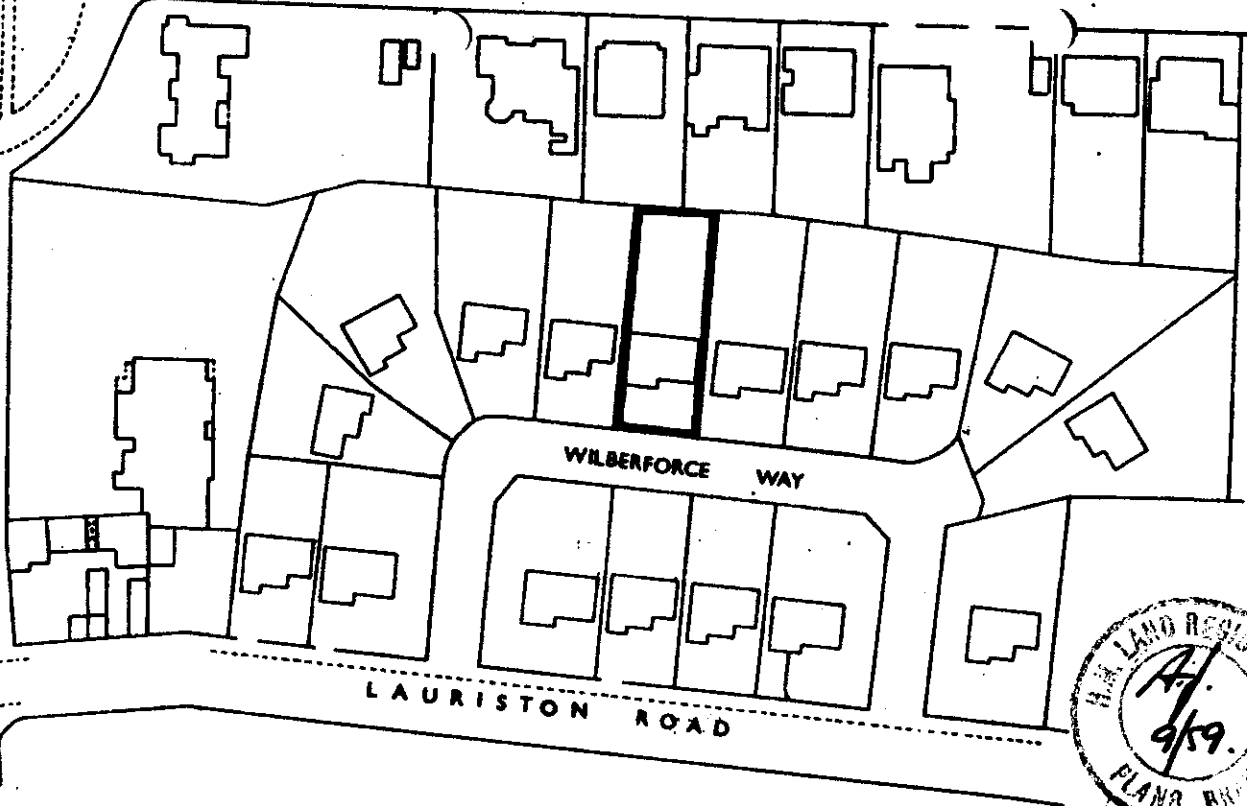

Reference SURREY VII. 10. P.

Copyright Reserved

Filed Plan of Title No. **SY229865**

shows the general position of the boundaries: it does not show the exact line of the boundaries. Measurements scaled from this plan may not match measurements between the same points on the ground.

Information see Land Registry Public Guide 7 - Title Plans.

This copy shows the state of the title plan on 7 November 2005 at 11:07:41. It may be subject to distortions in scale.

Under the Land Registration Act 2002, this copy is admissible in evidence to the same extent as the original.

November 2005.

Produced by HMLR. Further reproduction in whole or part is prohibited without the prior written permission of Ordnance Survey. Licence Number GD272728.

Produced with by the Croydon District Land Registry.