



**ENVIRONMENT AND REGENERATION DEPARTMENT**  
Chris Lee - Director



James McGinlay  
Head of Sustainable Communities  
London Borough of Merton  
Merton Civic Centre  
London Road  
Morden SM4 5DX

*Direct Line:* 020 8545 3214  
*Fax:* 020 8545 4865  
Please ask for Paul Atie  
*Date:* 23 December 2015

**Dear Resident / Business**

Following the Council's decision to introduce a Controlled Parking Zone VSW in the Chester Road area, I am writing to inform you that the works will start in January 2016, which will be carried out by F M Conway Ltd on behalf of the Council.

**DATE AND TIME OF WORKS**

It is anticipated that the works will start the week commencing 11 January 2016 for a period of 3 weeks, weather permitting. Work will be carried out between 8am and 4.30pm. To allow the works to be carried out as quickly as possible, temporary parking restrictions will be introduced. "No Parking" cones and signs will be in place to indicate the areas where parking would be prohibited. By doing so, this will keep the roads free of parked vehicles allowing a smooth transition of the works. Vehicles would be allowed back into the road once the lining work is complete or after the working day. Offending vehicles run the risk of receiving a fine and possible relocation. Residents will be allowed to park on the completed bays during the implementation work.

Notices and cones will be placed in your road 12 – 48hrs prior to work being undertaken.

The work schedule of when your road will be marked is shown below.

**SCHEDULE OF WORKS:**

Chester Road and Beech Close 11 - 20 January and 21 - 29 January 2016.

The information pack on how to apply for your permit will follow shortly. The Council is conscious of the inconvenience and the disruption that this work may cause and will endeavour to keep the impact to a minimum. We apologise in advance for any inconvenience that may be caused by these works.

**FURTHER INFORMATION AND CONTACT DETAILS FOR THE WORKS:** FM Conway Ltd – Gus Smith 07748632920 (Signing Contractor): 0791 9493 010 FM Conway Ltd – Tarkan Moer (Lining Contractor): 07827 871 469 and Merton Council – Paul Atie 020 8545 3214

**PAUL ATIE | SENIOR ENGINEER  
COMMISSIONING TEAM  
FUTURE MERTON  
LONDON BOROUGH OF MERTON**

**Proposed Controlled Parking Zone (CPZ) VSW - Chester Road area**



ISSUE DATE: 23 DECEMBER 2015

Councillor Andrew Judge  
Cabinet Member for  
Environmental Sustainability  
and Regeneration  
T: 020 8545 3425  
E: andrew.judge@merton.gov.uk



**Dear Resident / Business**

This leaflet is to update the community of the outcome of the statutory consultation that was carried out in June/July 2015, and to inform you of the Council's decision on the proposal to introduce 'VSW' Controlled Parking Zone (CPZ) to include Chester Road, Sycamore Road and Beech Close as shown in plan overleaf.

During the informal consultation the hours of operation was identified as 8.30am to 6.30pm, upon which the statutory consultation was based on. During the statutory consultation, however, a petition was submitted by some residents of these roads indicating that some residents have changed their minds with regards to their preferred hours of operation and they wish for the hours to be changed to 11am to 3pm. To ensure that the true preferred option is introduced the Council carried out a second informal consultation between 2nd and 13 November 2015. 106 premises were consulted via a letter explaining the reason for further informal consultation and residents were advised to vote online. 79 households responded representing a response rate of 74.5%. Of the 79 who responded, 62% supported 8.30am to 6.30pm, compared to 38% who supported 11am to 3pm. The outcome is in line with the previous informal consultation.

The representations received to the statutory consultation and the results of the informal consultation along with officer's recommendations were reported to the Cabinet Member for Environment Sustainability and Regeneration in November 2015. After careful consideration the following have been agreed:-

a) To proceed with the making of the relevant Traffic Management Orders (TMOs) and the implementation of a proposed 'CPZ' VSW to include Chester Road,

Sycamore Road and Beech Close, operational Monday to Friday between 8.30am and 6.30pm.

b) To the making of an Exemption Order to allow partial footway parking (two wheels on the footway) in Chester Road and Sycamore Road.

The report and the decision sheet can be viewed on our website. [www.merton.gov.uk/cpzvsw](http://www.merton.gov.uk/cpzvsw)

**What happens next**

The final made Traffic Management Orders (TMOs), which allows the restrictions to be implemented and administered, will be published in the London Gazette and the local newspaper shortly. Notices will also be placed on lamp columns in the affected area. It is anticipated that the CPZ will come into operation on 8 February 2016.

Please see overleaf for details of the schedule of works.

Finally we would like to thank you for your participation in the consultation process and for your feedback. If you require any further information, please email [trafficandhighways@merton.gov.uk](mailto:trafficandhighways@merton.gov.uk).

Alternatively, this information can be viewed on Merton Council's website [www.merton.gov.uk/cpzvsw](http://www.merton.gov.uk/cpzvsw)

**VILLAGE WARD COUNCILLORS**

**Cllr Hamish Badenoch**

Tel - 020 8545 3396  
Email: [hamish.badenoch@merton.gov.uk](mailto:hamish.badenoch@merton.gov.uk)

**Cllr John Bowcott**

Tel - 020 8946 1011  
Email: [john.bowcott@merton.gov.uk](mailto:john.bowcott@merton.gov.uk)

**Cllr Najeep Latif**

Tel - 0208 545 3396  
Email: [najeep.latif@merton.gov.uk](mailto:najeep.latif@merton.gov.uk)

For information only



Cannizaro Park

West Side House

**KEY**

**EXISTING**

- CROSSOVERS
- DISABLED BAY
- LAMP COLUMN
- POST
- TELEGRAPH POLE
- SINGLE YELLOW LINE
- DOUBLE YELLOW LINE

**PROPOSED CPZ**

- PERMIT HOLDER BAY
- PAY & DISPLAY SHARED BAY
- CPZ BOUNDARY
- P&D TICKET MACHINE
- PROPOSED SINGLE YELLOW LINE
- PROPOSED DOUBLE YELLOW LINE
- PROPOSED POST AND SIGN
- PROPOSED SIGN
- PROPOSED SIGN TYPE NUMBER

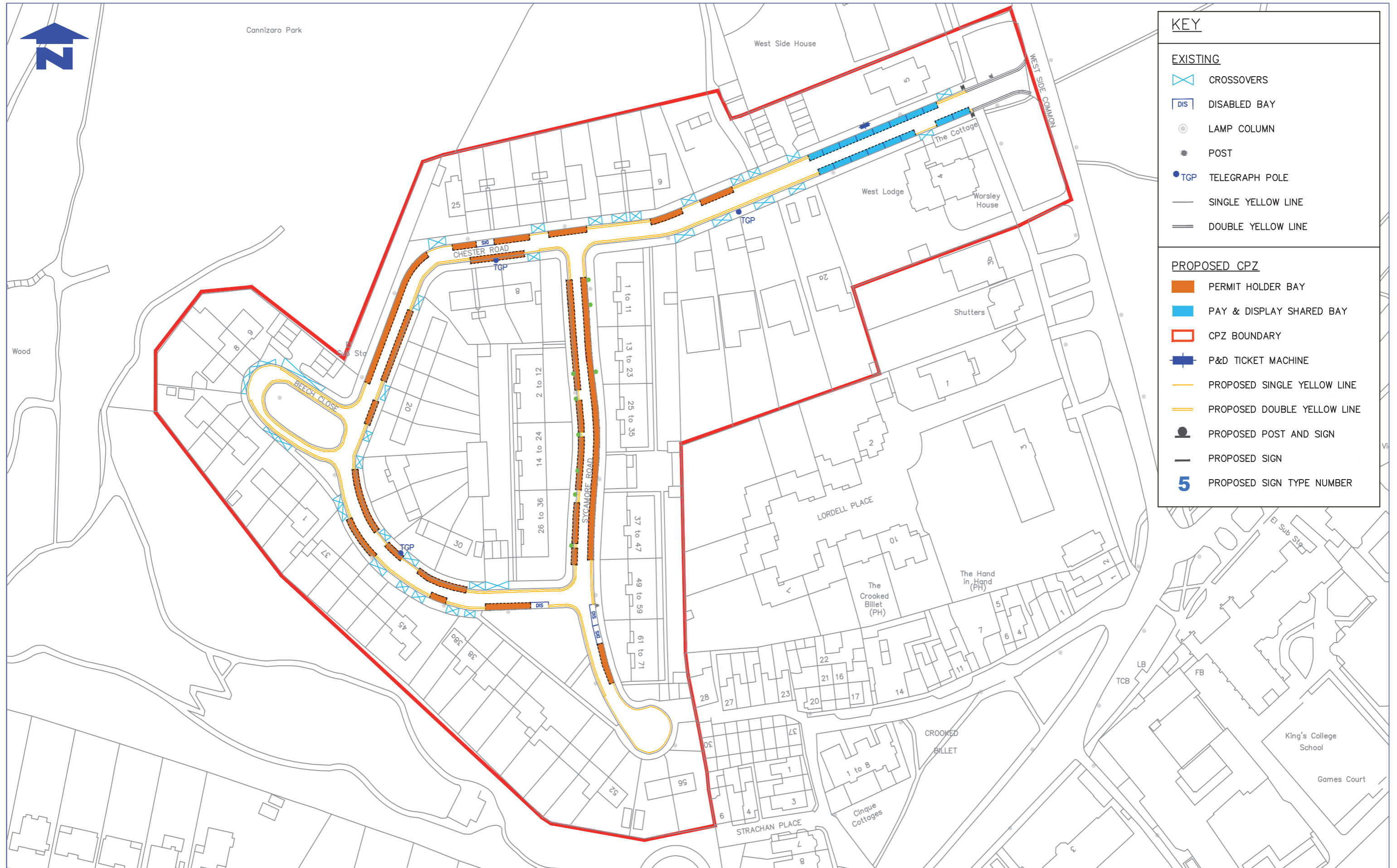

Notes

Rev.	Date	Revisions

Drawn	Sig.	Date	Chkd.	Sig.	Date	App.	Sig.	Date

**Street Scene & Waste**  
environment & regeneration

**TRAFFIC & HIGHWAYS**

Reproduced from/based upon the Ordnance Survey's 1:1250 maps with the permission of the Controller of H.M.S.O., Crown Copyright Reserved. Unauthorised reproduction infringes Crown copyright and may lead to prosecution or civil proceedings. London Borough of Merton 100019259 2015

Drawn by	Sig.	Date
Checked by	Sig.	Date
Approved by	Sig.	Date

PROJECT  
**Controlled Parking Zones (CPZ's)**

TITLE  
**Chester Rd Area Proposed VSW CPZ**

**merton**

Merton Civic Centre  
London Road  
Morden, Surrey  
SM4 5DX  
www.merton.gov.uk

Drawing No.  
**Z78-224-02**

Revision  
-

Classification  
**Implementation**

Scale  
**NTS**