

Redrow Homes Limited  
**265 Burlington Road, New Malden**  
Figures and Drawings to Proof of  
Evidence of Mike Savage

Final | 9 November 2020

This report takes into account the particular instructions and requirements of our client.

It is not intended for and should not be relied upon by any third party and no responsibility is undertaken to any third party.

Job number 274852-00

**Ove Arup & Partners Ltd**  
13 Fitzroy Street  
London  
WT1 4BQ  
United Kingdom  
[www.arup.com](http://www.arup.com)

**ARUP**

## Contents

---

- Figure 1 – Site Location Plan
- Figure 2 – Sustainability Plan
- Figure 3 – Cycle Map
- Figure 4 – TfL Cycle Map
- Figure 5 – Local Public Transport Services Network Map
- Figure 6 – Existing PTAL (WebCAT Output)
- Figure 7 – CPZ Zones
- Figure 8 – PWLC Parking Survey Comparison
- Figure 9 – Personal injury accident locations for the last three years (2017-2019)
- Figure 10 – TA Junction Capacity Assessment Study Area

- 274852-00-SK-001 – General Arrangement
- 274852-00-SK-002 – Burlington Road Junction – Swept Path Analysis
- 274852-00-SK-003 – Burlington Road Junction – Swept Path Analysis 7.5t Box Van Right Turn

Figure 1.1: Site Location Plan

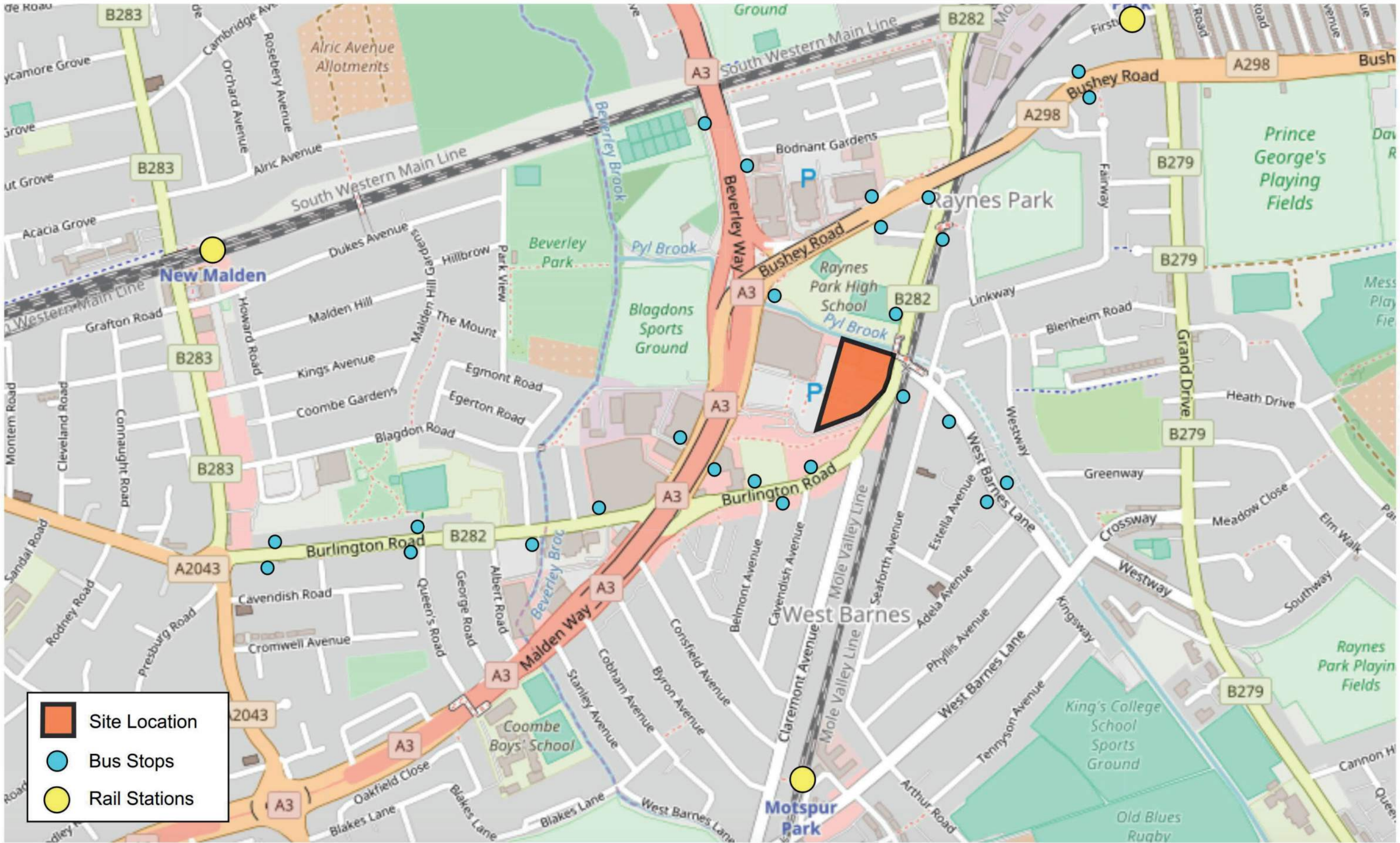

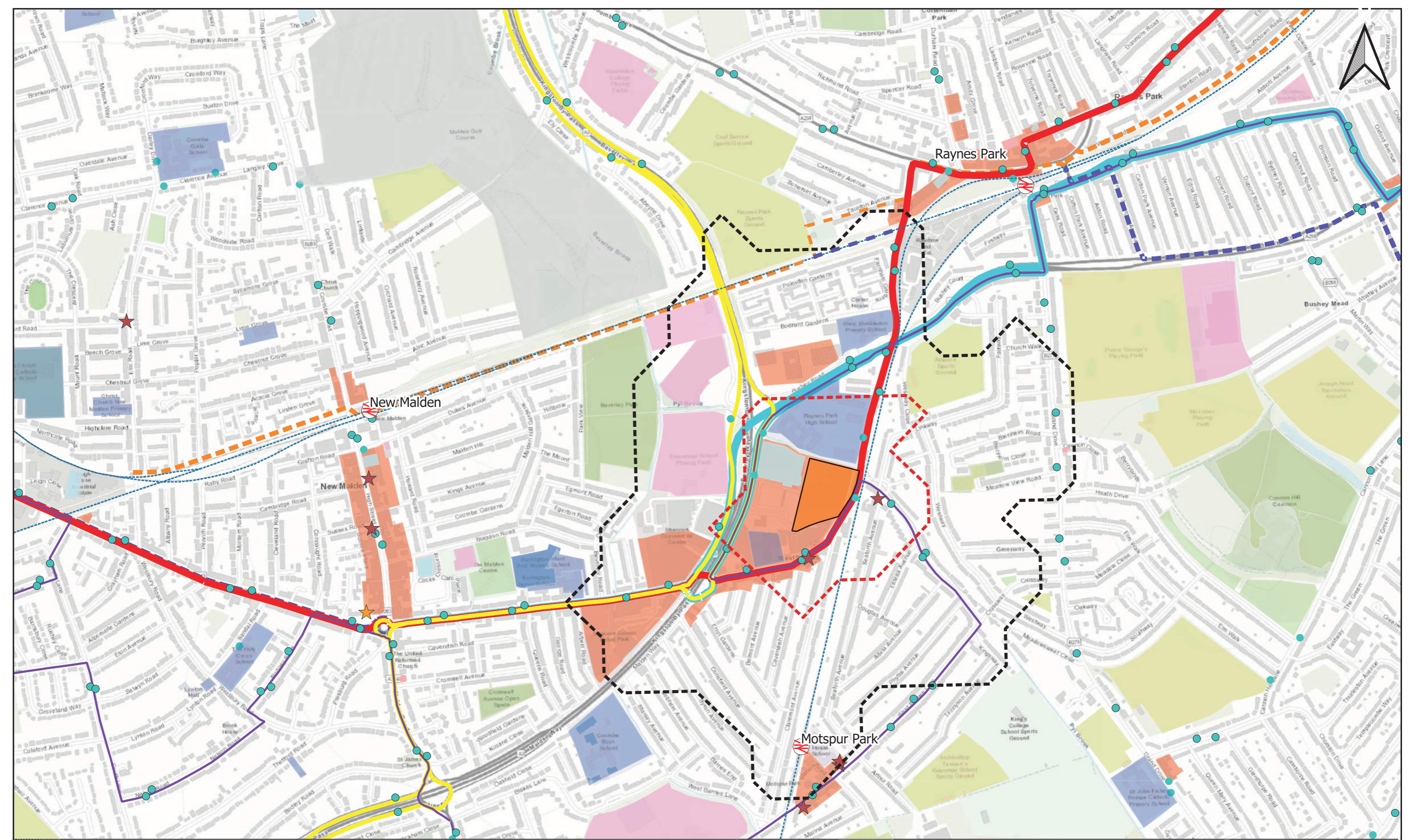

- |                    |                         |                               |                                |
|--------------------|-------------------------|-------------------------------|--------------------------------|
| Site Location      | <b>Public Transport</b> | 265                           | Newsagent and Convenience      |
| Retail Centres     | Bus Stop                | 152                           | 5 Minute Walk Isochrone        |
| <b>Open Spaces</b> | <b>Local Bus Routes</b> | <b>National Rail Network</b>  | 10 Minute Walk Isochrone       |
| Park               | 131                     | National Rail Network         | <b>Strategic Cycle Network</b> |
| Recreation Ground  | K5                      | Local Stations                | Existing                       |
|                    |                         |                               | Proposed                       |
|                    |                         | Doctors Surgery               |                                |
|                    |                         | Golf Course                   |                                |
|                    |                         | School                        |                                |
|                    |                         | Sports Centre/ Playing Fields |                                |
|                    |                         | Supermarket                   |                                |

Figure 2: Sustainability Plan

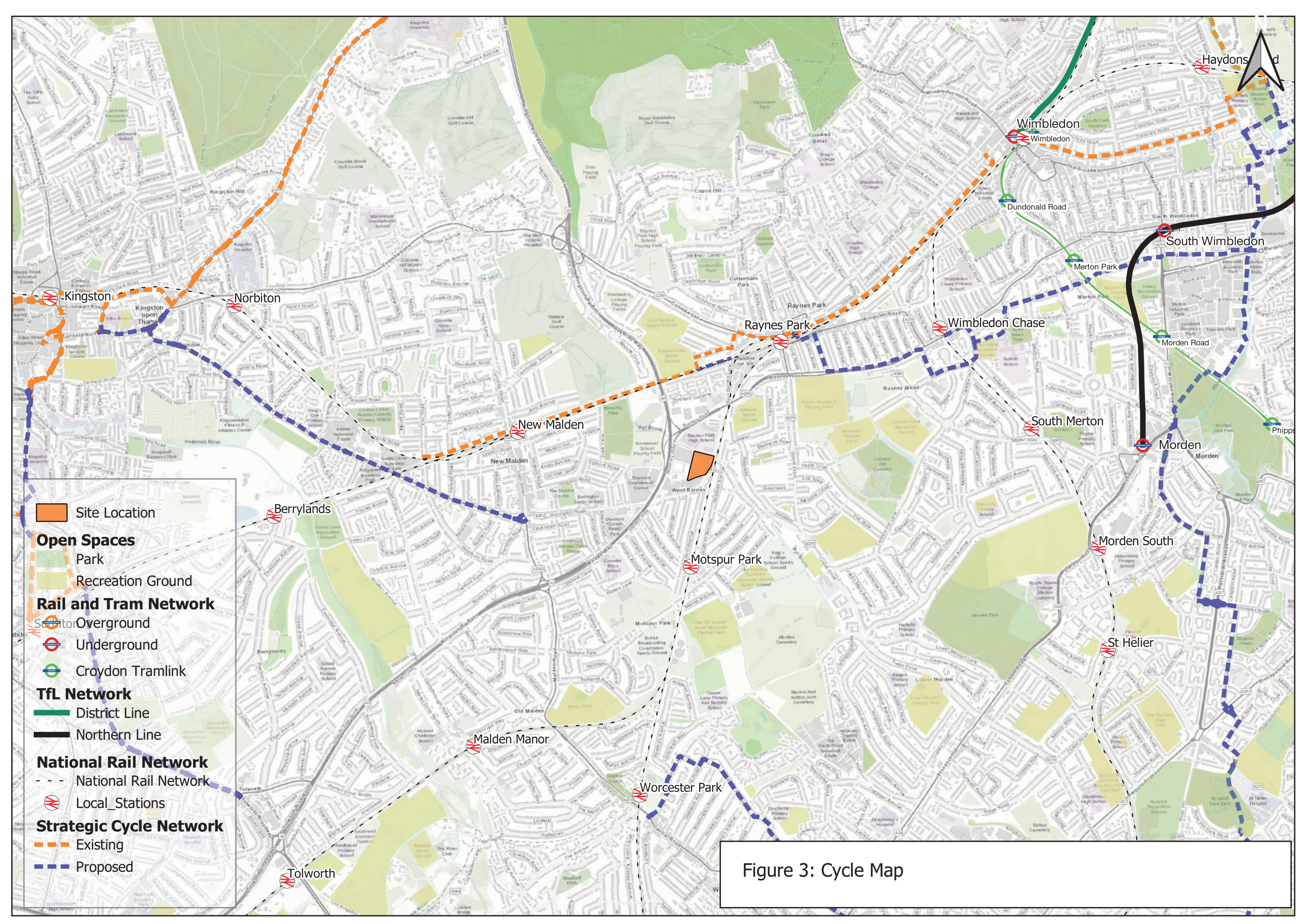

- Site Location
- Open Spaces**
- Park
- Recreation Ground
- Rail and Tram Network**
- Overground
- Underground
- Croydon Tramlink
- TfL Network**
- District Line
- Northern Line
- National Rail Network**
- National Rail Network
- Local Stations
- Strategic Cycle Network**
- Existing
- Proposed

Figure 3: Cycle Map

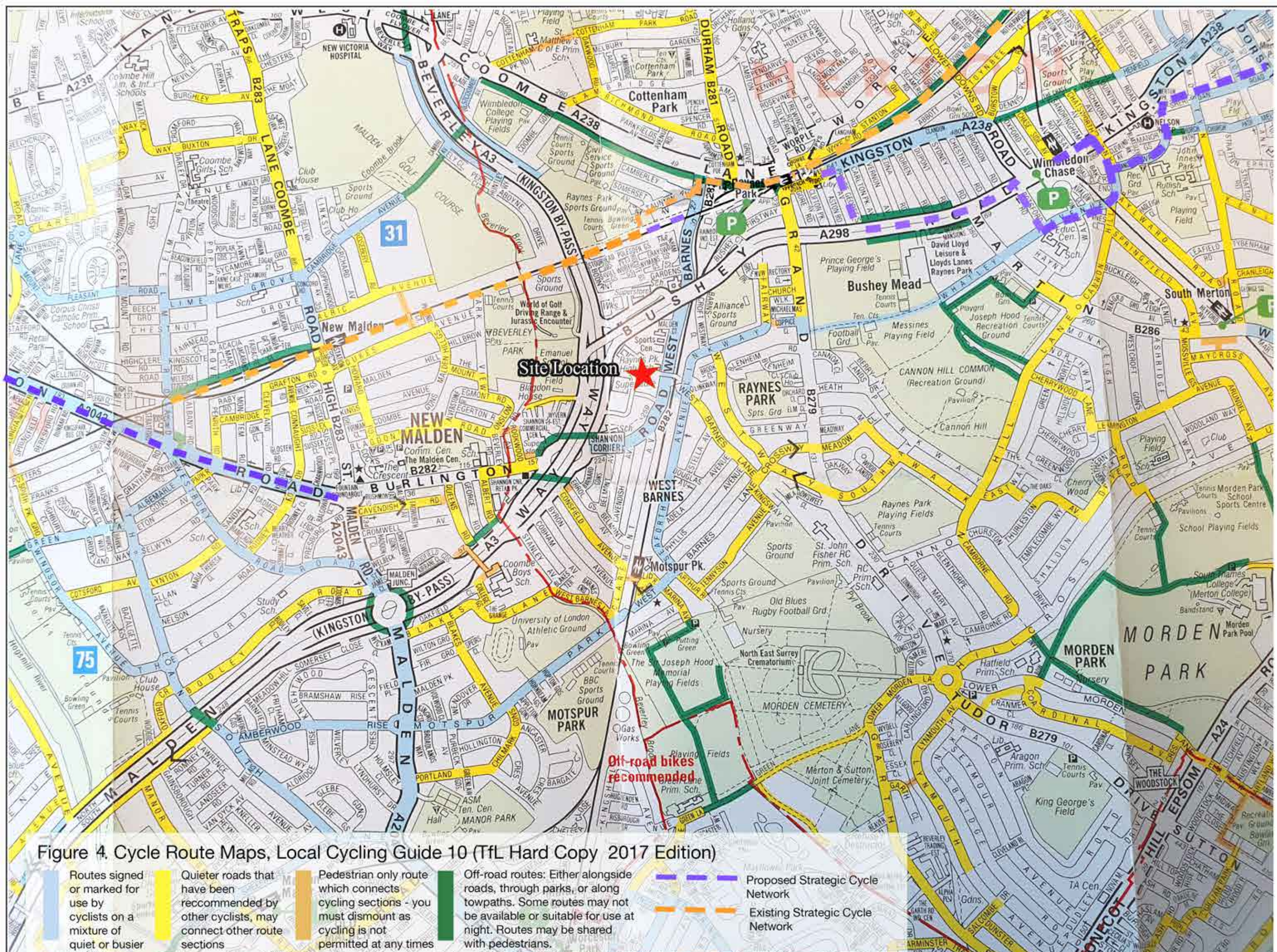

Figure 4. Cycle Route Maps, Local Cycling Guide 10 (TfL Hard Copy 2017 Edition)

Routes signed or marked for use by cyclists on a mixture of quiet or busier routes

Quieter roads that have been recommended by other cyclists, may connect other route sections

Pedestrian only route which connects cycling sections - you must dismount as cycling is not permitted at any times

Off-road routes: Either alongside roads, through parks, or along towpaths. Some routes may not be available or suitable for use at night. Routes may be shared with pedestrians.

Proposed Strategic Cycle Network  
Existing Strategic Cycle Network



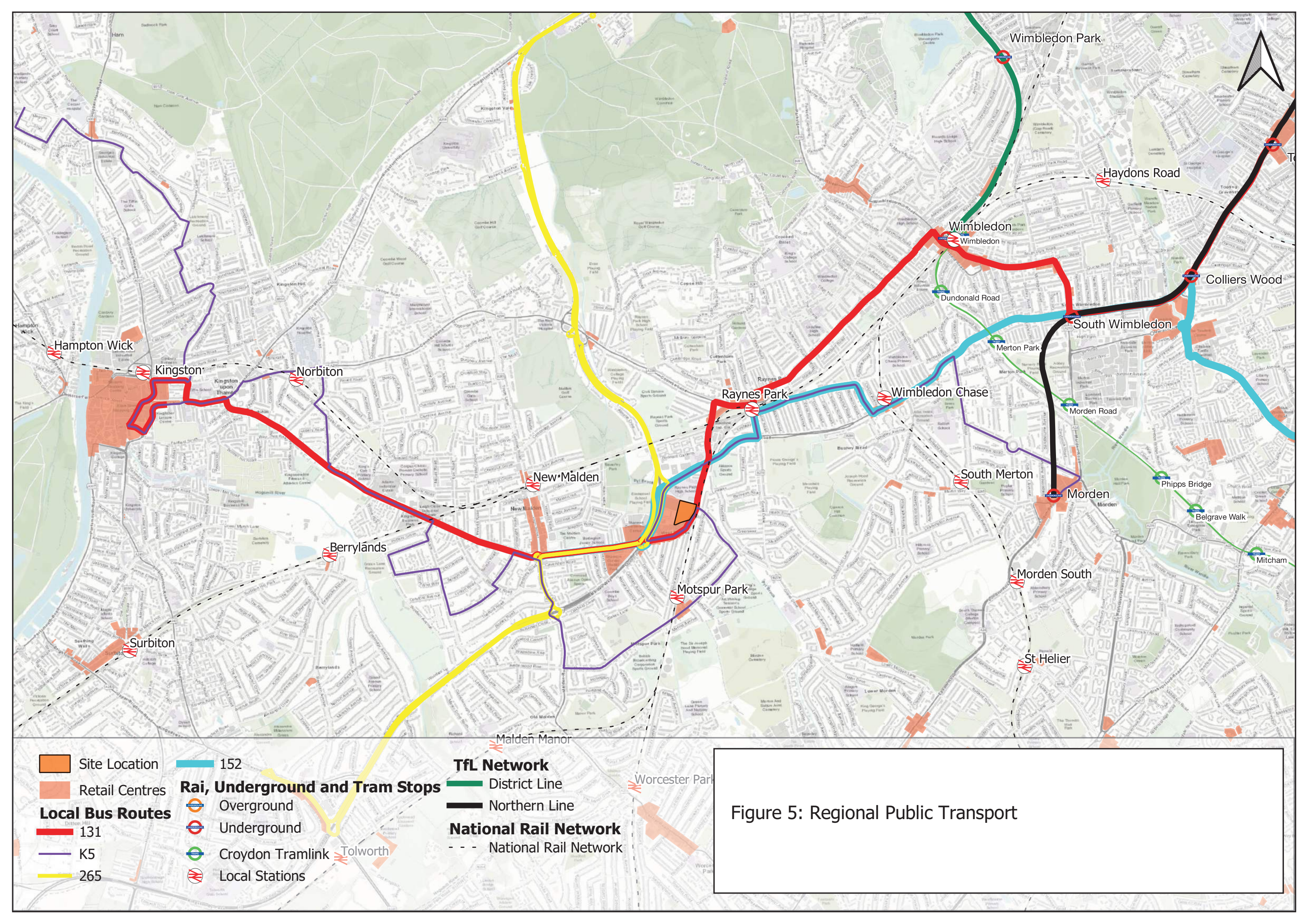

Figure 5: Regional Public Transport

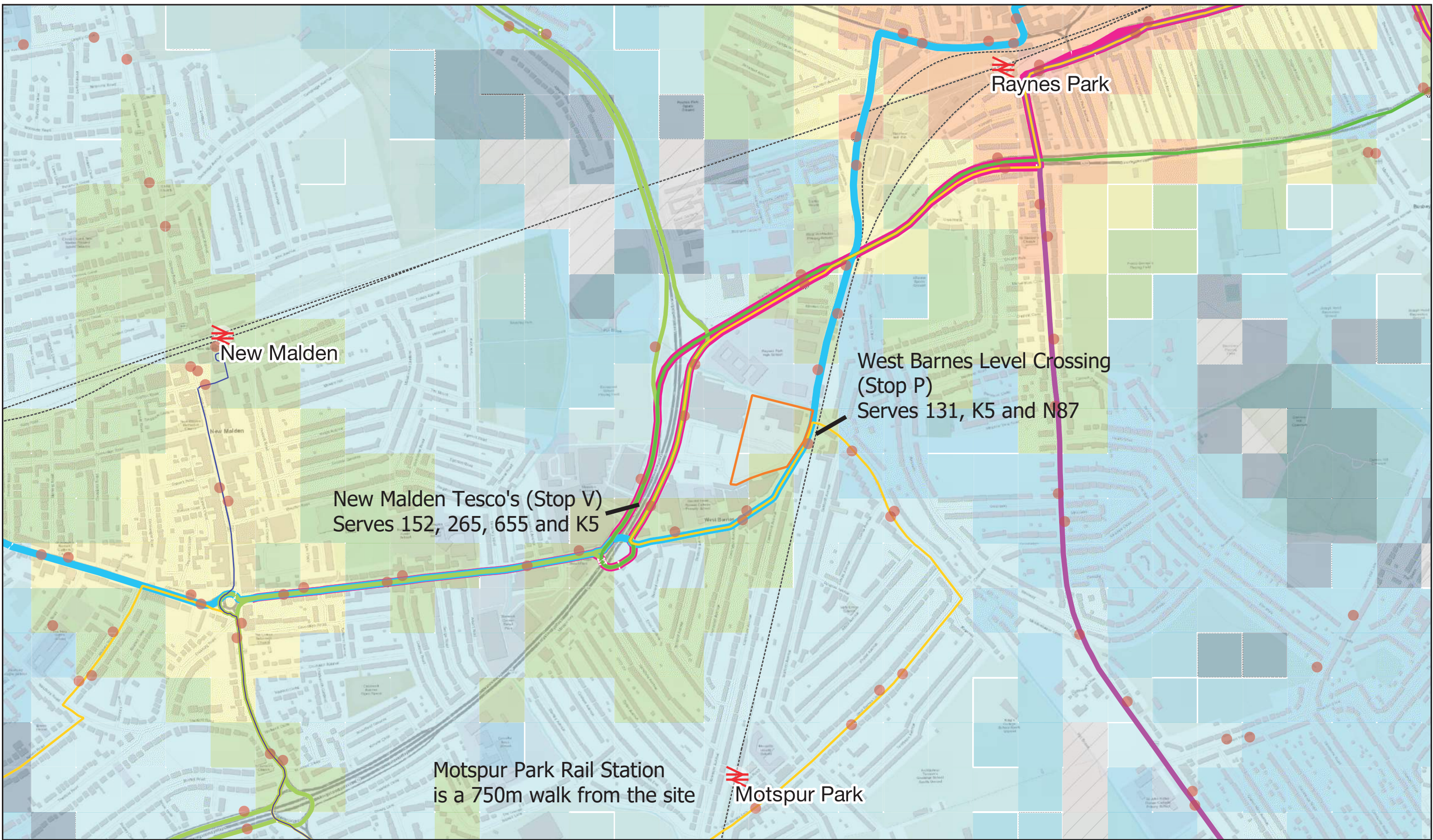

Figure 6: Existing PTAL Calculation (TfL)



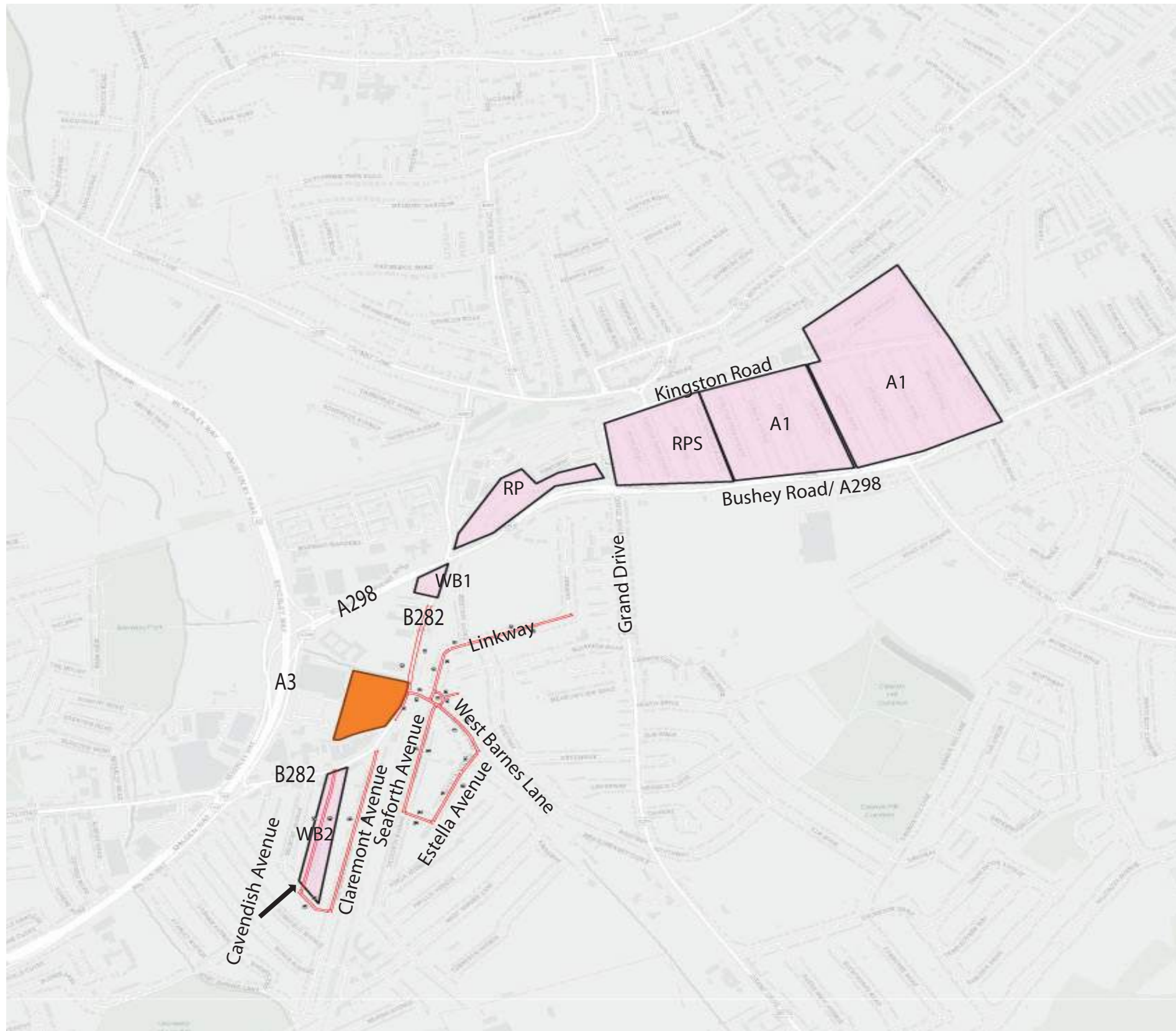

Figure 7: Controlled Parking Zones (CPZ) and new parking survey extents

- Site Location
- New Parking Survey Area Extent
- Controlled Parking Zones

Figure 8: PWLC Parking Survey Comparison Map

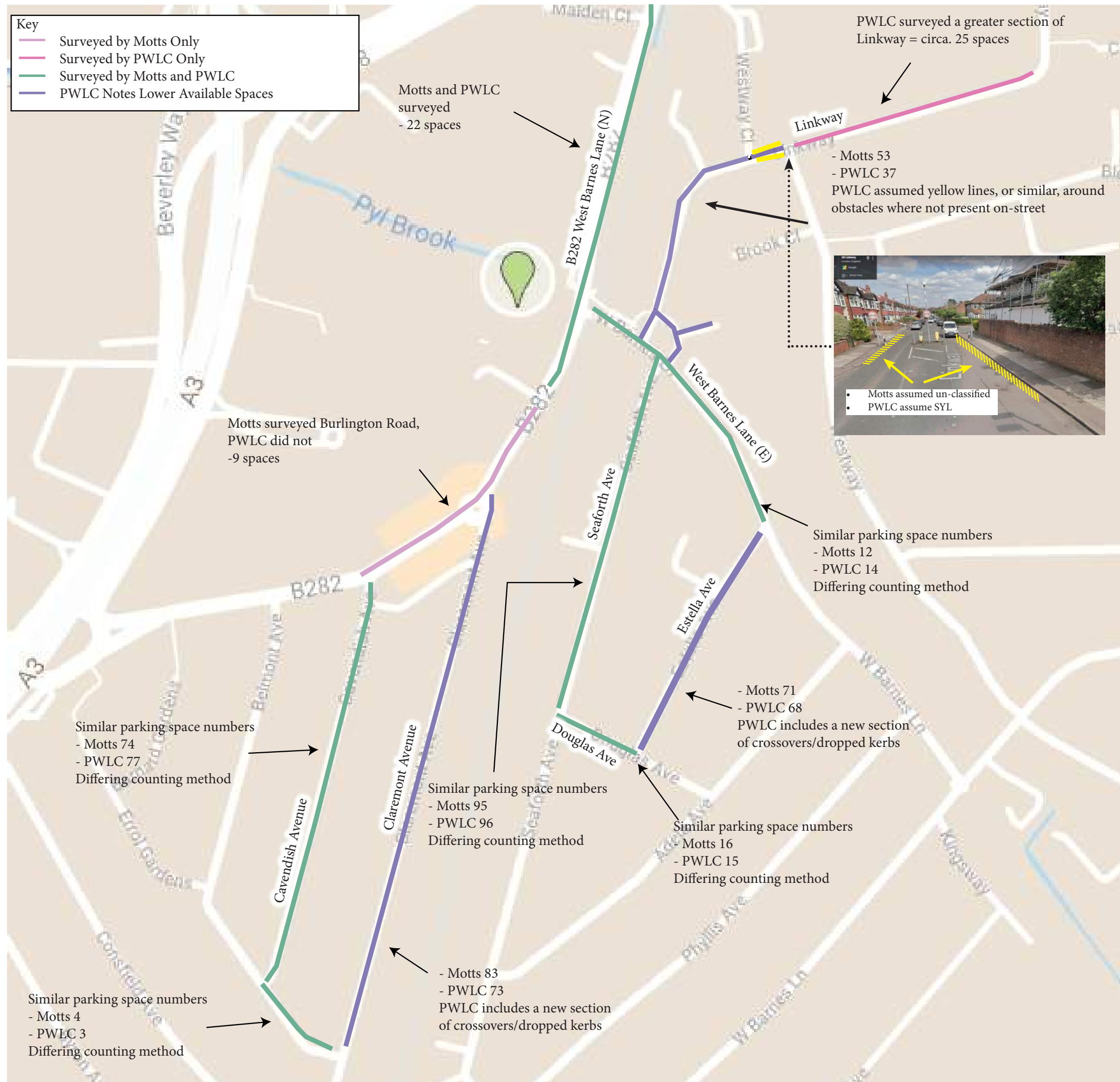

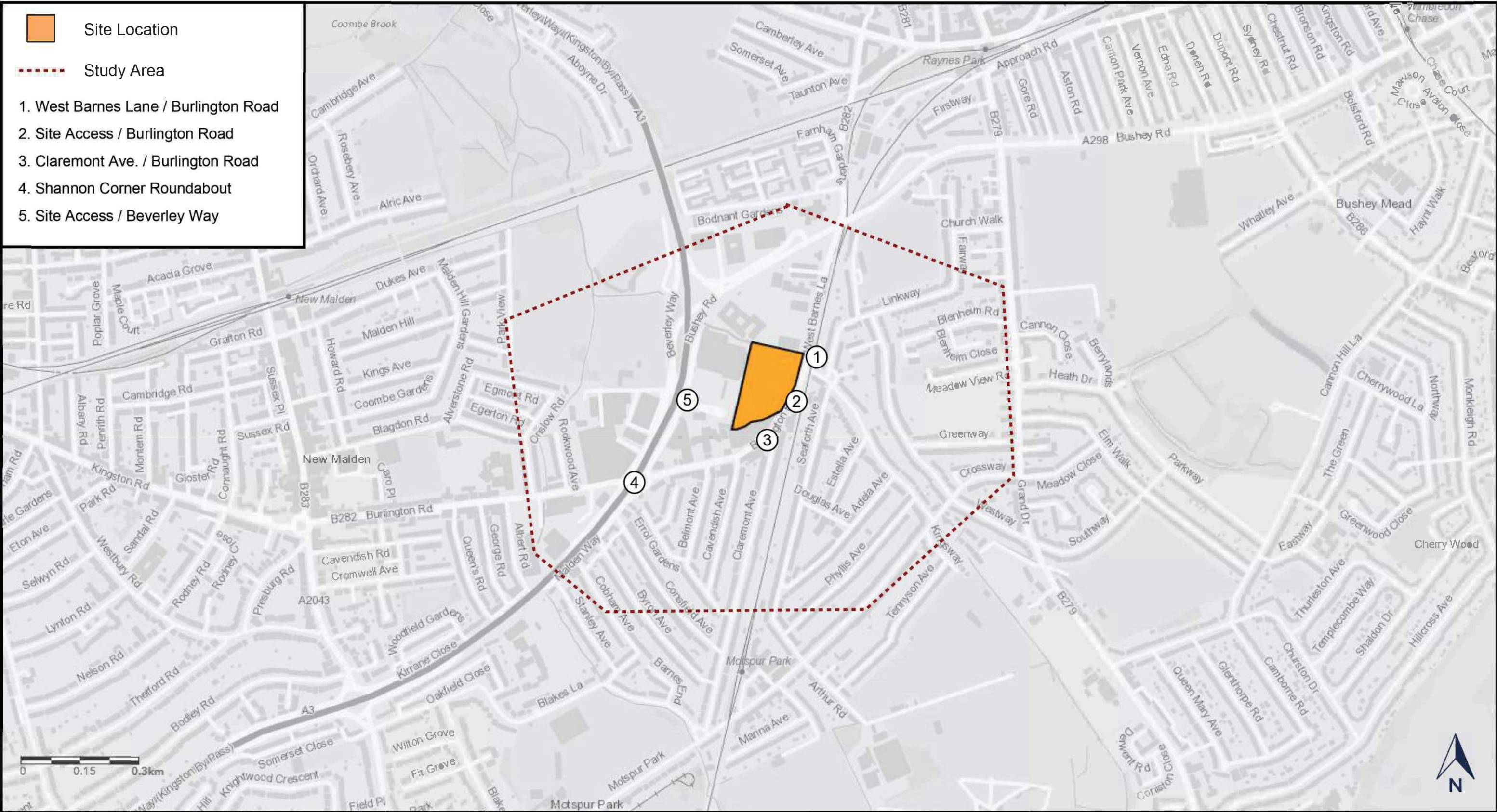

Figure 9: Personal Injury Accident Locations - Three-year Analysis (2017 to 2019)

Site Location

Study Area

1. West Barnes Lane / Burlington Road
2. Site Access / Burlington Road
3. Claremont Ave. / Burlington Road
4. Shannon Corner Roundabout
5. Site Access / Beverley Way



TA Study Area

Figure 10 Junction Capacity Assessment Study Area

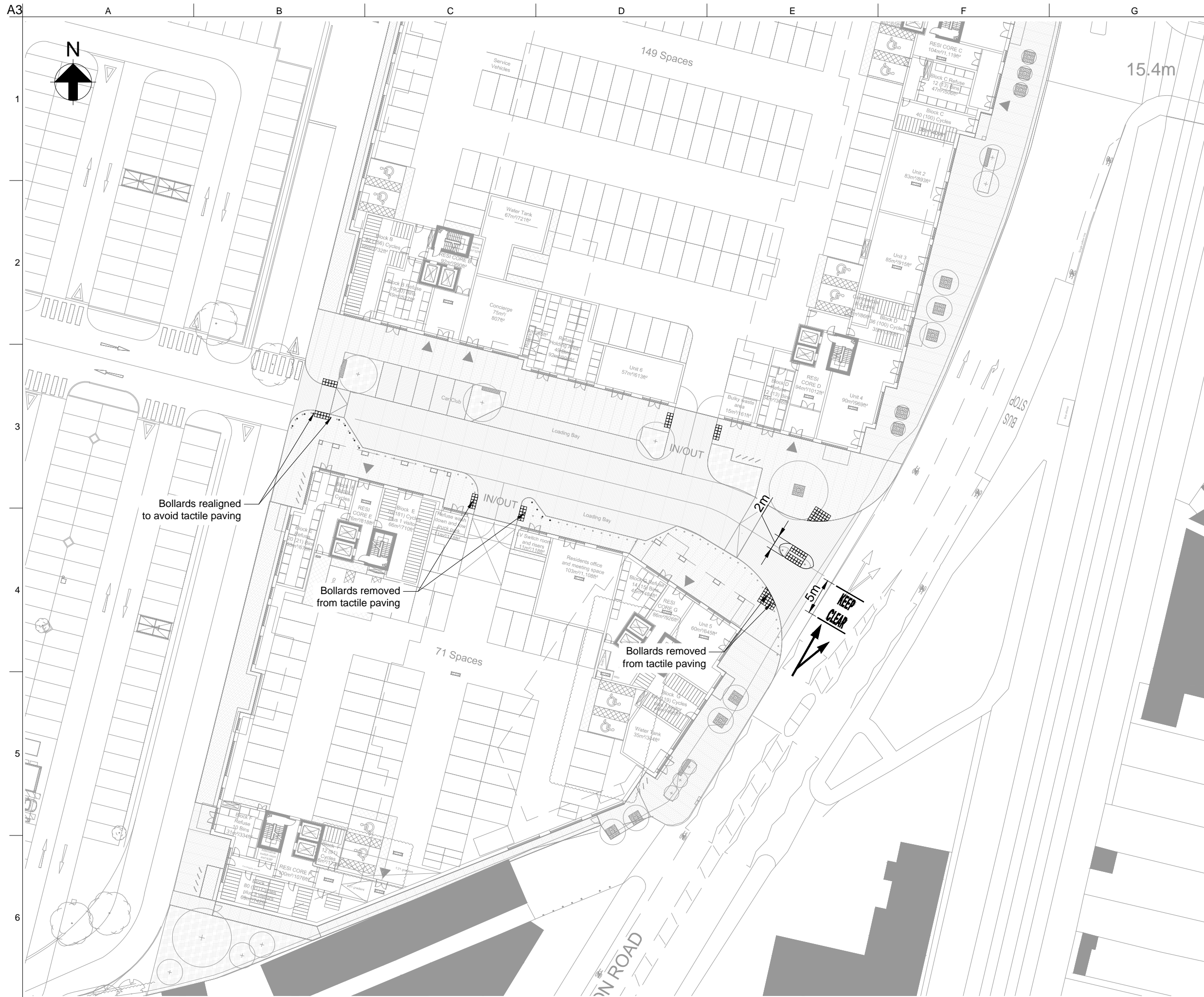

A	16/10/20	RJM	IV	MS
Issue	Date	By	Chkd	Appd

# ARUP

13 Fitzroy Street  
 London W1T 4BQ  
 Tel +44 (0)20 7636 1531 Fax +44 (0)20 7580 3924  
 www.arup.com

Client  
**Redrow Homes**

Job Title  
**256 Burlington Road**

Drawing Title  
**General Arrangement**

Scale at A3  
 1:500

Discipline  
 Transport

Drawing Status

### For Information

Job No <b>274852</b>	Drawing No <b>SK-001</b>	Issue <b>A</b>
-------------------------	-----------------------------	-------------------

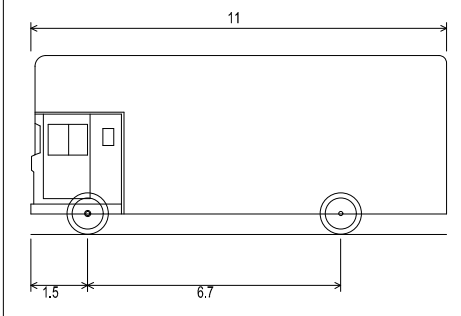
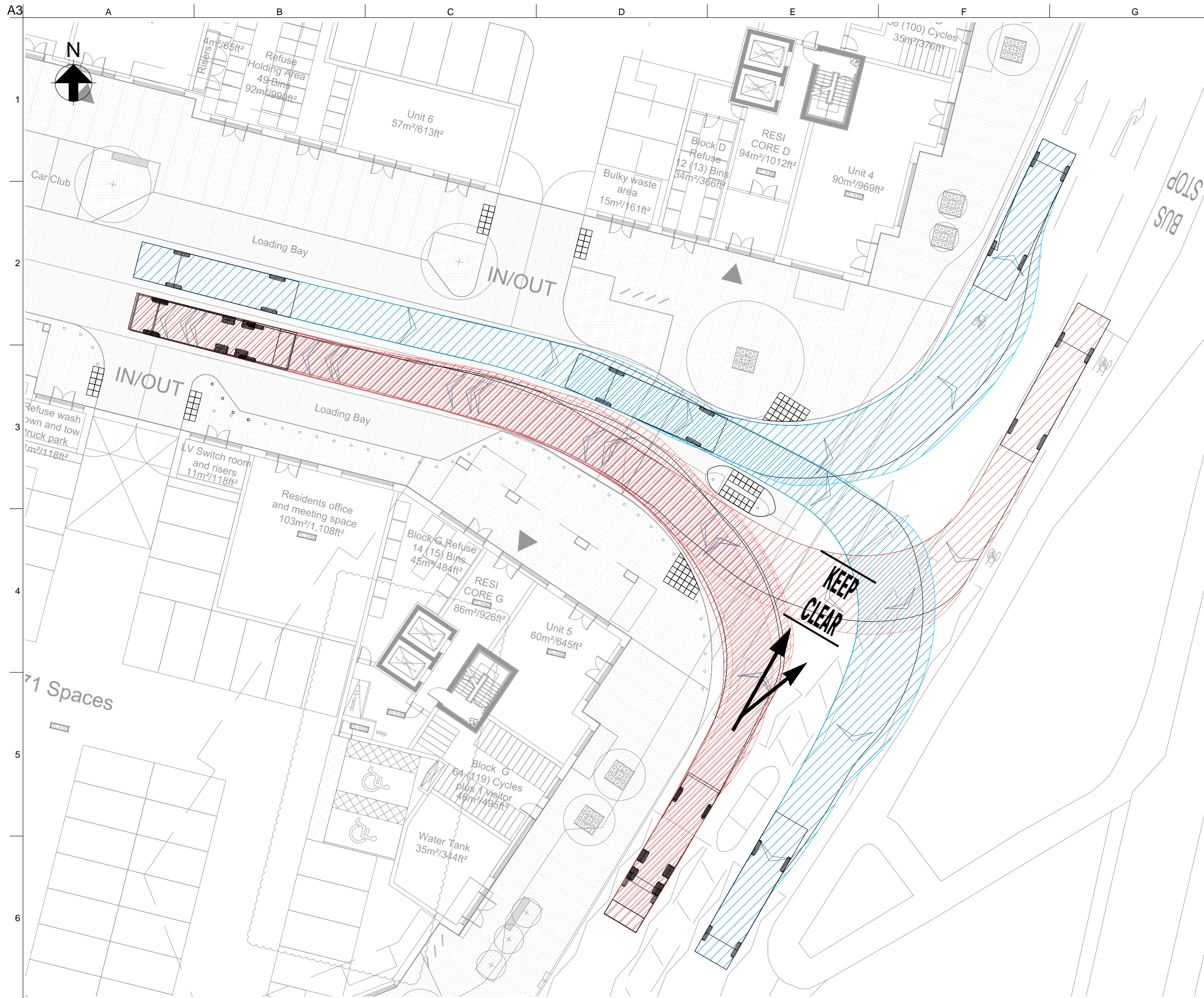

Pantechicon	11.000m
Overall Length	2.500m
Overall Width	4.730m
Overall Body Height	0.541m
Min Body Ground Clearance	2.500m
Track Width	6.00 sec
Lock to Lock Time	12.200m
Kerb to Kerb Turning Radius	

A	16/10/20	RJM	IV	MS
Issue	Date	By	Chkd	Appd

**ARUP**  
 13 Fitzroy Street  
 London W1T 4BQ  
 Tel +44 (0)20 7636 1531 Fax +44 (0)20 7580 3924  
 www.arup.com

Client  
**Redrow Homes**

Job Title  
**256 Burlington Road**

Drawing Title  
**Burlington Road Junction  
 Swept Path Analysis**

Scale at A3  
 1:250

Discipline  
 Transport

Drawing Status

**For Information**

Job No <b>274852</b>	Drawing No <b>SK-002</b>	Issue <b>A</b>
-------------------------	-----------------------------	-------------------

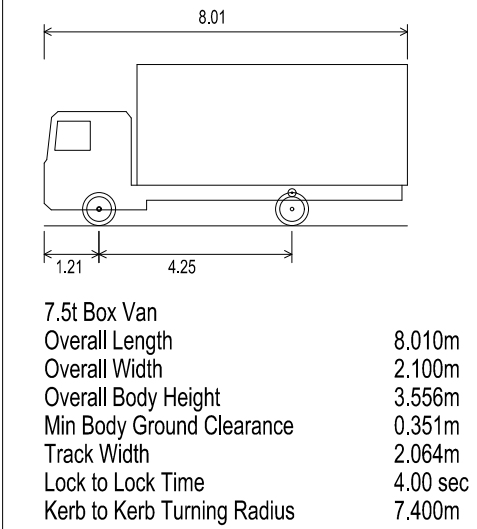
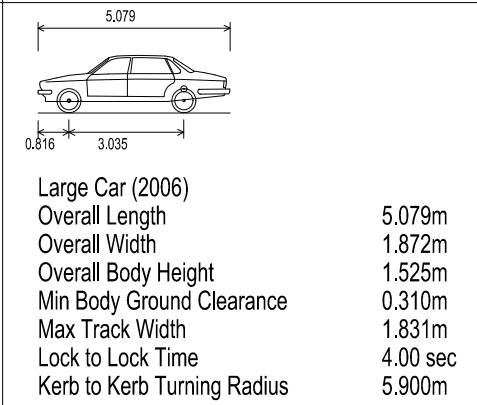
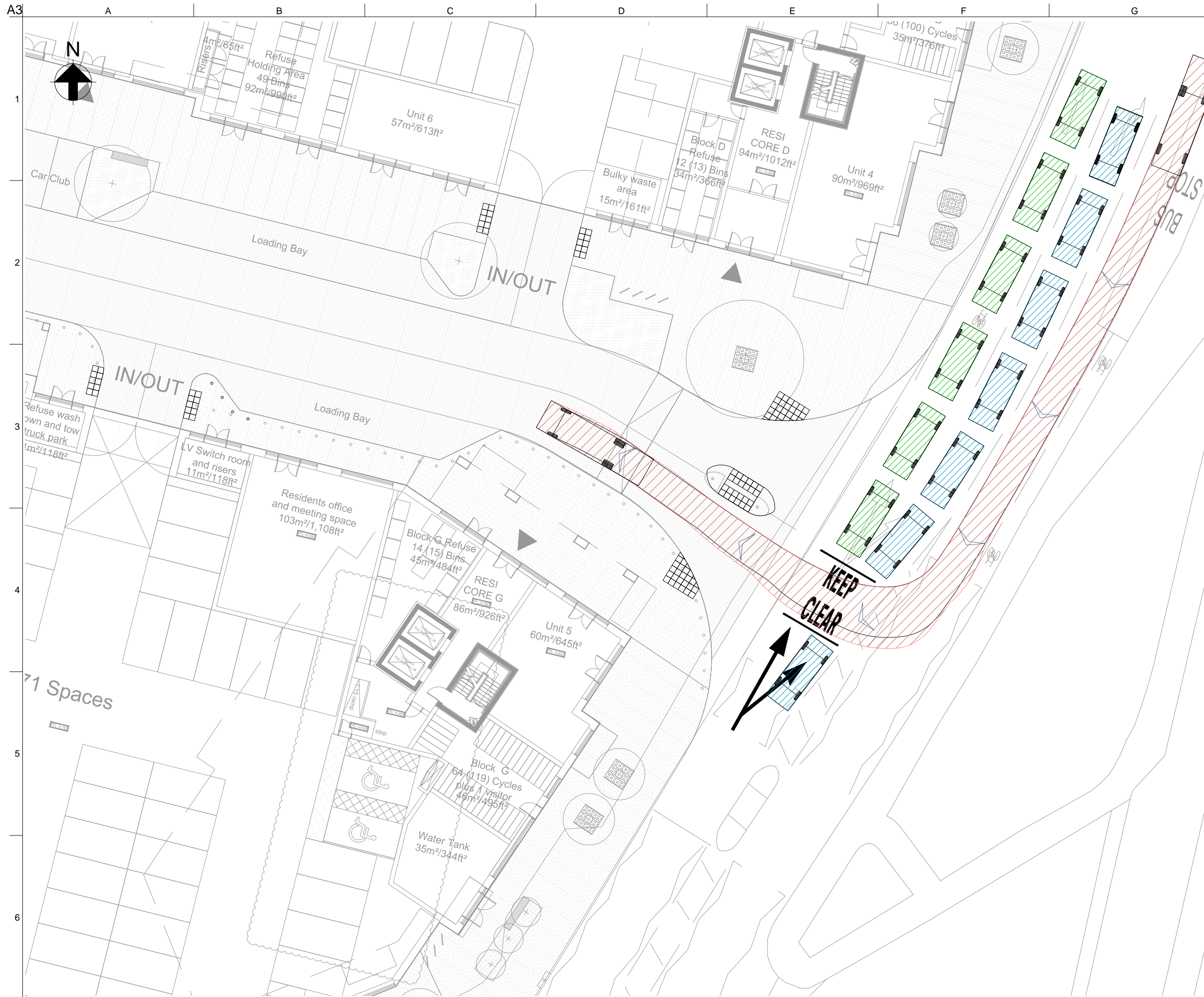

A	16/10/20	RJM	IV	MS
Issue	Date	By	Chkd	Appd

**ARUP**  
 13 Fitzroy Street  
 London W1T 4BQ  
 Tel +44 (0)20 7636 1531 Fax +44 (0)20 7580 3924  
 www.arup.com

Client  
**Redrow Homes**

Job Title  
**256 Burlington Road**

Drawing Title  
**Burlington Road Junction  
 Swept Path Analysis  
 7.5t Box Van Right Turn**

Scale at A3  
 1:250

Discipline  
 Transport

Drawing Status

**For Information**

Job No <b>274852</b>	Drawing No <b>SK-003</b>	Issue <b>A</b>
-------------------------	-----------------------------	-------------------