



**Description**  
On the north-east side, from a point 18.3 metres southeast of its junction with Worple Road, southeast for a distance of 7.2 metres.

EV sign to go on lamp column 1.

**KEY**

- EV Electrical charging bay
- New post
- Crossovers
- Permit holder bay
- Shared use bay
- Lamp Column

**Note**

Main sign to have an x-height of 20mm

Subplate to have an x-height of 15mm

Remove existing sign and return to Civic Centre

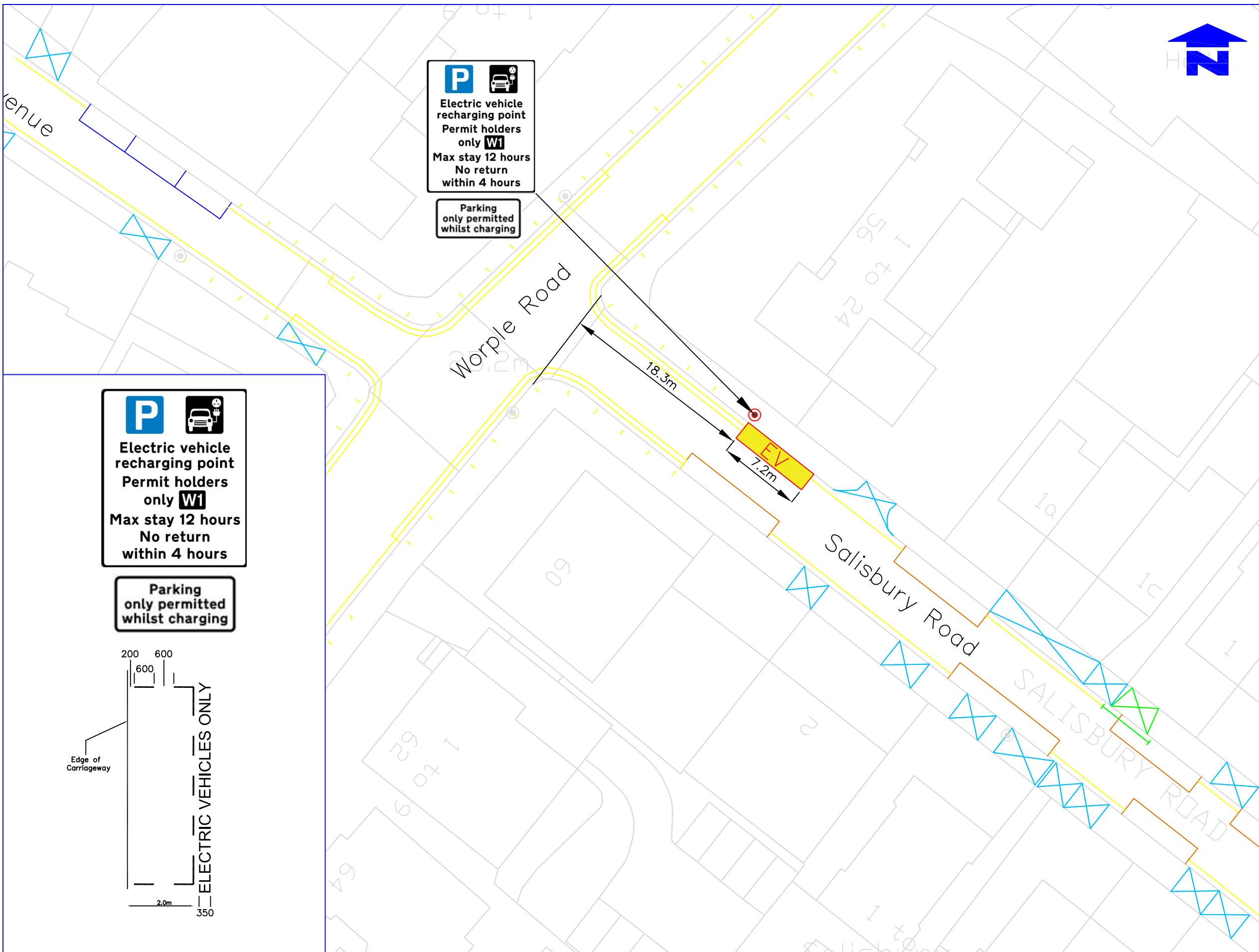

**P**   
Electric vehicle recharging point  
Permit holders only **W1**  
Max stay 12 hours  
No return within 4 hours

Parking only permitted whilst charging

**P**   
Electric vehicle recharging point  
Permit holders only **W1**  
Max stay 12 hours  
No return within 4 hours

Parking only permitted whilst charging

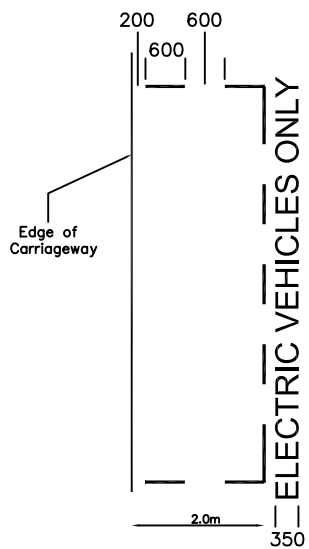

Notes  
Do not scale from this drawing

Rev.	Revisions	Drawn	Sig.	Date	Chkd.	Sig.	Date	App.	Sig.	Date

ENVIRONMENT  
CIVIC PRIDE & CLIMATE  
DEPARTMENT

FUTURE MERTON

Reproduced from/based upon the Ordnance Survey's 1:1250 maps with the permission of the Controller of H.M.S.O., Crown Copyright Reserved. Unauthorised reproduction infringes Crown copyright and may lead to prosecution or civil proceedings.  
London Borough of Merton (0001925) 2005

Drawn by	Sig.	Date
SC		28.11.23
Checked by	Sig.	Date
SC		28.11.23
Approved by	Sig.	Date

PROJECT  
LAMP COLUMN EV  
CHARGING BAYS

TITLE  
Salisbury Road (near Worple Road)  
Wimbledon SW19 4EZ (Zone W1)



Drawing No.	Z30-011-02
Revision	
Classification	CONSTRUCTION
Scale	1:500