

File name C:\USERS\UK\JUG006\WSP_0365\MERTON DOCKLESS CYCLE HIRE BAYS - TEMP DOCUMENT UPLOAD\01 - DRAWINGS\05 - WIMBLEDON CHASE\UK0028648.3916-WSP-XX-BR-DR-LP-0100-40-46.DWG, printed on 14 February 2025 11:03:43, by Gannon, Jude

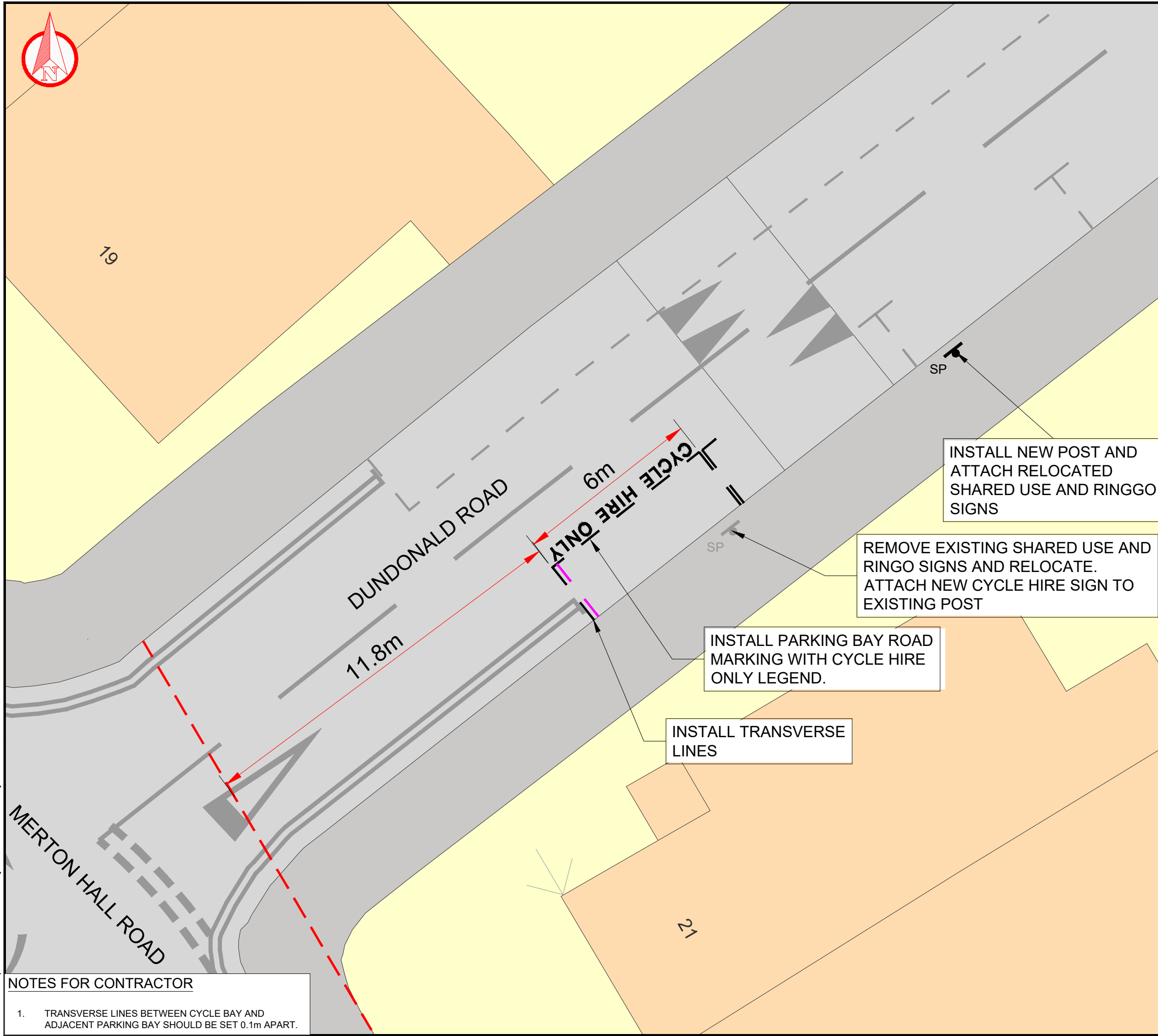

DO NOT SCALE

DESCRIPTION

ON THE SOUTH-EASTERN SIDE, FROM A POINT 11.8 METRES NORTHEAST OF THE SOUTH WESTERN BOUNDARY OF 21 MERTON HALL ROAD, NORTHEASTWARDS FOR A DISTANCE OF 6 METRES
 REMOVE EXISTING SHARED USE SIGN AND RINGO SIGN AND RELOCATE THEM ONTO THE NEW POST. ATTACH CYCLE HIRE SIGN TO EXISTING POST. INSTALL A NEW POST 12 METRES NORTHEASTWARDS (FROM THE NORTH EASTERN END OF CYCLE BAY).

KEY

- EXISTING KERB
- EXISTING ROAD MARKING
- EXISTING ROAD MARKING TO BE REMOVED
- PROPOSED ROAD MARKING
- BUILDING REFERENCE LINE
- PROPOSED SIGN POST
- EXISTING SIGN POST

REV	DATE	BY	DESCRIPTION	CHK	APP
P01	07/02/2025	MM	FIRST ISSUE	CM	CM

DRAWING STATUS: S2 - FOR INFORMATION

WSP House, 70 Chancery Lane, London, WC2A 1AF, UK
 T+ 44 (0) 207 314 5000, F+ 44 (0) 207 314 5111
 wsp.com

CLIENT:

PROJECT: MERTON DOCKLESS BIKE HIRE PARKING BAYS

TITLE: DUNDONALD ROAD
 WIMBLEDON CHASE, SW20 8SB
 CPZ - W5

SCALE @ A3: 1:100	CHECKED: CM	APPROVED: CM
----------------------	----------------	-----------------

PROJECT No: UK0028648.3916	DESIGNED: JR	DRAWN: JR	DATE: February 25
-------------------------------	-----------------	--------------	----------------------

DRAWING No: DD-3 - DUNDONALD ROAD	REV: P01
--------------------------------------	-------------

© WSP UK Ltd

NOTES FOR CONTRACTOR

- TRANSVERSE LINES BETWEEN CYCLE BAY AND ADJACENT PARKING BAY SHOULD BE SET 0.1m APART.

INSTALL NEW POST AND ATTACH RELOCATED SHARED USE AND RINGGO SIGNS

REMOVE EXISTING SHARED USE AND RINGO SIGNS AND RELOCATE. ATTACH NEW CYCLE HIRE SIGN TO EXISTING POST

INSTALL PARKING BAY ROAD MARKING WITH CYCLE HIRE ONLY LEGEND.

INSTALL TRANSVERSE LINES