

File name C:\USERS\UK\JG\006\WSP\_0365\MERTON DOCKLESS CYCLE HIRE BAYS - TEMP DOCUMENT UPLOAD\01 - DRAWINGS\05 - WIMBLETON CHASE\UK0028648.3916-WSP-XX-BR-DR-LP-0100-40-46.DWG, printed on 14 February 2025 11:16:24, by Gannon, Jude

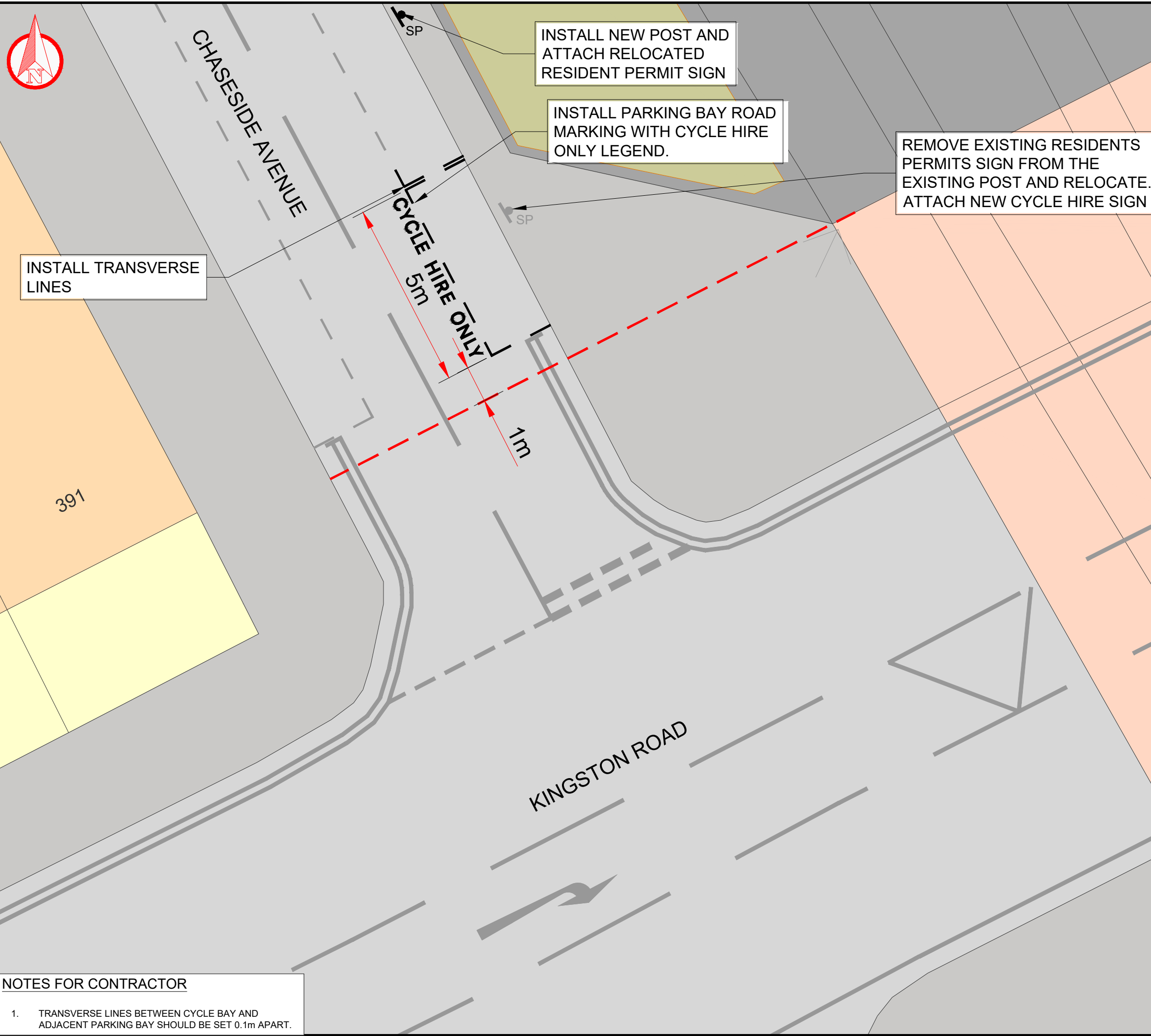

DO NOT SCALE

**DESCRIPTION**

ON THE NORTH-EASTERN SIDE, FROM A POINT 1 METRE NORTHWEST OF THE SOUTH-EASTERN BOUNDARY OF 1-3 STATION BUILDINGS, KINGSTON ROAD (GRATE EXPECTATIONS LTD), NORTHWESTWARDS FOR A DISTANCE OF 5 METRES.

REMOVE EXISTING RESIDENTS PERMITS SIGN FROM THE EXISTING POST AND RELOCATE IT ONTO THE NEW POST. ATTACH A CYCLE HIRE SIGN TO THE EXISTING POST. INSTALL A NEW POST AND ATTACH RELOCATED RESIDENT PERMIT PARKING SIGN

**KEY**

- EXISTING KERB
- EXISTING ROAD MARKING
- EXISTING ROAD MARKING TO BE REMOVED
- PROPOSED ROAD MARKING
- BUILDING REFERENCE LINE
- PROPOSED SIGN POST
- EXISTING SIGN POST

REV	DATE	BY	DESCRIPTION	CHK	APP
P01	07/02/2025	MM	FIRST ISSUE	CM	CM

DRAWING STATUS: **S2 - FOR INFORMATION**



WSP House, 70 Chancery Lane, London, WC2A 1AF, UK  
T+ 44 (0) 207 314 5000, F+ 44 (0) 207 314 5111  
wsp.com

CLIENT:



PROJECT: **MERTON DOCKLESS BIKE HIRE PARKING BAYS**

TITLE: **CHASESIDE AVENUE  
WIMBLETON CHASE, SW20 8LU  
CPZ - 5F**

SCALE @ A3: 1:100	CHECKED: CM	APPROVED: CM
----------------------	----------------	-----------------

PROJECT No: UK0028648.3916	DESIGNED: JR	DRAWN: JR	DATE: February 25
-------------------------------	-----------------	--------------	----------------------

DRAWING No: <b>DD-6 - CHASESIDE AVENUE</b>	REV: <b>P01</b>
---	--------------------

**NOTES FOR CONTRACTOR**

- TRANSVERSE LINES BETWEEN CYCLE BAY AND ADJACENT PARKING BAY SHOULD BE SET 0.1m APART.

© WSP UK Ltd