

NOTES:

1. THIS PLAN IS FOR INFORMATION ONLY. THE CONTRACTOR SHALL BE RESPONSIBLE FOR VERIFYING THE EXISTING CONDITIONS AND THE ACCURACY OF THE INFORMATION PROVIDED HEREON. THE CONTRACTOR SHALL BE RESPONSIBLE FOR OBTAINING ALL NECESSARY PERMITS AND APPROVALS FROM THE APPROPRIATE AGENCIES AND AGENCIES PRIOR TO THE COMMENCEMENT OF ANY WORK UNDER THIS CONTRACT.
2. THE CONTRACTOR SHALL BE RESPONSIBLE FOR VERIFYING THE EXISTING CONDITIONS AND THE ACCURACY OF THE INFORMATION PROVIDED HEREON. THE CONTRACTOR SHALL BE RESPONSIBLE FOR OBTAINING ALL NECESSARY PERMITS AND APPROVALS FROM THE APPROPRIATE AGENCIES AND AGENCIES PRIOR TO THE COMMENCEMENT OF ANY WORK UNDER THIS CONTRACT.
3. THE CONTRACTOR SHALL BE RESPONSIBLE FOR VERIFYING THE EXISTING CONDITIONS AND THE ACCURACY OF THE INFORMATION PROVIDED HEREON. THE CONTRACTOR SHALL BE RESPONSIBLE FOR OBTAINING ALL NECESSARY PERMITS AND APPROVALS FROM THE APPROPRIATE AGENCIES AND AGENCIES PRIOR TO THE COMMENCEMENT OF ANY WORK UNDER THIS CONTRACT.
4. THE CONTRACTOR SHALL BE RESPONSIBLE FOR VERIFYING THE EXISTING CONDITIONS AND THE ACCURACY OF THE INFORMATION PROVIDED HEREON. THE CONTRACTOR SHALL BE RESPONSIBLE FOR OBTAINING ALL NECESSARY PERMITS AND APPROVALS FROM THE APPROPRIATE AGENCIES AND AGENCIES PRIOR TO THE COMMENCEMENT OF ANY WORK UNDER THIS CONTRACT.
5. THE CONTRACTOR SHALL BE RESPONSIBLE FOR VERIFYING THE EXISTING CONDITIONS AND THE ACCURACY OF THE INFORMATION PROVIDED HEREON. THE CONTRACTOR SHALL BE RESPONSIBLE FOR OBTAINING ALL NECESSARY PERMITS AND APPROVALS FROM THE APPROPRIATE AGENCIES AND AGENCIES PRIOR TO THE COMMENCEMENT OF ANY WORK UNDER THIS CONTRACT.
6. THE CONTRACTOR SHALL BE RESPONSIBLE FOR VERIFYING THE EXISTING CONDITIONS AND THE ACCURACY OF THE INFORMATION PROVIDED HEREON. THE CONTRACTOR SHALL BE RESPONSIBLE FOR OBTAINING ALL NECESSARY PERMITS AND APPROVALS FROM THE APPROPRIATE AGENCIES AND AGENCIES PRIOR TO THE COMMENCEMENT OF ANY WORK UNDER THIS CONTRACT.
7. THE CONTRACTOR SHALL BE RESPONSIBLE FOR VERIFYING THE EXISTING CONDITIONS AND THE ACCURACY OF THE INFORMATION PROVIDED HEREON. THE CONTRACTOR SHALL BE RESPONSIBLE FOR OBTAINING ALL NECESSARY PERMITS AND APPROVALS FROM THE APPROPRIATE AGENCIES AND AGENCIES PRIOR TO THE COMMENCEMENT OF ANY WORK UNDER THIS CONTRACT.
8. THE CONTRACTOR SHALL BE RESPONSIBLE FOR VERIFYING THE EXISTING CONDITIONS AND THE ACCURACY OF THE INFORMATION PROVIDED HEREON. THE CONTRACTOR SHALL BE RESPONSIBLE FOR OBTAINING ALL NECESSARY PERMITS AND APPROVALS FROM THE APPROPRIATE AGENCIES AND AGENCIES PRIOR TO THE COMMENCEMENT OF ANY WORK UNDER THIS CONTRACT.
9. THE CONTRACTOR SHALL BE RESPONSIBLE FOR VERIFYING THE EXISTING CONDITIONS AND THE ACCURACY OF THE INFORMATION PROVIDED HEREON. THE CONTRACTOR SHALL BE RESPONSIBLE FOR OBTAINING ALL NECESSARY PERMITS AND APPROVALS FROM THE APPROPRIATE AGENCIES AND AGENCIES PRIOR TO THE COMMENCEMENT OF ANY WORK UNDER THIS CONTRACT.
10. THE CONTRACTOR SHALL BE RESPONSIBLE FOR VERIFYING THE EXISTING CONDITIONS AND THE ACCURACY OF THE INFORMATION PROVIDED HEREON. THE CONTRACTOR SHALL BE RESPONSIBLE FOR OBTAINING ALL NECESSARY PERMITS AND APPROVALS FROM THE APPROPRIATE AGENCIES AND AGENCIES PRIOR TO THE COMMENCEMENT OF ANY WORK UNDER THIS CONTRACT.

- KEY:
- Existing Asphalt Highway 10' Right-of-Way
 - Existing Unimproved Highway 10' Right-of-Way
 - Existing Asphalt Highway 10' Right-of-Way
 - Proposed Asphalt Highway 10' Right-of-Way
 - Proposed Unimproved Highway 10' Right-of-Way
 - Development Area
 - Phase 2 - 200' Boundary
 - Phase 2 - 500' Boundary

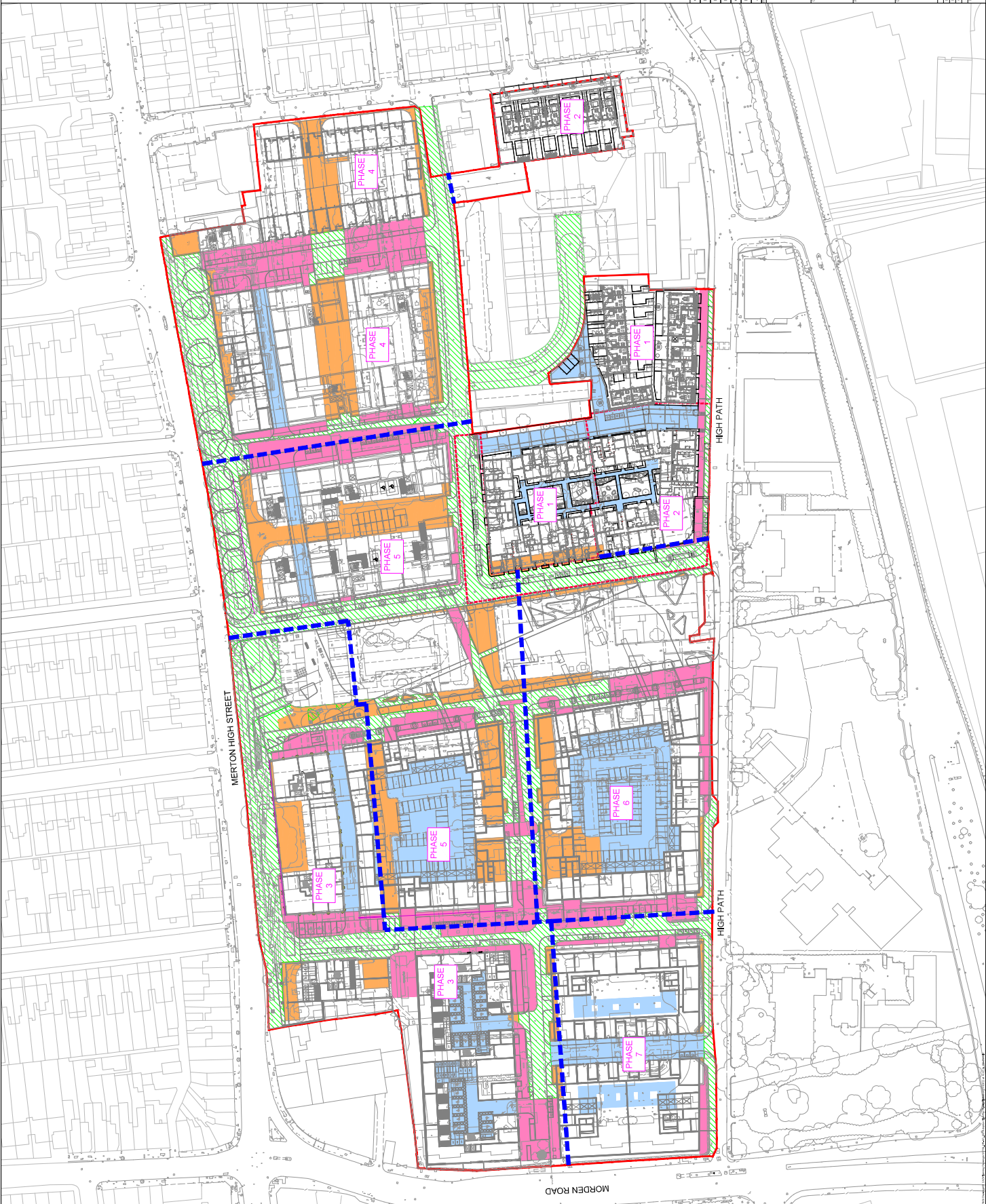

Item	Description	Scale	Sheet No.	Total Sheets
1	Phase 1 - 200' Boundary	1/8" = 1'-0"	1 of 7	7
2	Phase 1 - 500' Boundary	1/8" = 1'-0"	1 of 7	7
3	Phase 2 - 200' Boundary	1/8" = 1'-0"	2 of 7	7
4	Phase 2 - 500' Boundary	1/8" = 1'-0"	2 of 7	7
5	Phase 3 - 200' Boundary	1/8" = 1'-0"	3 of 7	7
6	Phase 3 - 500' Boundary	1/8" = 1'-0"	3 of 7	7
7	Phase 4 - 200' Boundary	1/8" = 1'-0"	4 of 7	7
8	Phase 4 - 500' Boundary	1/8" = 1'-0"	4 of 7	7
9	Phase 5 - 200' Boundary	1/8" = 1'-0"	5 of 7	7
10	Phase 5 - 500' Boundary	1/8" = 1'-0"	5 of 7	7
11	Phase 6 - 200' Boundary	1/8" = 1'-0"	6 of 7	7
12	Phase 6 - 500' Boundary	1/8" = 1'-0"	6 of 7	7
13	Phase 7 - 200' Boundary	1/8" = 1'-0"	7 of 7	7
14	Phase 7 - 500' Boundary	1/8" = 1'-0"	7 of 7	7

Pell Frischmann

Merlon High Path Development

Clerton Housing Group

Merlon High Path Development

Proposed Adoption Plan

Item	Description	Scale	Sheet No.	Total Sheets
1	Phase 1 - 200' Boundary	1/8" = 1'-0"	1 of 7	7
2	Phase 1 - 500' Boundary	1/8" = 1'-0"	1 of 7	7
3	Phase 2 - 200' Boundary	1/8" = 1'-0"	2 of 7	7
4	Phase 2 - 500' Boundary	1/8" = 1'-0"	2 of 7	7
5	Phase 3 - 200' Boundary	1/8" = 1'-0"	3 of 7	7
6	Phase 3 - 500' Boundary	1/8" = 1'-0"	3 of 7	7
7	Phase 4 - 200' Boundary	1/8" = 1'-0"	4 of 7	7
8	Phase 4 - 500' Boundary	1/8" = 1'-0"	4 of 7	7
9	Phase 5 - 200' Boundary	1/8" = 1'-0"	5 of 7	7
10	Phase 5 - 500' Boundary	1/8" = 1'-0"	5 of 7	7
11	Phase 6 - 200' Boundary	1/8" = 1'-0"	6 of 7	7
12	Phase 6 - 500' Boundary	1/8" = 1'-0"	6 of 7	7
13	Phase 7 - 200' Boundary	1/8" = 1'-0"	7 of 7	7
14	Phase 7 - 500' Boundary	1/8" = 1'-0"	7 of 7	7