

VNS. Objections must relate only to the elements of the scheme that are subject to this statutory consultation.

A copy of the proposed Traffic Management Orders (TMOs), a plan identifying the areas affected by the proposals and the Council's Statement of Reasons can be inspected at Merton Link, Merton Civic Centre, London Road, Morden, Surrey, SM4 5DX and Wimbledon Library during the Council's normal office hours Monday to Friday, 9am to 5pm. This information is also available on Merton Council's website [www.merton.gov.uk/cpzvns](http://www.merton.gov.uk/cpzvns)

All representations along with Officers' comments and recommendations will be presented in a report to the Cabinet Member for Regeneration, Environment and Housing. Please note that responses to any representations received will not be made until a final decision is made by the Cabinet Member.

The Council is required to give weight to the nature and content of your representations and not necessarily the quantity. Your reasons are, therefore, important to us.

Further information on how CPZs work, details of permit costs can be found in our Frequently Asked Questions (FAQ's) at [www.merton.gov.uk/cpzvns](http://www.merton.gov.uk/cpzvns)

#### VILLAGE WARD COUNCILLORS

**Cllr Hamish Badenoch**  
Phone - 020 8545 3396  
Email: [hamish.badenoch@merton.gov.uk](mailto:hamish.badenoch@merton.gov.uk)

**Cllr John Bowcott**  
Phone - 020 8946 1011  
Email: [John.bowcott@merton.gov.uk](mailto:John.bowcott@merton.gov.uk)

**Cllr Najeeb Latif**  
Phone - 020 8545 3396  
Email: [najeeb.latif@merton.gov.uk](mailto:najeeb.latif@merton.gov.uk)

**Cllr Martin Whelton**  
Tel: 020 8545 3425  
Cabinet Member for Environment,  
Regeneration and Housing.  
Email: [martin.whelton@merton.gov.uk](mailto:martin.whelton@merton.gov.uk)

(The contact details of Ward Councillors are provided for information purposes only)

## Controlled Parking Zone (CPZ)

Proposed Zone VNS - Newstead Way and Somerset Road.



ISSUE DATE : 30 NOVEMBER 2017

### Dear Resident/Business

The purpose of this leaflet is to let you know the outcome of the informal consultation carried out in September 2017 on the proposal to introduce a controlled parking zone (CPZ) in your road.

### VSW1 CPZ CONSULTATION RESULTS

The consultation resulted in a total of 36 questionnaires returned (after removing duplicates / multiple returns from some households and Somerset Road between Burghley and No 156 Somerset Road, private section), representing a response rate of 55%. Of the 36 who responded, 86% support a CPZ in their road, compared to 8% who do not and 6% who are unsure

Further analysis of the results on a road-by-road basis revealed that majority of the roads are in favour of the proposed controls except the private section of Somerset Road. The results show that residents of Somerset Road between Burghley and No 156 Somerset Road, (private section) do not support the principle of a CPZ in their road even if the neighbouring roads have one as they maintain the road. For the section of this road to be considered for a CPZ in the future all residents must agree to the proposal and sign an undertaking confirming their agreement. For further details please refer to the report online for consultation results. [www.merton.gov.uk/cpzvns](http://www.merton.gov.uk/cpzvns)

The results of the consultation along with officers' recommendation were presented in a report to the Cabinet Member for Environment, Regeneration and Housing on 23 October 2017. The report and the decision sheet can be viewed on our website. [www.merton.gov.uk/cpzvns](http://www.merton.gov.uk/cpzvns) The following recommendations which were made to the Cabinet

Member have now been agreed:

- Notes the results of the informal consultation carried out between 7 and 29 September 2017 on the proposals to introduce a Controlled Parking Zone (CPZ) VNS to include Newstead Way and Somerset Road between Burghley Road and Church Road.
- To proceed with a statutory consultation to introduce VNS to include Newstead Way and Somerset Road, between Newstead Way (its eastern arm junction) and Church Road, operational Monday to Friday between 10am and 4pm.
- To proceed with the statutory consultation of the relevant Traffic Management Orders (TMOs) and the implementation of the 'At any time' waiting restrictions within the proposed zone.
- To proceed with statutory consultation to introduce electric charging points in Somerset Road close to its junction with Newstead Way (eastern arm). Which now be relocated close to AELTC Car Park 4. See plan overleaf.
- To abandon the proposed VSN CPZ in Somerset Road between Burghley Road and Newstead Way (its eastern arm junction).

### WHAT HAPPENS NEXT

A Notice of the Council's intention to introduce the above measures will be published in a local newspaper (The Guardian), London Gazette and posted on lamp columns in the vicinity. Representations against the proposals described in this Notice must be made in writing or email to [trafficandhighways@merton.gov.uk](mailto:trafficandhighways@merton.gov.uk) by no later than 5 January 2018 quoting reference ES/

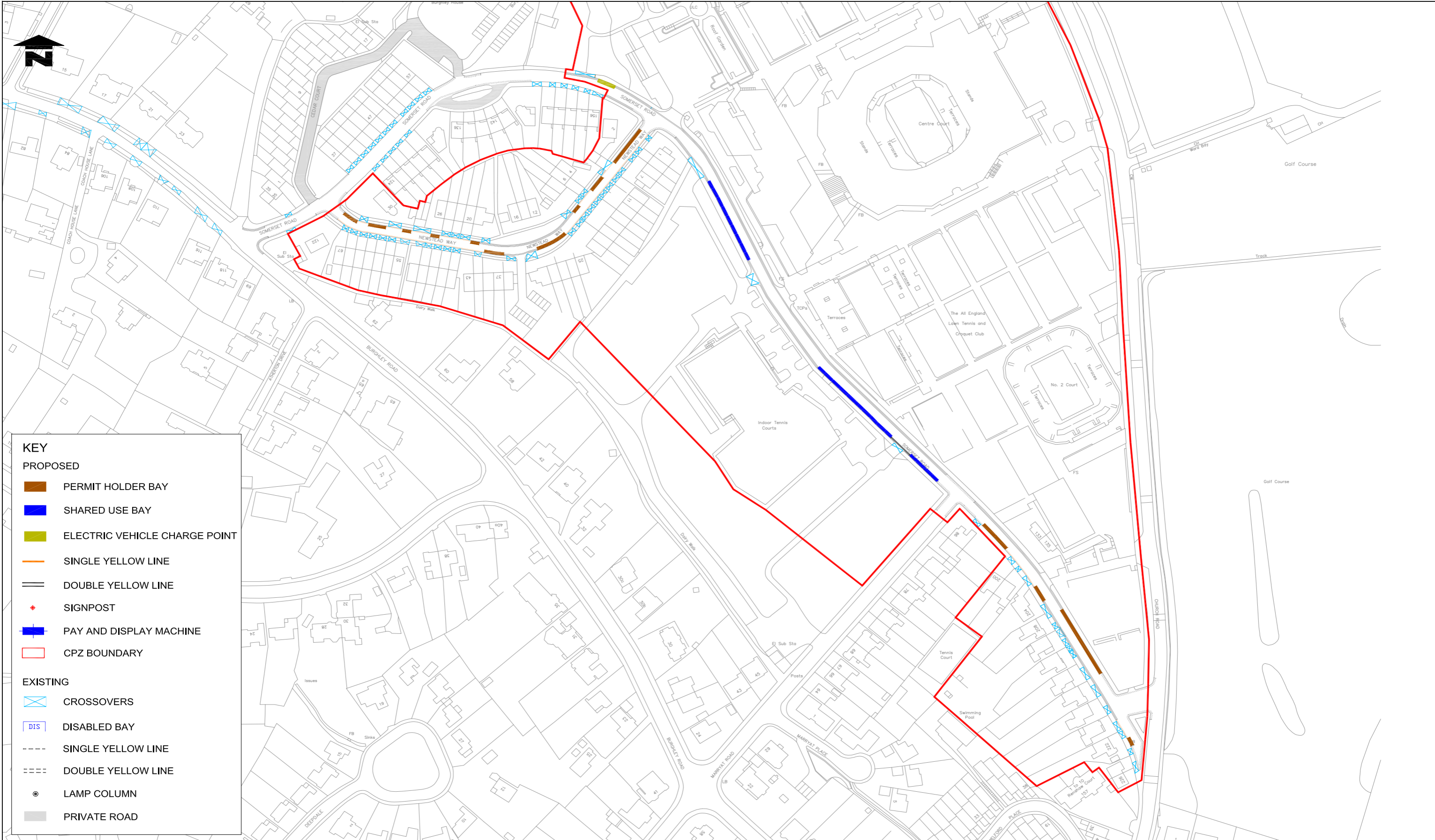

KEY	
<b>PROPOSED</b>	
	PERMIT HOLDER BAY
	SHARED USE BAY
	ELECTRIC VEHICLE CHARGE POINT
	SINGLE YELLOW LINE
	DOUBLE YELLOW LINE
	SIGNPOST
	PAY AND DISPLAY MACHINE
	CPZ BOUNDARY
<b>EXISTING</b>	
	CROSSOVERS
	DISABLED BAY
	SINGLE YELLOW LINE
	DOUBLE YELLOW LINE
	LAMP COLUMN
	PRIVATE ROAD

Notes  
Do not scale from this drawing

Rev.	Revisions	Drawn	Sig.	Date	Chkd.	Sig.	Date	App.	Sig.	Date

**Sustainable Communities**  
environment & regeneration

TRAFFIC & HIGHWAYS

Reproduced From/based upon the Ordnance Survey 1:250 maps with the permission of the Controller of HMSO. Crown Copyright Reserved. Unauthorized reproduction infringes Crown copyright and may lead to prosecution or civil proceedings. London Borough of Merton 100019259

Drawn by SC	Sig.	Date Aug 2017
Checked by	Sig.	Date
Approved by	Sig.	Date

PROJECT  
**CONTROLLED PARKING ZONES**

TITLE  
**VNS PROPOSED LAYOUT**

Merton Civic Centre  
London Road  
Morden, Surrey  
SM4 5DX  
www.merton.gov.uk

Drawing No. <b>Z78-348-01</b>
Revision <b>A</b>
Classification <b>CONSULTATION</b>
Scale <b>1:1000</b>