

- | | | | | | | | |
|--|--|--|---------------------------------|--|-----------------------------|--|-----------------------------|
| | CROSSOVERS | | EXISTING PAY & DISPLAY ONLY BAY | | POST | | BOLLARD |
| | UNAUTHORISED CROSSOVER (DROPPED KERB REQUIRED) | | PROPOSED PAY & DISPLAY ONLY BAY | | TGP TELEGRAPH POLE | | P&D TICKET MACHINE |
| | EXISTING PERMIT HOLDER BAY | | PROPOSED CARCLUB BAY | | EXISTING CPZ BOUNDARY | | PROPOSED CPZ EXTENSION |
| | PROPOSED PERMIT HOLDER BAY | | MOTORCYCLE BAY ONLY | | EXISTING SINGLE YELLOW LINE | | PROPOSED SINGLE YELLOW LINE |
| | EXISTING PAY & DISPLAY SHARED BAY | | DISABLED BAY | | EXISTING DOUBLE YELLOW LINE | | PROPOSED DOUBLE YELLOW LINE |
| | PROPOSED PAY & DISPLAY SHARED BAY | | LAMP COLUMN | | | | |

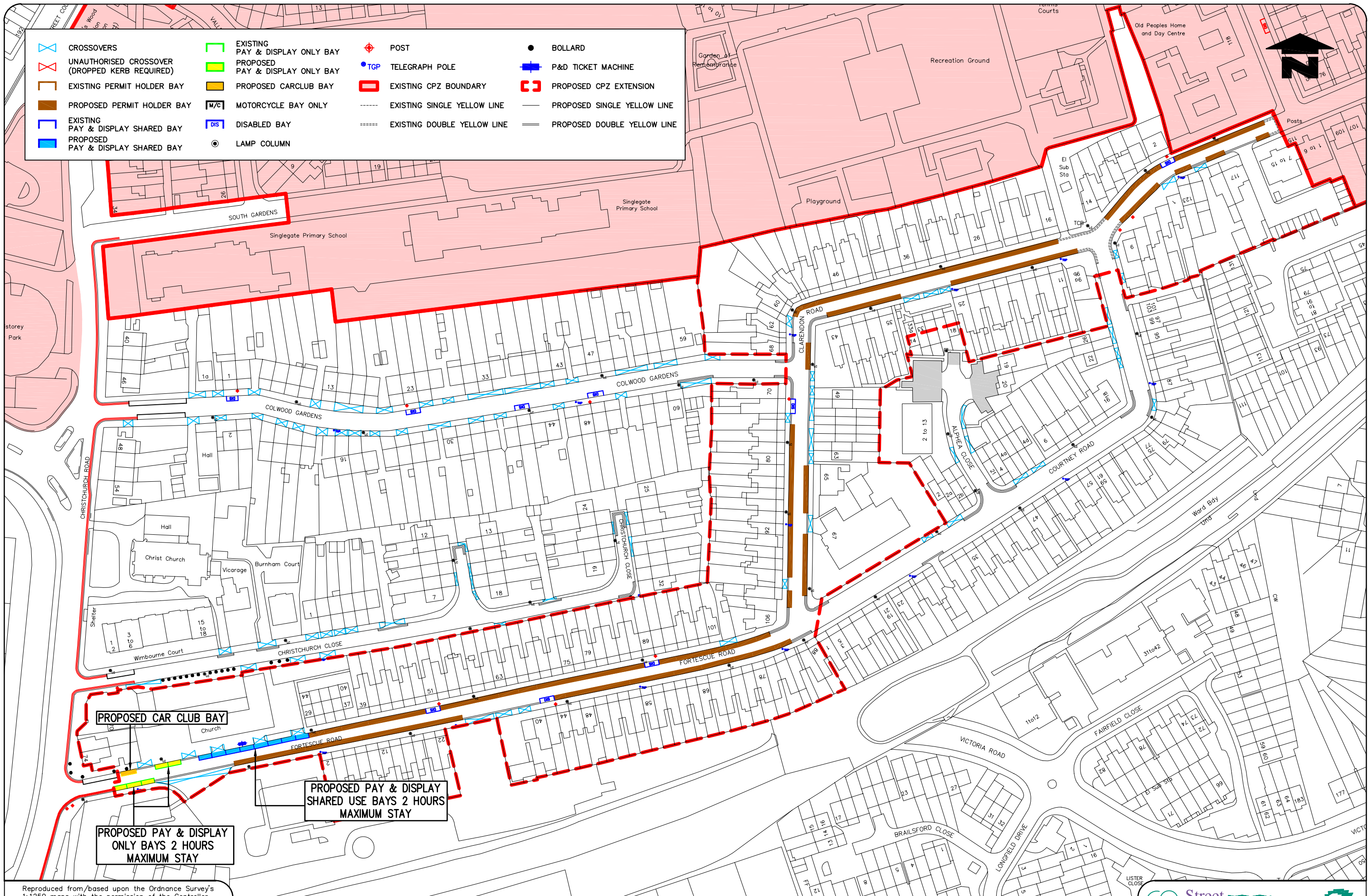

Reproduced from/based upon the Ordnance Survey's 1:1250 maps with the permission of the Controller of H.M.S.O., Crown Copyright Reserved. Unauthorised reproduction infringes Crown copyright © and may lead to prosecution or civil proceedings. London Borough of Merton 100019259 2011

PROPOSED EXTENSION OF CONTROLLED PARKING ZONE CW