

EXISTING		PROPOSED	
	CROSSOVERS		PERMIT HOLDER BAY
	UNAUTHORISED CROSSOVER (DROPPED KERB REQUIRED)		PAY & DISPLAY SHARED BAY
	CROSSOVER NOT IN USE		CPZ EXTENSION
	PERMIT HOLDER BAY		P&D TICKET MACHINE
	PAY & DISPLAY SHARED BAY		POST
	PAY & DISPLAY ONLY BAY		TGP TELEGRAPH POLE
	DISABLED BAY		CPZ BOUNDARY
	P&D TICKET MACHINE		SINGLE YELLOW LINE
	LAMP COLUMN		DOUBLE YELLOW LINE
			SINGLE YELLOW LINE
			DOUBLE YELLOW LINE
			LOADING RESTRICTION

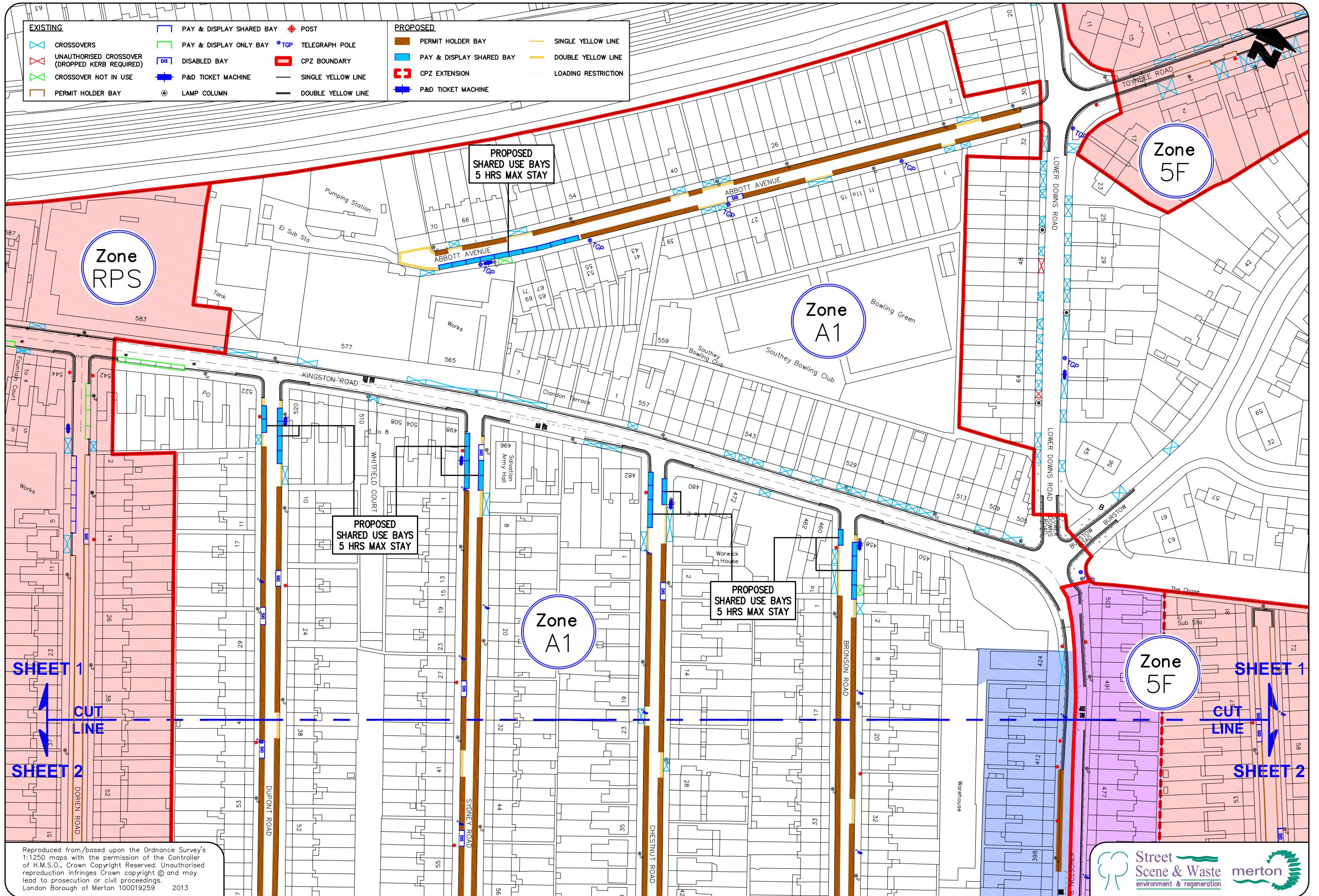

Reproduced from/based upon the Ordnance Survey's 1:1250 maps with the permission of the Controller of H.M.S.O., Crown Copyright Reserved. Unauthorised reproduction infringes Crown copyright © and may lead to prosecution or civil proceedings. London Borough of Merton 100019259 2013

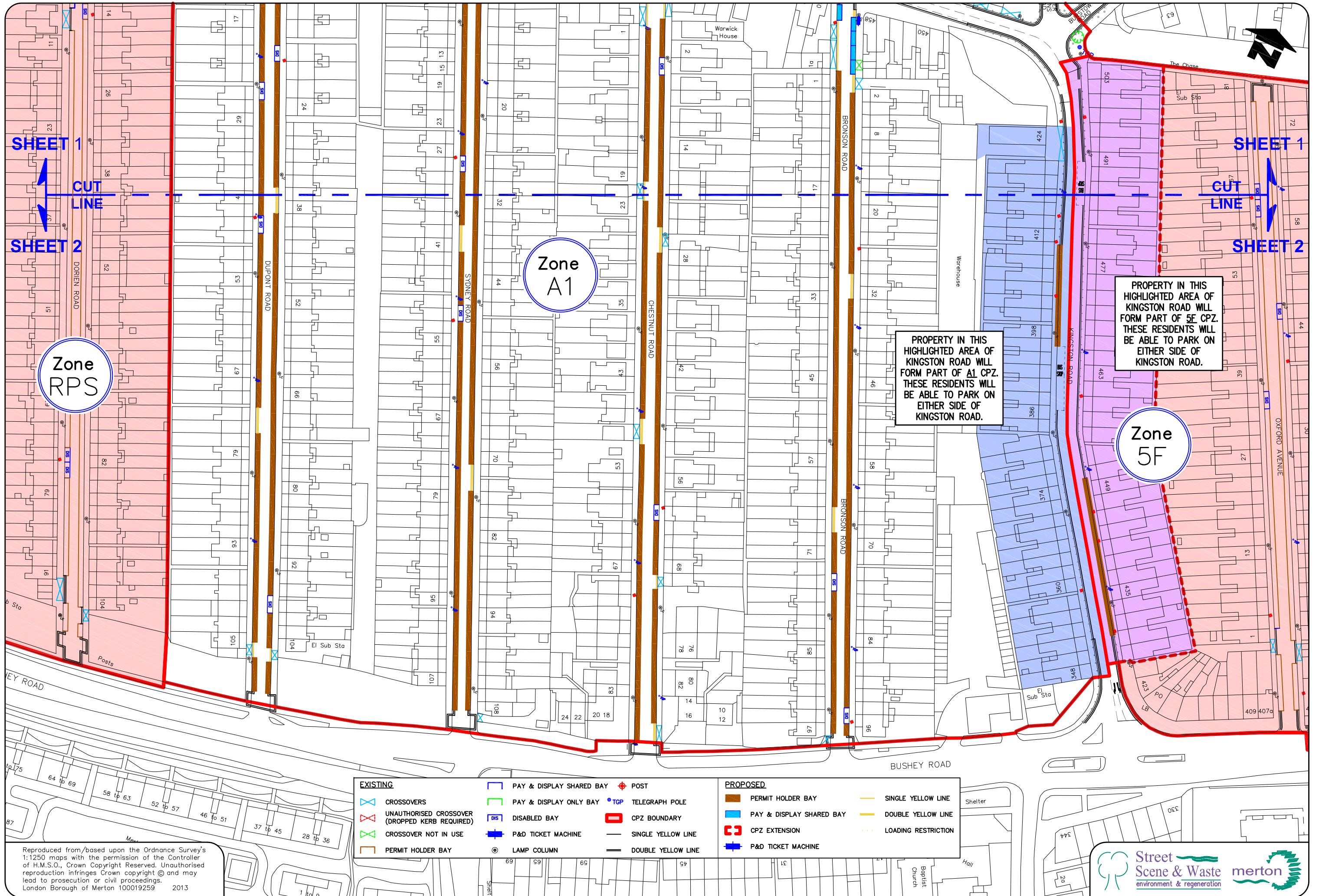



SHEET 1

SHEET 2

SHEET 1

SHEET 2

Zone A1

Zone RPS

Zone 5F

PROPERTY IN THIS HIGHLIGHTED AREA OF KINGSTON ROAD WILL FORM PART OF A1 CPZ. THESE RESIDENTS WILL BE ABLE TO PARK ON EITHER SIDE OF KINGSTON ROAD.

PROPERTY IN THIS HIGHLIGHTED AREA OF KINGSTON ROAD WILL FORM PART OF 5F CPZ. THESE RESIDENTS WILL BE ABLE TO PARK ON EITHER SIDE OF KINGSTON ROAD.

EXISTING		PROPOSED	
	CROSSOVERS		PERMIT HOLDER BAY
	UNAUTHORISED CROSSOVER (DROPPED KERB REQUIRED)		PAY & DISPLAY SHARED BAY
	CROSSOVER NOT IN USE		CPZ EXTENSION
	PERMIT HOLDER BAY		P&D TICKET MACHINE
	PAY & DISPLAY SHARED BAY		POST
	PAY & DISPLAY ONLY BAY		TGP TELEGRAPH POLE
	DISABLED BAY		CPZ BOUNDARY
	P&D TICKET MACHINE		SINGLE YELLOW LINE
	LAMP COLUMN		DOUBLE YELLOW LINE
			LOADING RESTRICTION

Reproduced from/based upon the Ordnance Survey's 1:1250 maps with the permission of the Controller of H.M.S.O., Crown Copyright Reserved. Unauthorised reproduction infringes Crown copyright © and may lead to prosecution or civil proceedings. London Borough of Merton 100019259 2013

