

WIMBLEDON
PARK LAKE

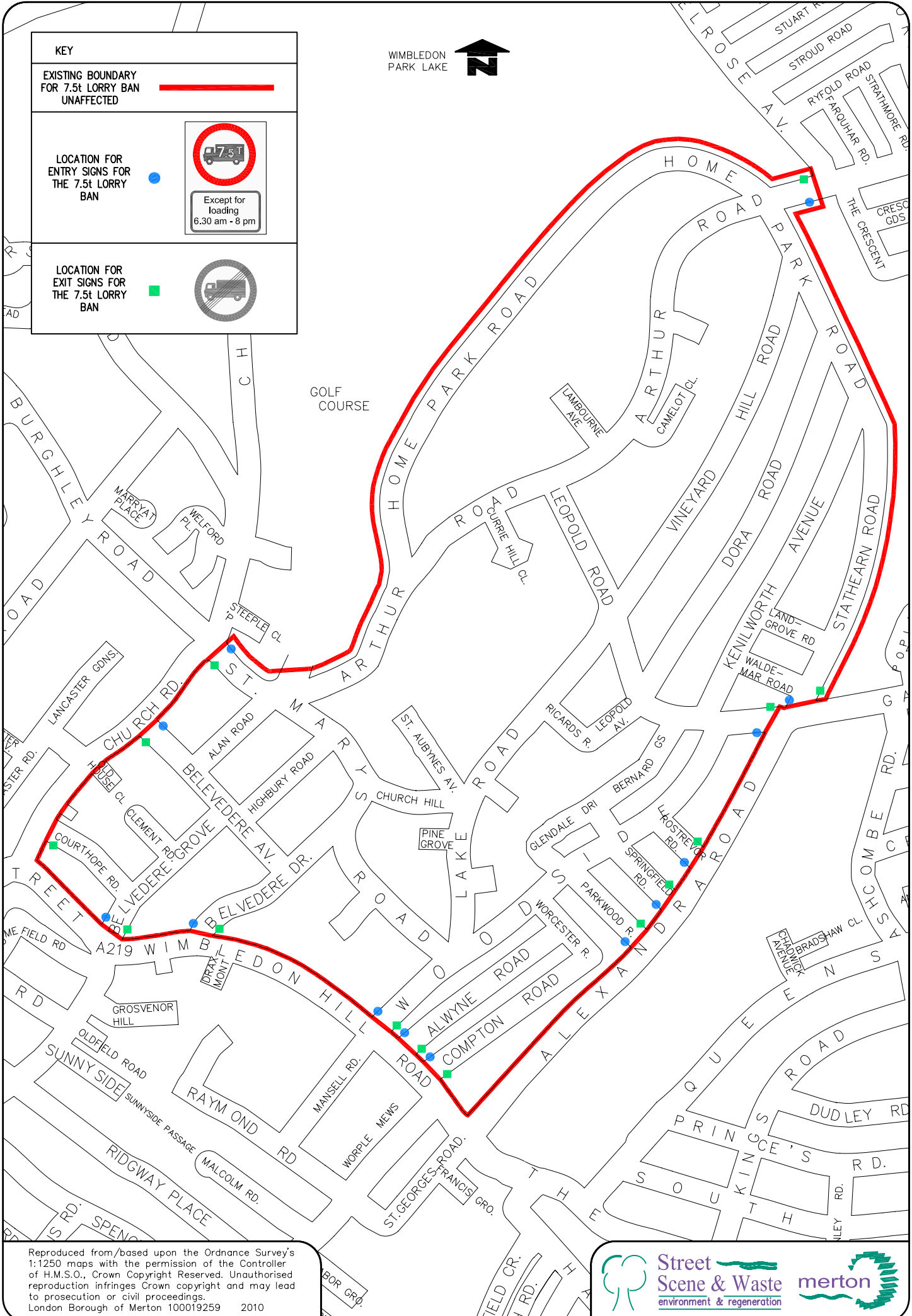

KEY	
EXISTING BOUNDARY FOR 7.5t LORRY BAN UNAFFECTED	
LOCATION FOR ENTRY SIGNS FOR THE 7.5t LORRY BAN	 Except for loading 6.30 am - 8 pm
LOCATION FOR EXIT SIGNS FOR THE 7.5t LORRY BAN	



Reproduced from/based upon the Ordnance Survey's 1:1250 maps with the permission of the Controller of H.M.S.O., Crown Copyright Reserved. Unauthorised reproduction infringes Crown copyright and may lead to prosecution or civil proceedings.
 London Borough of Merton 100019259 2010

Street Scene & Waste
 environment & regeneration

merton